



HF-Performer III for TL5 lamps

HF-P 1 24/39 TL5 III 220-240V 50/60Hz

HF-Performer III TL5 is a sustainable, slim and high-frequency electronic ballast for TL5 and TL5 Eco fluorescent lamps. It is ideal for applications where high energy efficiency is required. The HF-Performer III range has a robust design, meets all relevant international safety and performance standards and is energy-efficient (CELMA EEI A2 BAT).

Product data

Operating and Electrical		T-Case Maximum (Max) 80 °C	
Input Voltage	220 to 240 V		
Line Frequency	50 to 60 Hz	Mechanical and Housing	
Input Frequency	50 to 60 Hz	Housing L 360x30x21	
Inrush Current Width	0.25 ms		
Inrush Current Peak (Max)	18 A	Approval and Application	
Number of Products on MCB (16A Type B) (Nom)	28	Ingress protection code IP20 [Finger-protected]	
		Energy Efficiency Index A2 BAT	
		Safety Standard IEC 61347-2-3	
		Environmental Standard ISO 14001	
		Approval Marks CE marking ENEC certificate VDE-EMV certificate	
Wiring		Product Data	
Connector Type Input Terminals	WAGO 251 universal connector [Suitable for both automatic wiring (ALF and ADS) and manual wiring]	Order product name HF-P 1 24/39 TL5 III 220-240V 50/60Hz	
Connector Type Output Terminals	WAGO 251 universal connector [Suitable for both automatic wiring (ALF and ADS) and manual wiring]	Full product name HF-P 1 24/39 TL5 III 220-240V 50/60Hz	
		Full product code 872790095224700	
		Order code 913713034066	
		Material Nr. (12NC) 913713034066	
		Numerator - Quantity Per Pack 1	
Temperature			
Ambient temperature range	-25 °C to 60 °C		
T-Case Lifetime (Nom)	80 °C		

HF-Performer III for TL5 lamps

EAN/UPC - Product/Case	8727900952247
Numerator - Packs per outer box	12
EAN/UPC - Case	8727900952254

Dimensional drawing

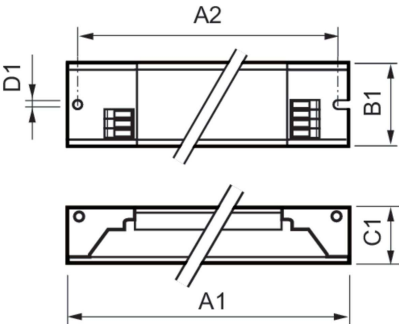

Product	D1	C1	A1	A2	B1
HF-P 1 24/39 TL5 III 220-240V 50/60Hz	4.2 mm	21.0 mm	360.0 mm	350.0 mm	30.0 mm

