



HF-Selectalume II for TL5 lamps

HF-S 124-39 TL5 II 220-240V 50/60Hz

HF-Selectalume II is the most cost-effective, reliable, slim and affordable fluorescent solution, with highly disruptive technology for energy saving, system flexibility and unsurpassed performance. The cost-saving HF-Selectalume II has a robust design which meets all relevant international safety and performance standards. HF-Selectalume II is intended for use with indoor lighting fixtures such as spotlights, downlights and recessed luminaires, which are largely used in office, retail, industry, hotel, restaurant and other applications where control devices are installed with occasional On/Off switching activity

Product data

Operating and Electrical		Mechanical and Housing	
Input Voltage	220 to 240 V	Housing	L 280x30x21.5
Line Frequency	50 to 60 Hz		
Input Frequency	50 to 60 Hz	Approval and Application	
Earth Leakage Current (Max)	0.5 mA	Ingress protection code	IP20 [Finger-protected]
Inrush Current Width	0.28 ms	Energy Efficiency Index	A2/A2 BAT
Inrush Current Peak (Max)	20 A	Approval Marks	F-Marking CE marking ENEC certificate CCC certificate C-Tick certificate PSB certification TISI marking SIRIM approval CB Certificate CCC certificate VDE-EMV certificate
Wiring			
Connector Type Input Terminals	WAGO 744 connector	Product Data	
Connector Type Output Terminals	WAGO 744 connector [Suitable for manual wiring]	Order product name	HF-S 124-39 TL5 II 220-240V 50/60Hz
Temperature		Full product name	HF-S 124-39 TL5 II 220-240V 50/60Hz
Ambient temperature range	-15 °C to 50 °C	Full product code	872790093933000
T-Case Lifetime (Nom)	75 °C	Order code	913713034466
T-Case Maximum (Max)	75 °C	Material Nr. (12NC)	913713034466

HF-Selectalume II for TL5 lamps

Numerator - Quantity Per Pack	1
EAN/UPC - Product/Case	8727900939330
Numerator - Packs per outer box	12

EAN/UPC - Case	8727900939347
----------------	---------------

Dimensional drawing

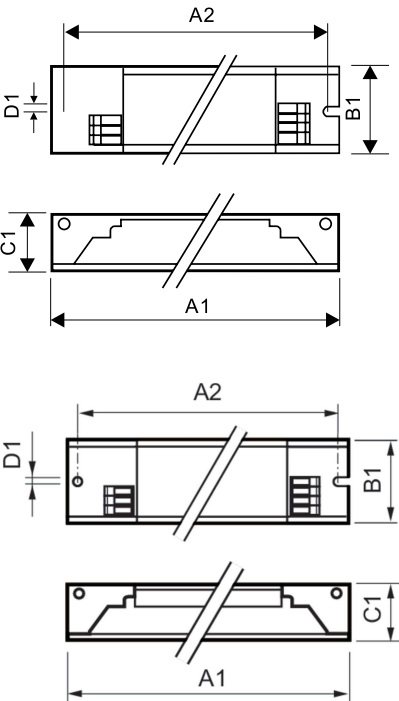

Product
HF-S 124-39 TL5 II 220-240V 50/60Hz

Product	A1	B1	C1	A2	B2	D1
HF-S 124-39 TL5 II 220-240V 50/60Hz	280 mm	30 mm	21.5 mm	265 mm		4.2 mm

