



HF-Essential II for TL5/TL-D

HF-E 1/2 28-35 TL5 II 220-240 50/60Hz

Essentially smart and reliable. HF-Essential II is the most cost-effective solution for reliably operation of a fluorescent lamp. It is also the ideal entry-level product for electromagnetic system users who want to take advantage of the benefits provided by electronic ballasts. The cost-saving and reliable HF-Essential II is energy efficiency class A2, and its robust design meets all relevant international safety and performance standards. HF- Essential II is the ideal choice for a broad range of new construction and retrofit applications within the commercial sector, including general surface mounting and office lighting, parking garages, warehouses and other applications.

Product data

Operating and Electrical	
Input Voltage	220 to 240 V
Line Frequency	50 to 60 Hz
Input Frequency	50 to 60 Hz
Power Consumption	75 W
Earth Leakage Current (Max)	0.5 mA
Inrush Current Width	0.23 ms
Power Factor (Fraction)	0.97
Input Current (Max)	0.41 A
Input Current (Min)	0.127 A
Inrush Current Peak (Max)	21 A
Number of Products on MCB (16A Type B) (Nom)	25
Wiring	
Connector Type Input Terminals	WAGO 744 connector

Connector Type Output Terminals	Wago 744
Temperature	
Ambient temperature range	0 °C to 50 °C
T-Case Lifetime (Nom)	75 °C
T-Case Maximum (Max)	75 °C
Mechanical and Housing	
Housing	L 211x40x28.7
Approval and Application	
Ingress protection code	IP20 [Finger-protected]
Energy Efficiency Index	A2
Safety Standard	IEC 61347-2-3

HF-Essential II for TL5/TL-D

Approval Marks	CE marking KEMA Keur certificate CB
	Certificate RoHS Compliant
Product Data	
Order product name	HF-E 1/2 28-35 TL5 II 220-240 50/60Hz
Full product name	HF-E 1/2 28-35 TL5 II 220-240 50/60Hz
Full product code	87186965676800
Order code	56767800

Material Nr. (12NC)	913713042866
Numerator - Quantity Per Pack	1
EAN/UPC - Product/Case	8718696567678
Numerator - Packs per outer box	20
EAN/UPC - Case	8718696567685

Dimensional drawing

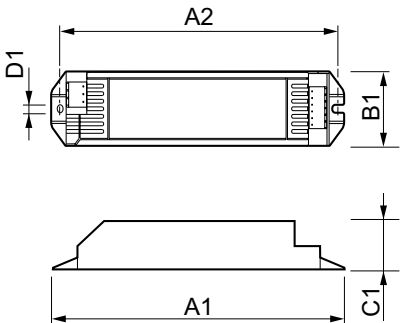

Product	A1	B1	C1	D1	A2
HF-E 1/2 28-35 TL5 II 220-240 50/60Hz	211 mm	40 mm	28.7 mm	4.2 mm	198 mm

