



MASTER LEDspot LV AR111

MAS LEDspotLV D 15-75W 930 AR111 40D

Delivering a warm, halogen-like accent beam, MASTER LEDspot LV AR111 is an ideal retrofit solution for spot and general lighting applications in the hospitality and retail industry. It is particularly suitable for general lighting where the light is on all the time, such as creative accent lighting applications in shops, restaurants, hotels, and especially for galleries, exhibitions and museums. The robustly designed MASTER LEDspot LV AR111 offers various beam angles for a clearly defined beam spread. There is no UV or IR in the beam, making it suitable for illuminating heat-sensitive objects (food, organic materials, paintings, etc.). The patented intelligent driver enables broad compatibility with existing electromagnetic and electronic halogen transformers. MASTER LEDspot LV AR111 delivers huge energy savings and minimises maintenance cost without any reduction in brightness.

Product data

General Information			
Cap base	G53 [G53]	Luminous efficacy (rated) (nom.)	54.00 lm/W
Nominal lifetime	40,000 h	Colour consistency	<3
Switching Cycle	50,000	Colour rendering index (CRI)	90
Lighting Technology	LED	LLMF at end of nominal lifetime (nom.)	70 %
EU RoHS compliant	Yes	Luminous flux in 90° cone (rated)	810 lm
Light Technical		Operating and Electrical	
Colour Code	930 [CCT of 3000K]	Line Frequency	- Hz
Beam angle (nom.)	40 degree(s)	Input frequency	- Hz
Luminous Flux	810 lm	Power Consumption	15 W
Luminous intensity (nom.)	1,450 cd	Lamp current (nom.)	1,800 mA
Colour designation	White (WH)	Wattage equivalent	75 W
Correlated Colour Temperature	3000 K	Starting time (nom.)	0.5 s
		Warm-up time to 60% light	0.5 s

MASTER LEDspot LV AR111

Power Factor (Fraction)	0.7
Voltage (nom.)	12 V
Temperature	
T-Case maximum (nom.)	74 °C
Controls and Dimming	
Dimmable	Yes
Mechanical and Housing	
Bulb shape	AR111
Approval and Application	
Suitable for accent lighting	Yes
Energy consumption kWh/1,000 hours	17 kWh

EyeComfort	Yes
Product Data	
Order product name	MAS LEDspotLV D 15-75W 930 AR111 40D
Full product name	MAS LEDspotLV D 15-75W 930 AR111 40D
Full EOC	871869651502000
Order code	51502000
Material no. (12 NC)	929001170502
Local order code	MLED15AR113040N
SAP numerator – quantity per pack	1
EAN/UPC – Product/Case	8718696515020
Numerator – packs per outer box	6
EAN/UPC – Case	8718696515037

Dimensional drawing

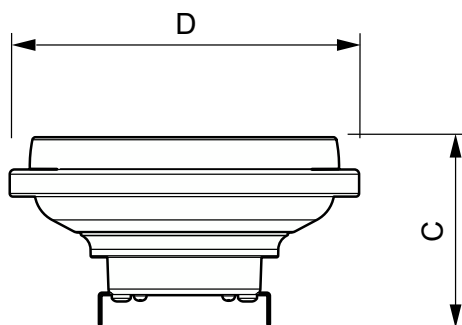
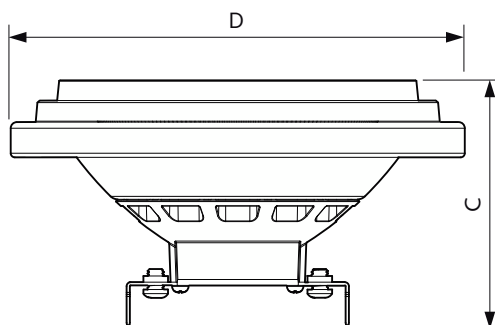

Product	D	C
MAS LEDspotLV D 15-75W 930 AR111 40D	111 mm	62 mm

Product
MAS LEDspotLV D 15-75W 930 AR111 40D

MASTER LEDspot LV AR111

Photometric data

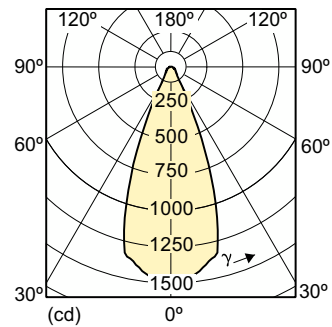
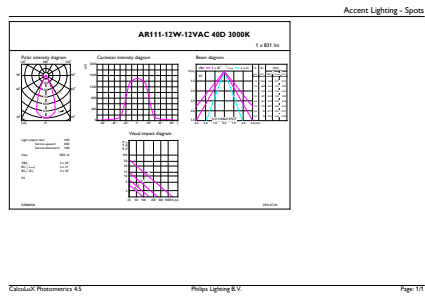

Accent Lighting Spots - MAS LEDspotLV D 15-75W 930 AR111 40D

Light Distribution Diagram - MAS LEDspotLV D 15-75W 930 AR111 40D



Spectral Power Distribution Colour - MAS LEDspotLV D 15-75W 930 AR111 40D

Lifetime

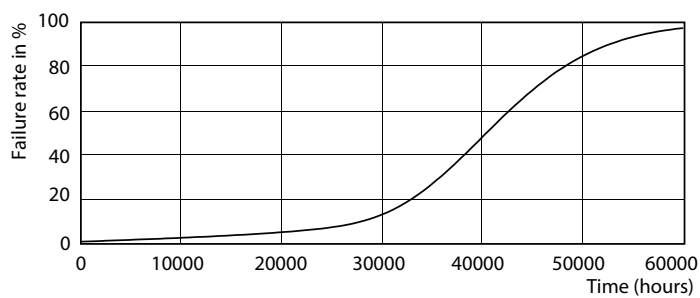

Life Expectancy Diagram - MAS LEDspotLV D 15-75W 930 AR111 40D

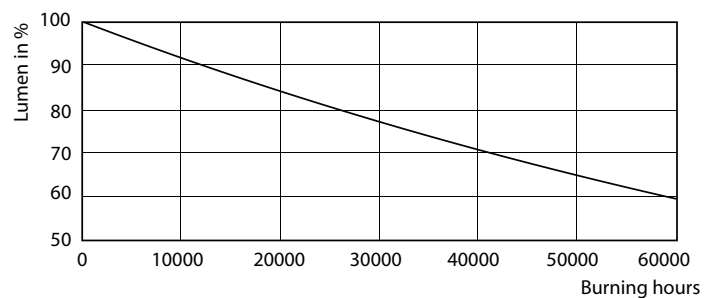

Lumen Maintenance Diagram - MAS LEDspotLV D 15-75W 930 AR111 40D

MASTER LEDspot LV AR111

