



Tornado T2

TornadoT2 8y 20W CDL E27 220-240V 1CT/12

Tornado has outstanding brightness which makes your colors appear more Vivid. It fits everywhere due to its compact design. With comprehensive product range, it allows easy replacement of incandescent lamps all the way.

Product data

General Information	
Cap base	E27 [E27]
Nominal lifetime (nom.)	8000 h
Switching cycle	5000X
Light Technical	
Colour code	865 [CCT of 6,500 K]
Luminous flux (nom.)	1200 lm
Luminous flux (rated) (nom.)	1200 lm
Colour designation	Cool Daylight
Lumen maintenance 2,000 hours (nom.)	85 %
Lumen maintenance 5,000 hours (nom.)	75 %
Chromaticity coordinate X (nom.)	313
Chromaticity coordinate Y (nom.)	337
Correlated Colour Temperature (Nom)	6500 K
Luminous efficacy (rated) (nom.)	61 lm/W
Color rendering index (nom.)	80
LLMF at end of nominal lifetime (nom.)	70 %
Operating and Electrical	
Input frequency	50 or 60 Hz
Power (Rated) (Nom)	20 W
Lamp current (nom.)	150 mA
Starting time (nom.)	0.3 s

Warm-up time to 60% light (min.)	5 s
Warm-up time to 60% light (max.)	60 s
Power factor (nom.)	0.6
Voltage (Nom)	220-240 V

Controls and Dimming	
Dimmable	No

Approval and Application	
Energy efficiency label (EEL)	A
Mercury (Hg) content (nom.)	1.5 mg
Energy Consumption kWh/1000 h	20 kWh

Product Data	
Full product code	871829166294500
Order product name	TornadoT2 8y 20W CDL E27 220-240V 1CT/12
EAN/UPC – product	8718291662945
Order code	66294500
Numerator – quantity per pack	1
Numerator – packs per outer box	12
Material no. (12NC)	929689848410
Net weight (piece)	0.065 kg

Tornado T2

Warnings and Safety

Dimensional drawing

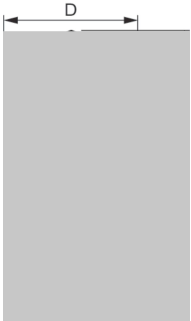

Product	D (max)	C (max)	F (max)
TornadoT2 8y 20W CDL E27 220-240V 1CT/12	56.5 mm	111.5 mm	47 mm

QSPIR-F 20W/865 E27 220-240V 50/60Hz

