

PHILIPS

Gamevision

BVP440



BVP440 HGB

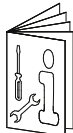
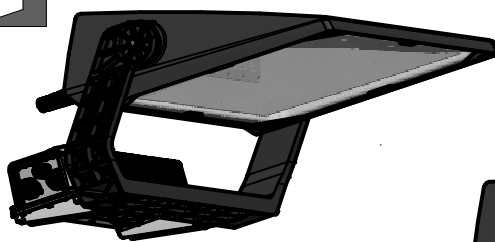

BV

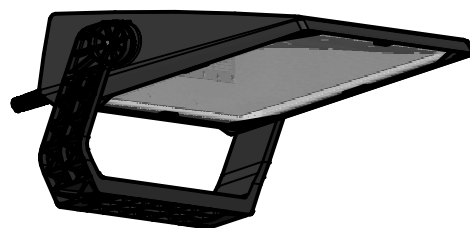

LEDs

IP66

IK08



Max.
50°C
Min.
-20°C

> 3m

220V
400V

50Hz
60Hz



IEC
EN60598

HGB

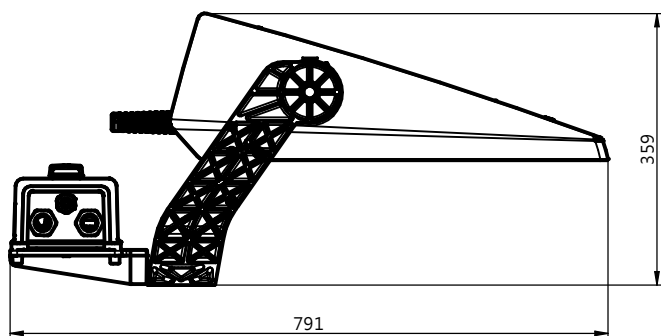

BV

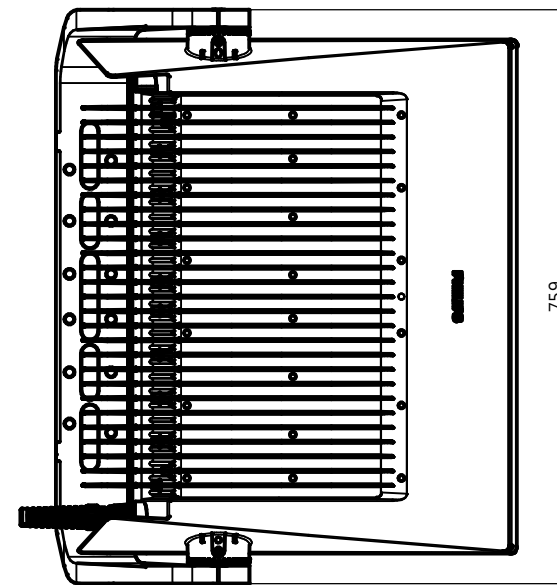
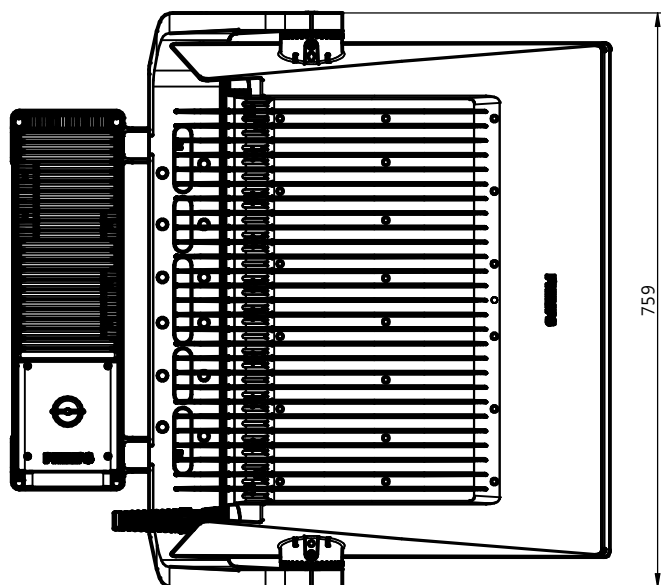
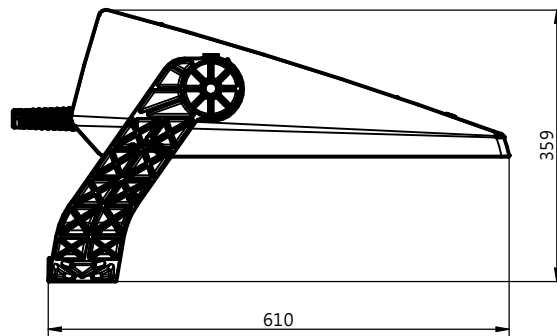

583 - 443000022439





2025-05-20

© Signify Holding
All rights reserved

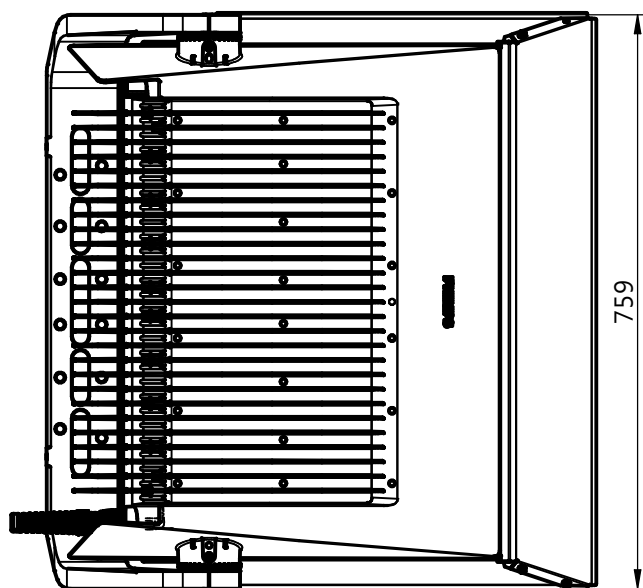
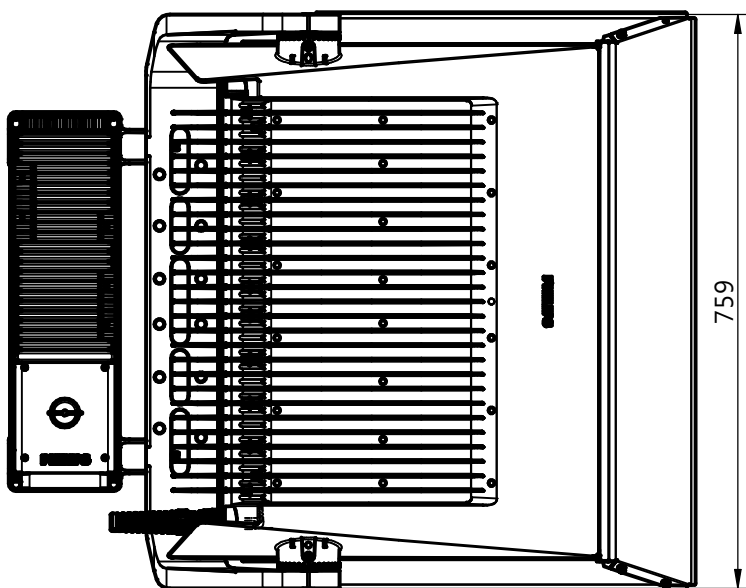
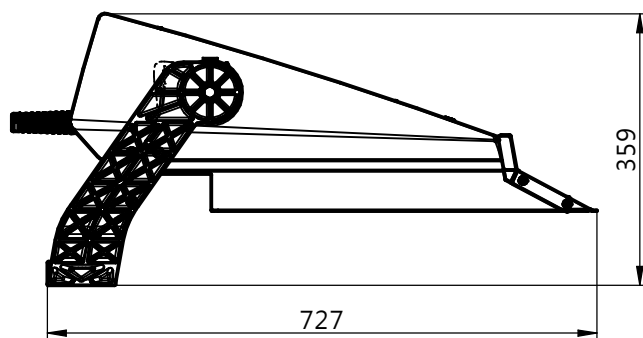
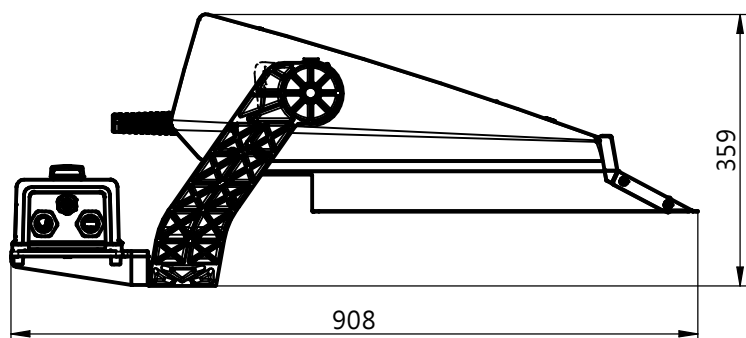
LOUVER OPTION BV

HGB



10° TILT	  m ²	  SCx(m ²)	 kg
BVP440 BV	0.18	0.22	18.8
BVP440 BV L	0.18	0.22	20.8
BVP440 HGB	0.25	0.3	24.8
BVP440 HGB L	0.25	0.3	26.8

CRI	CCT	Light Source Energy Efficiency Class	LSC*
70	3000	D	730
70	4000	D	740
70	5700	D	757

*LSC: Light Source Color



The luminaire should be positioned so that prolonged staring into the luminaire at a distance closer than 0,48m is not expected

POSITIONS ALLOWED

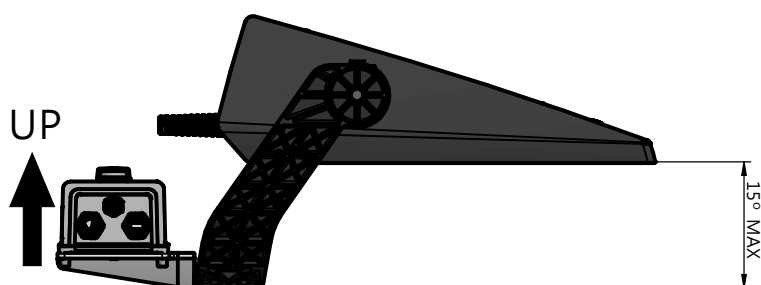

To reduce the risk of strangulation the flexible wiring connected to this luminaires shall be effectively fixed to the wall if the wiring is within arm's reach

MOUNTING REQUIREMENTS

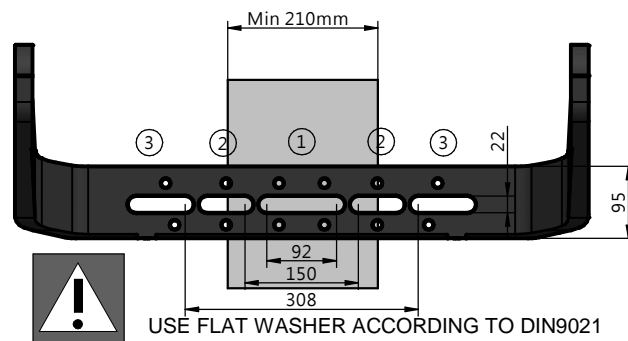
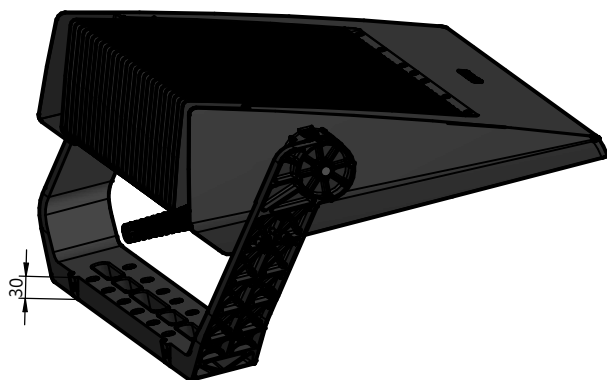

*OPTION 2xM20

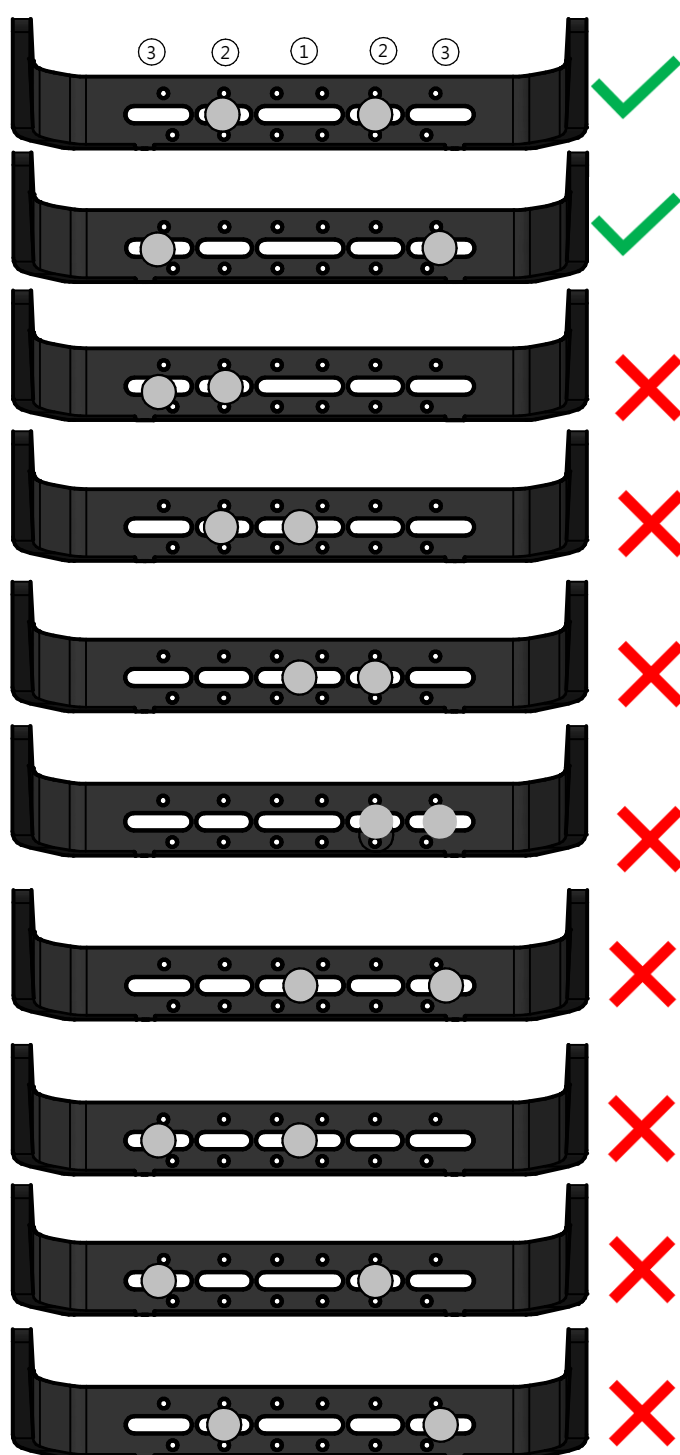

*OPTION 1xM20

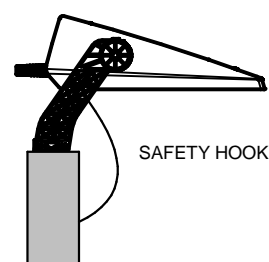
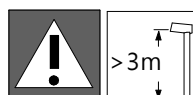
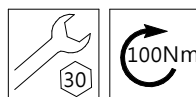
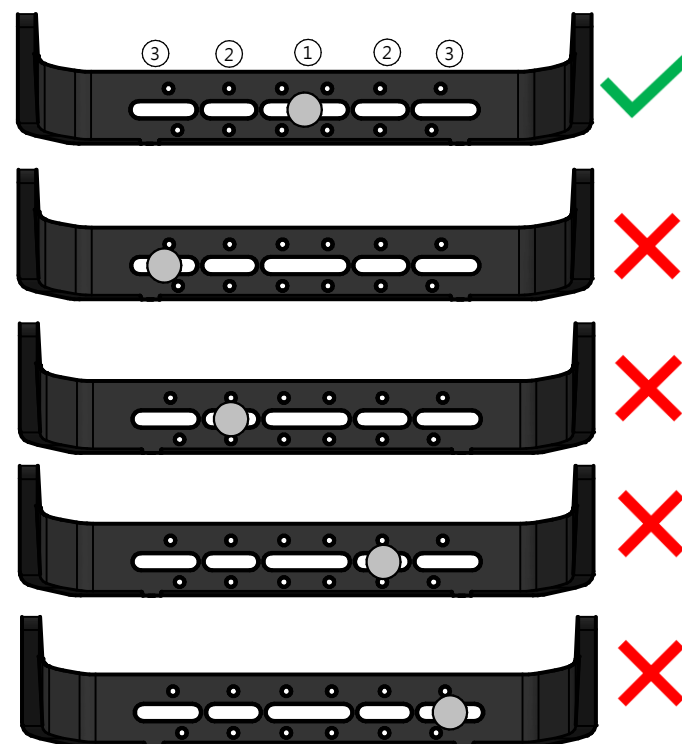

The fasteners have to resist environment corrosion.
RECOMMENDED CARBON STEEL 8.8 SCREWS

INSTALLATION-TILT OF THE LUMINAIRE



Attention: do not hold the luminaire by the cable gland

1

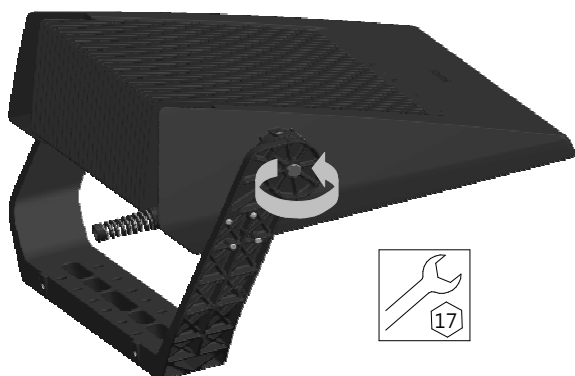

2

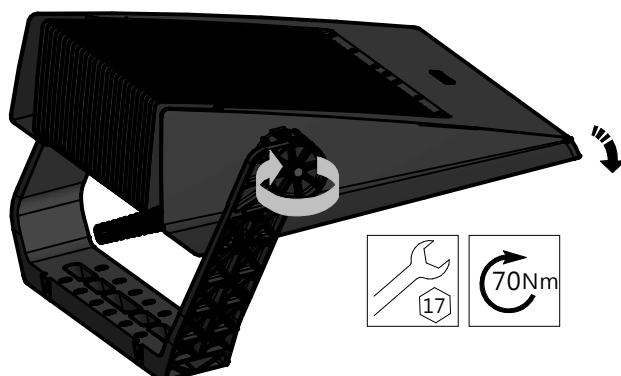

Go to page 7 when aiming device is used to aim the luminaire

3

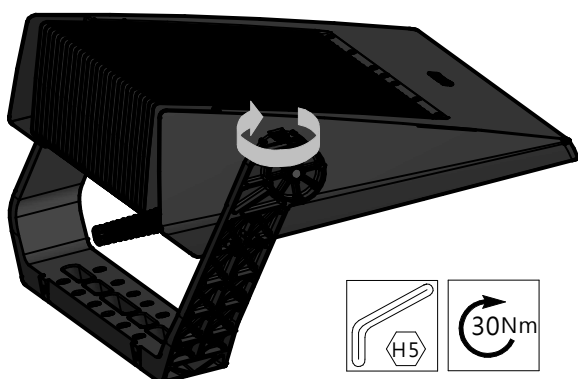

ACCESSORIES

LOUVER

12NC: 912300060799 ZVP440 LOUVER V2

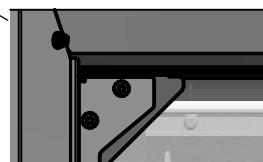
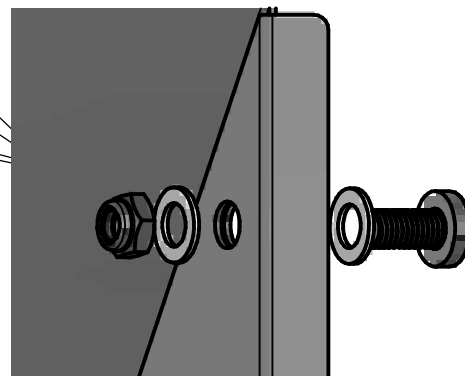
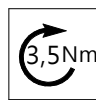
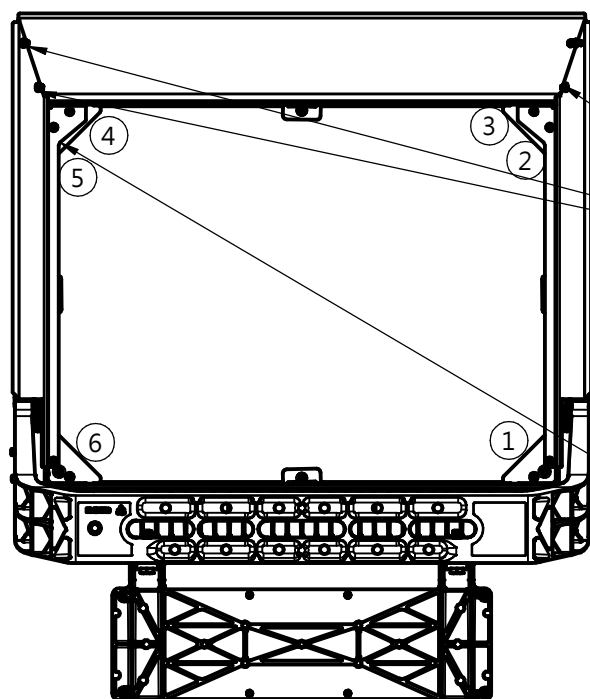

AIMING DEVICE

12NC: 912300060784 ZVP440 AIMING DEVICE V2

1



2

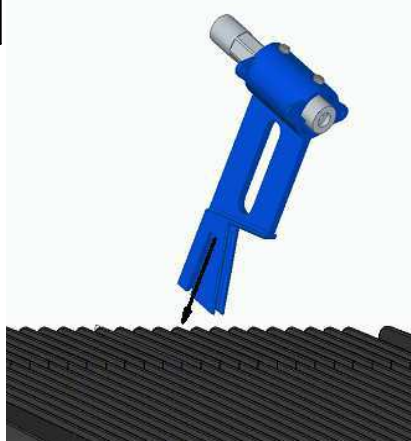

Position it in the middle rib of the luminaire

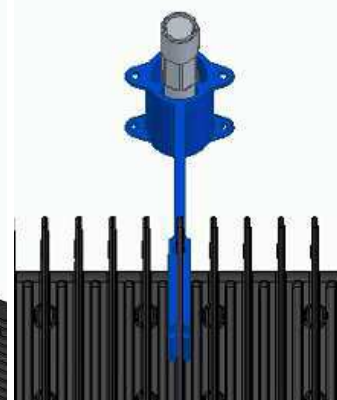

3

Point with this laser the desired location to aim the luminaire

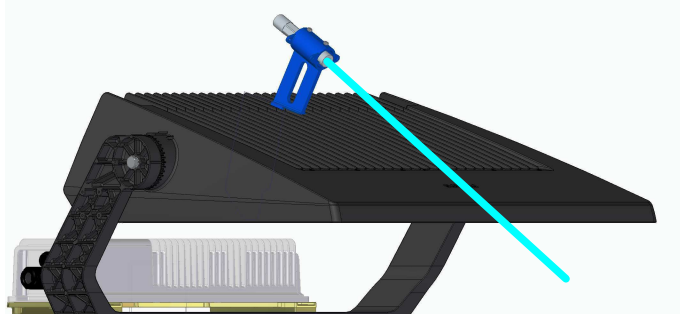

4



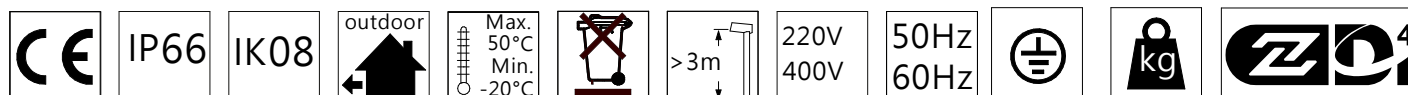
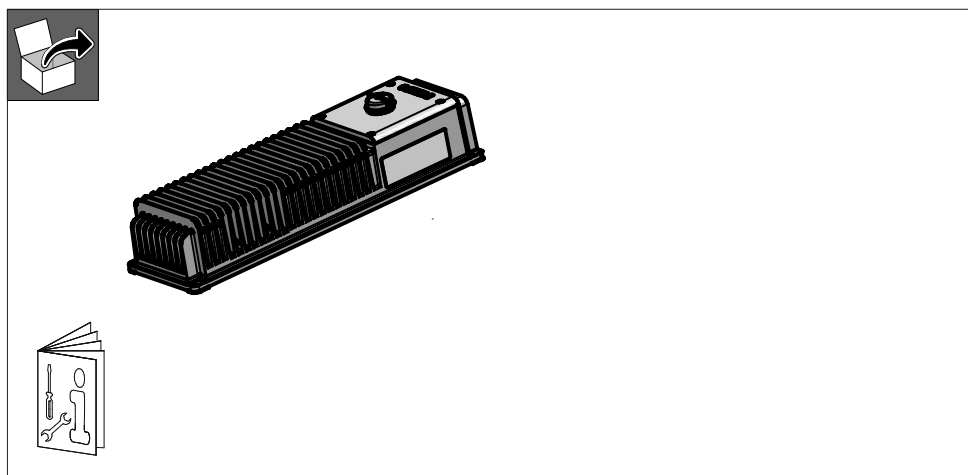

5.3

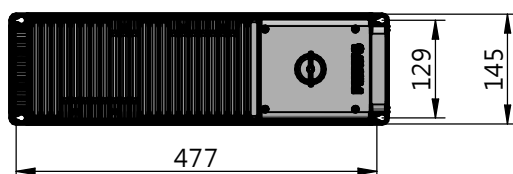
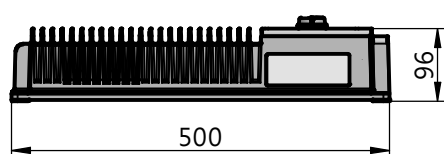

DRIVER BOX FEATURES

lin (Mains 230-240V)	8A
lin (Mains 380-400V)	4,6A
Inrush (230-240V)	20A during 200ms
Inrush (380-400V)	30A during 300ms
Power Factor	>0,9 at full power
Surge Protection*	10kV Com. Mode 10kV Dif.Mode
Maximum Heat Disipation+	75W

*Depending on application environment, additional surge protection (for example type 1&2 SPD) is recommended to reduce the energy of incoming surges

** According to the maximum heat disipation, a thermal study should be done for a cabinet installation

***The maximum number of luminaires to be connected to standard circuit breakers for driver is limited only by high input power of driver due to its high power. The Inrush pulse is very short, and neglecting the input current during operation, the Inrush pulse limits number of driver per MCB to around 100x, so 20-times higher than number of drivers limited by input current of the driver. For standard circuit breakers inrush pulses below 50µs are not to be considered

****When the product is used in CM the default value is 10%



583 - 443000022439

2025-05-20
© Signify Holding
All rights reserved

ELECTRICAL CONNECTION

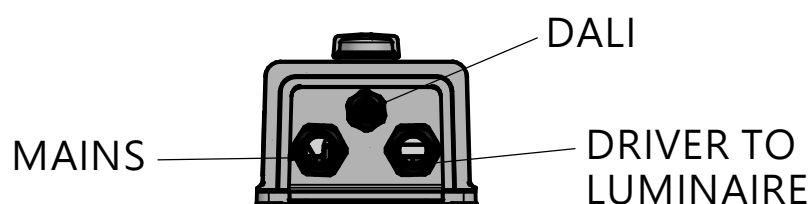

DALI cable gland is blind with plug by default

1. Remove plug only when needed
2. Slip the DALI cable through the cable gland
3. Do not remove plug if Zhaga connector is connected
4. Do not remove plug if Coded Mains set up is used and DALI cable is not connected

		Ø min (mm)	Ø max (mm)	TORQUE (Nm)	RECOMMENDED CABLE TYPE	CONNECTOR SECTION MAX
DALI	M20	6	12	4	H05VV-F (3182-Y) 2core x 1.5mm or H05VV-F (3182-Y) 2core x 2.5mm or 3 core x 1.5 or 2.5 mm	2.5
MAINS	M25	13	18	4.5	H07RN-F 450V/750V	4
DRIVER TO LUMINAIRE	M25	13	18	4.5	H07RN-F 450V/750 OR A11VV U-600/1000V 5core	2.5

1

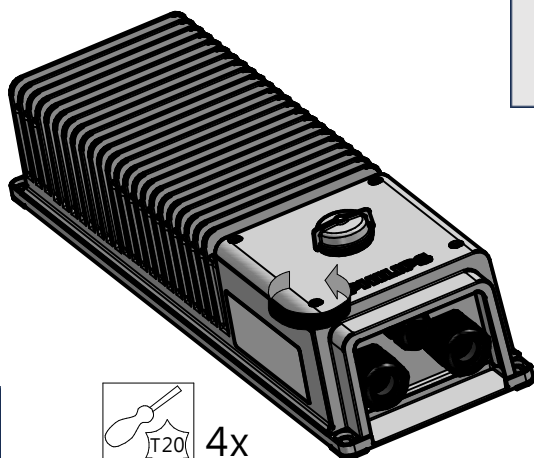

2

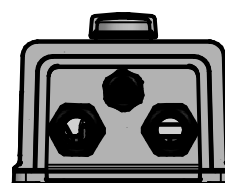

INSERT CABLE

INSERT CABLE
(ONLY BV VERSION)
ALREADY CONNECTED ON HGB VERSION

3



4x

REMOVAL FORBIDDEN

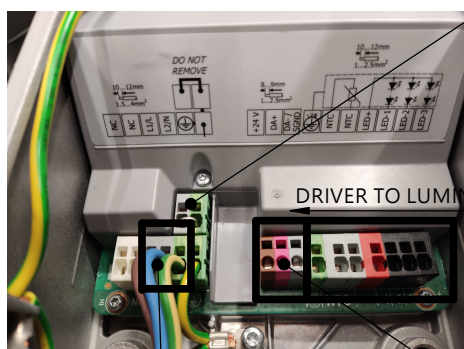

DRIVER TO LUMINAIRE

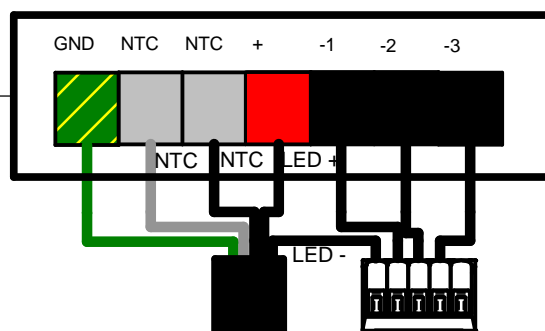

CABLE FROM DRIVER TO LUMINAIRE
NOT SUPPLIED BY PHILIPS IN BV VERSION

MAINS CONNECTION

220-240V	380-400V
NC=No connect	NC=No connect
L1=L	L1
L2=N	L2
GND=Ground	GND=Ground

From monophasic to multiphasic (bi/tri) no need to change anything in the driver

DALI CONNECTION

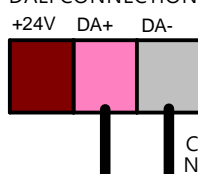

CABLE FOR DALI CONTROL
NOT SUPPLIED BY PHILIPS

ELECTRICAL CONNECTION

4

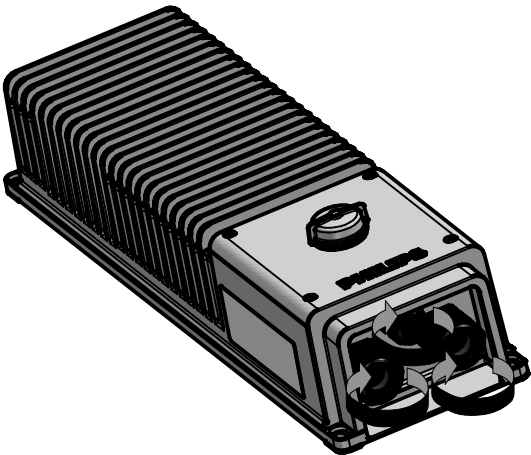

		Ø min (mm)	Ø max (mm)	TORQUE (Nm)	TOOL
DALI	M20	6	12	4	
MAINS	M25	13	18	4.5	
DRIVER TO LUMINAIRE	M25	13	18	4.5	

5

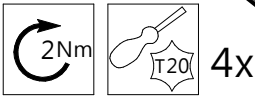
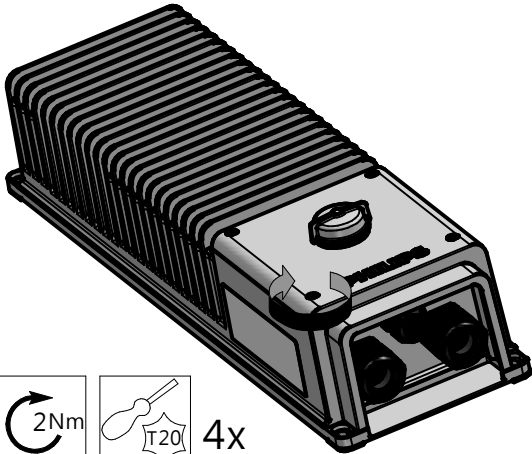

SEQUENCE

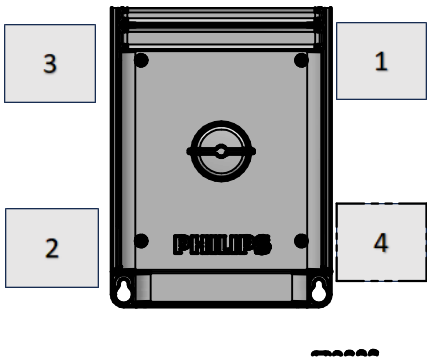

6

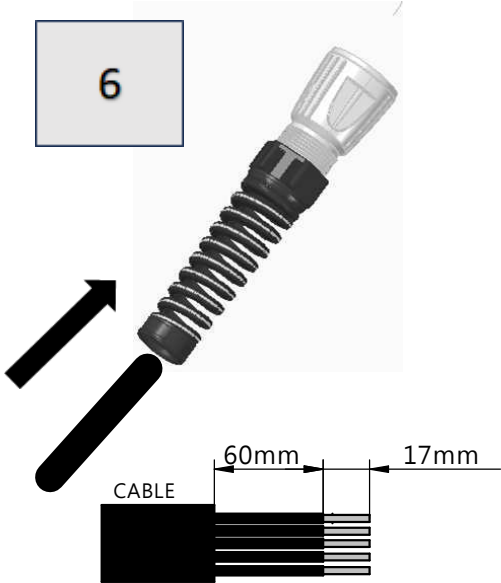

7

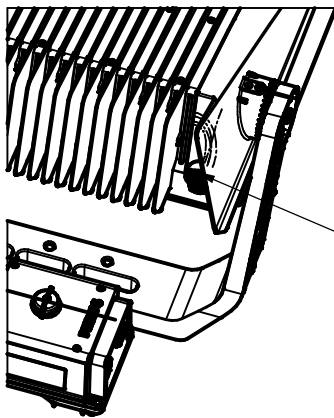

POLE	COLOR	FUNCTION
1	BROWN	LED+
2	BLACK	NTC
3	GREY	NTC
4	BLUE	LED-
GND	YELLOW/GREEN	GND



PUT GASKET
BEFORE CONNECTING

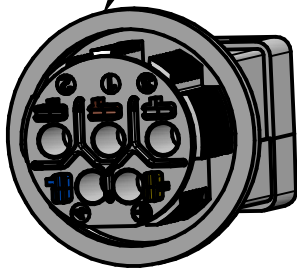

		Ø min (mm)	Ø max (mm)	CONNECTOR SECTION MAX	L MAX
DRIVER TO LUMINAIRE	M25	13	17	2.5	20m

8

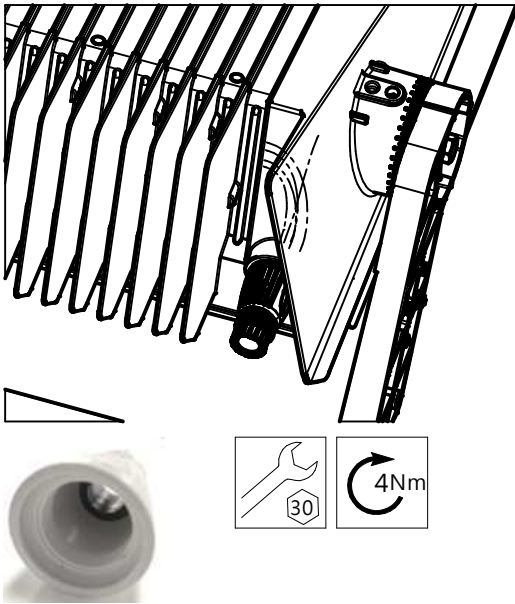

Remove black
grommet for cables
 $\varnothing > 13\text{mm}$

9

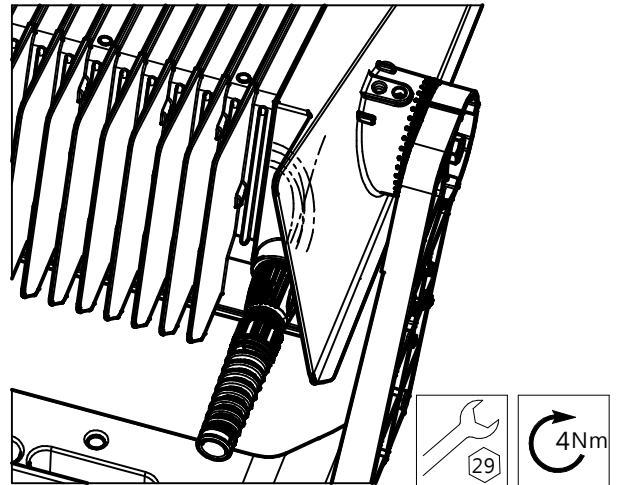

The cable gland/connector can hold the cables, but there is a limitation on the tension forces. It is recommended to have an intermediate fixation to limit the effect of weight.

The driver has the capability to support either :

- DALI2.0 interface : 2-wire long distance DALI cable connection (<300m) – connected to DA-/ SGND and DA+ connectors.

“SR PSU” should be disabled using Multione tool. (this is default config from factory).

-Zhaga D4i or SR interface : 2 options :

1. Zhaga/D4i connector on cover can be used. Connect the Zhaga/OLC connector on cover. To be used, the wire loom has to be connected inside driver properly to Zhaga connector and +24V/DA+/DA-_SGND connectors (*). Zhaga cable harness as accessory in the packaging External cable

2. 3-wire external cable connected to +24V/DA+/DA-_SGND connector, maximum allowed length < 30m, only for wiring inside cabinet or inside pole.

“SR PSU” should be enabled if needed using Multione tool. (disabled by default from factory). (This is not the 24V supply, which is always enabled)

Connecting DALI2.0 and D4i or SR configured devices together will not work properly except under specific condition. It is strongly not recommended to combine them.

SR CONNECTION

DRIVER CONNECTION FOR ZHAGA SOCKET ON DRIVER (HGB VERSION-DONE ON THE FACTORY)

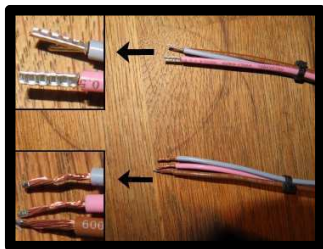
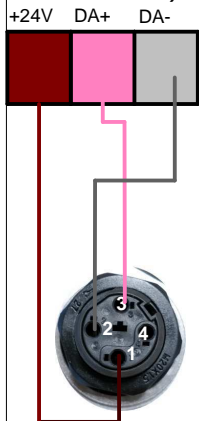

DRIVER CONNECTION SIDE

ZHAGA SOCKET CONNECTION SIDE

DRIVER CONNECTION FOR KIT (BV VERSION)

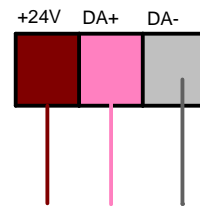

CABLE NOT SUPPLIED BY PHILIPS
KIT INSTRUCTIONS
SUPPLIED SEPARATELY INTO THE
BOX OF THE KIT

1

SHS NODE

Power OFF

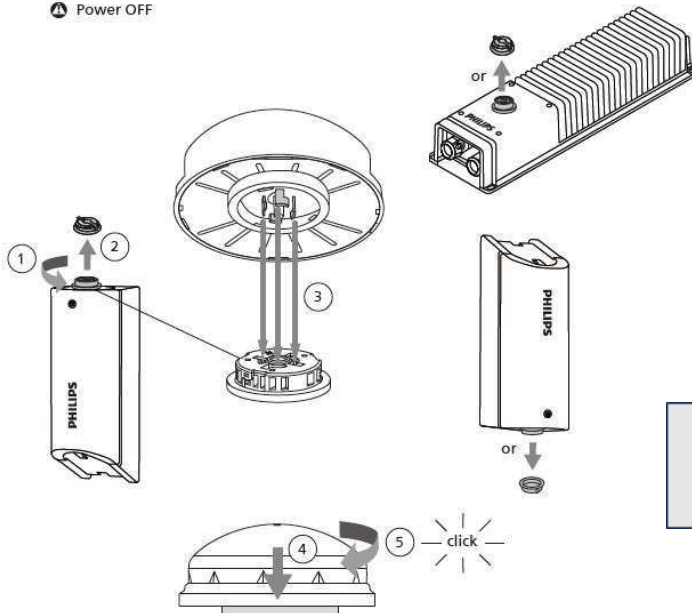

2

Power ON

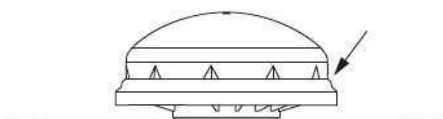

LED ☒
 ☒ Check power



Specification Sheet

3

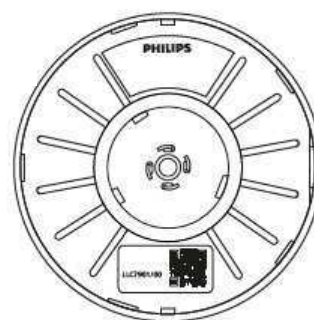

Commissioning Guide

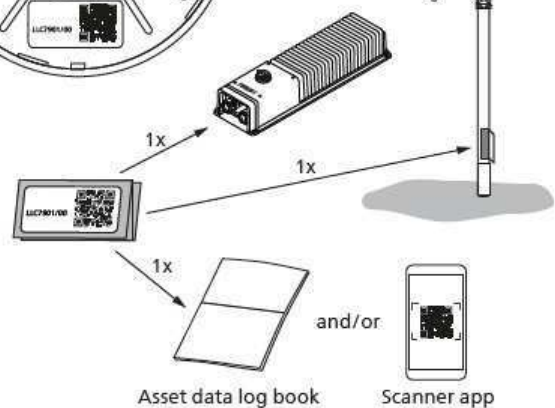

Asset data log book



Scanner app



Installation of drivers boxes on cabinet

ORIENTATION

Each driver box in the cabinet has to be in vertical position

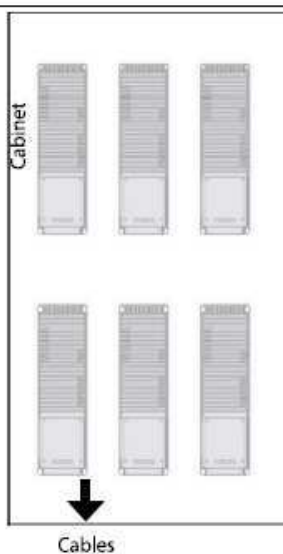

DISTANCES

The distances between driver boxes or wall have to be higher than:

Item	Distance
1*	Min 50mm
2**	Min 80mm
3**	Min 50mm
4**	Min 150mm
5*	Min 200mm

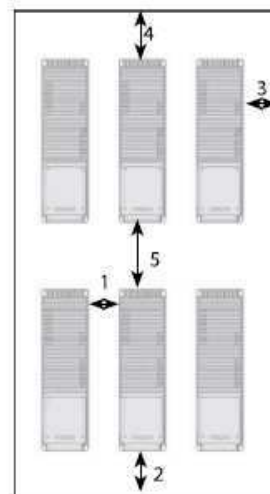

* not mandatory if there is an active cooling inside the cabinet. The cooling study must be done
** Recommended distances, but the temperatures inside the cabinet and Tc driver must be checked

TEMPERATURES

MAXIMUM Relative Humidity:
95% -> Storage & Transport
90% -> Operating (no condensation allowed)

A thermal study must be done in order to respect Tc of the drivers below Tc max.
Tc of the driver must be checked

A temperature sensor must be installed inside the cabinet between two driver boxes.
The temperature measured by the sensor has to be lower than 45°C.
We recommend a cabinet protected against solar action.

An active cooling can be added in the cabinet to guarantee a maximum temperature of 45°C all along the year

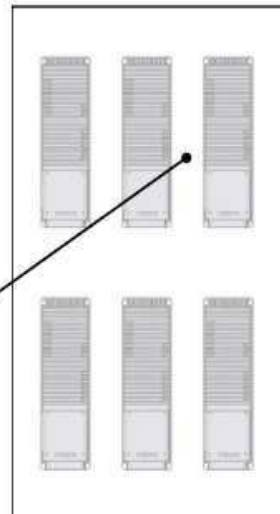



Installation of driver boxes in the mast



minimum width of the door: 125mm
minimum height of the door: 600mm



ZHAGA SENSING/COMMUNICATION
MODULES PLUGGED UNTO THE SOCKET
(Z-LEX-R) NOT TO BE USED IN THIS CASE

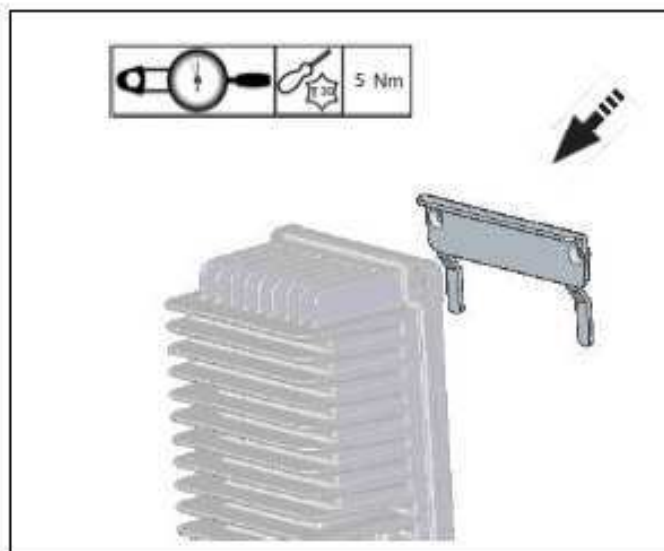

Depending of the driver fixation in the mast, please select the most suitable hook.



Installation of LED unit/driver. Positions allowed



Cable gland on the bottom



Cable gland on the top



Breathers cannot be exposed directly to water

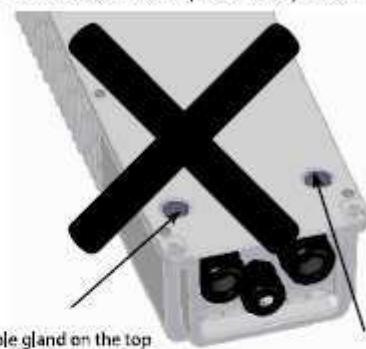



© 2025 Signify Holding

All rights reserved. This document contains information relating to the product portfolio of Signify which information may be subject to change. No representation or warranty as to the accuracy or completeness of the information included herein is given and any liability for any action in reliance thereon is disclaimed. The information presented in this document is not intended as any commercial offer and does not form part of any quotation or contract. Philips and the Philips Shield Emblem are registered trademarks of Koninklijke Philips N.V.. All other trademarks are owned by Signify Holding or their respective owners.

Signify Holding
The Netherlands