

## Dismantling Recommendation on Disposal at End of Life

### A. Composition Explanation – Downlight Type A

*Followed drawings are references only*

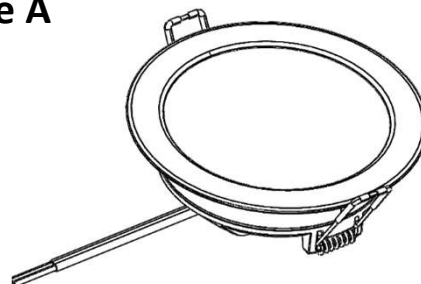

#### • Main Parts

				
<b>01 Diffusor</b>	<b>02 Reflector</b>	<b>03 Springs</b>	<b>04 Front Trim</b>	<b>05 Light Source</b>

#### • Other Parts (If included)

<b>06 Screws</b>	<b>07 Connector box</b>	<b>08 Connector</b>
------------------	-------------------------	---------------------

The downlight luminaire is considered as a containing product which comprises:

#### **01 Diffusor**

*The diffusor may have different shapes, such as Round, Square, Rectangle, Dome etc. Taking the Round as Example; The diffusor may have different surface finishing with matte, glossy, plate, 0-100% transparent etc.*

#### **02 Reflector**

*The reflector may have different shapes and structure, which are based on design itself*

#### **03 Springs**

*The spring may have different length, width, and plastic cover*

#### **04 Front trim**

*The front trim may also have different shape and material type, which are based on design itself.*

#### **05 Light source**

*The light source is including housing body, driver, PCB with LEDs and AC/DC wires*

### B. Dismantling

- Type: Without permanent damage

## Dismantling Recommendation on Disposal at End of Life

### C. Recommendation on Disposal

- Plastic part: Reuse and Recycling
- Electrical part: Incineration and disposal
- Metal part: Recycling

### D. The Steps to Remove the Components

#### 1 Using tool to pry the cover

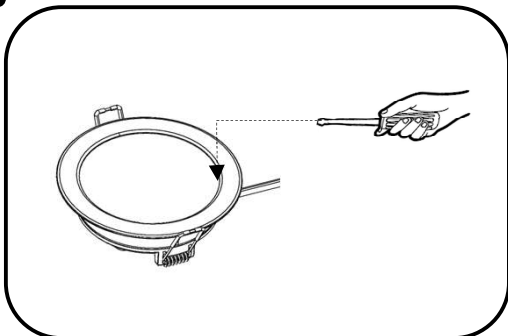

#### 2 Removing Springs

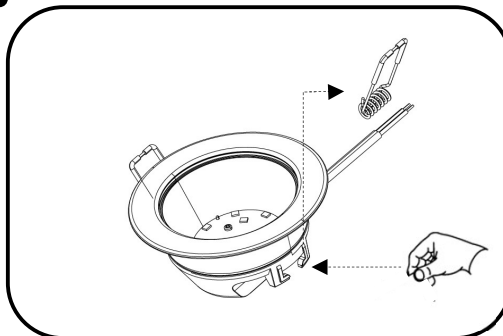

#### 3 Removing reflector

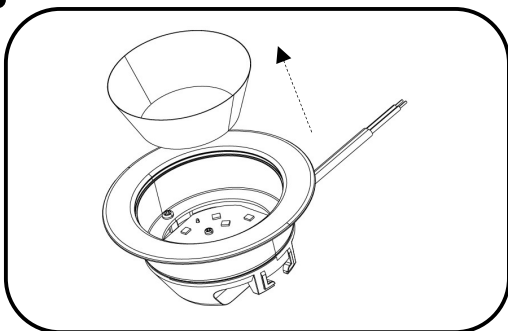

#### 4 Removing screws out

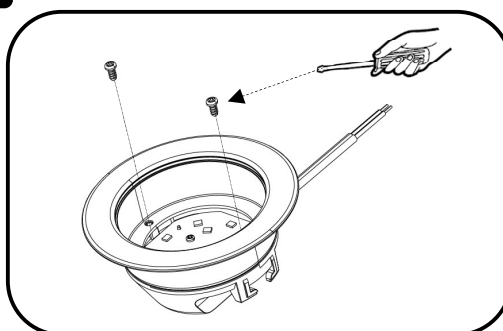

#### 5 Removing Front Trim and get the light source

