

# PHILIPS

Blaise Ultra Efficient  
9290046318



User manual  
Benutzerhandbuch  
Notice d'emploi  
Manual de usuario  
Manual do usuário  
Manuale d'uso  
Gebruiksaanwijzing

Incl.

**A**



**B**

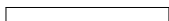
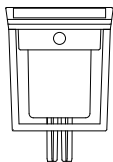

Excl.

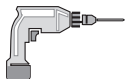

**B**



IP44

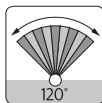
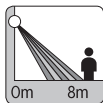

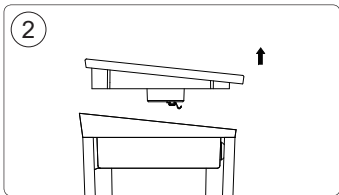
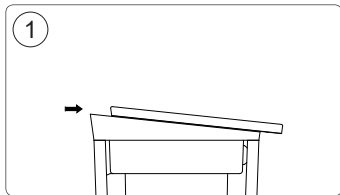

3

		10
	 OFF	 OFF
	 OFF	 ON
	 ON	 ON
	 ON	 ON
	 OFF	 ON

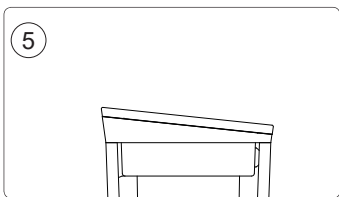
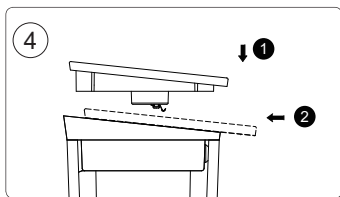

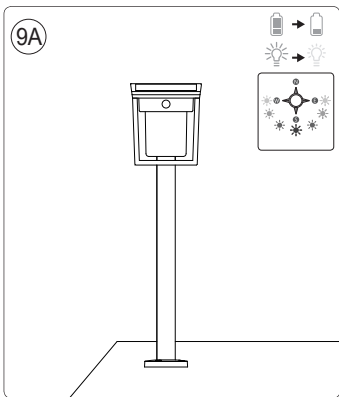
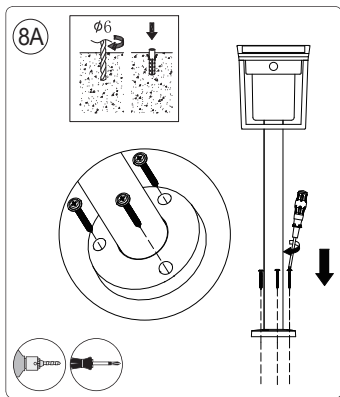
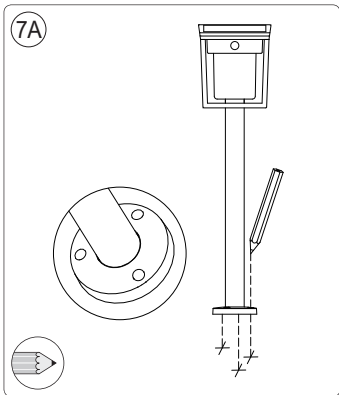
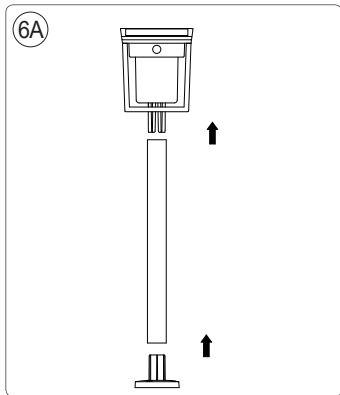

6B

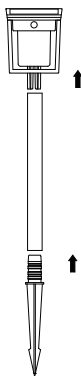

7B

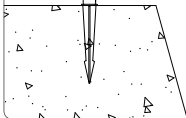

10

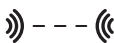
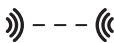
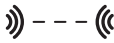

## Replace Battery

1

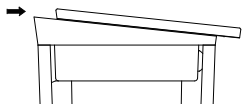

2

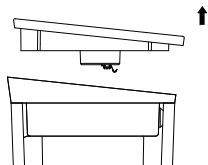

3

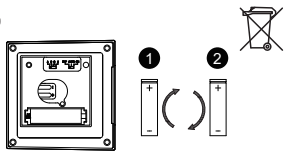

4

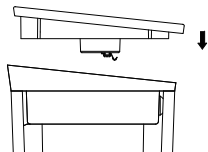

5

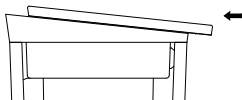

6

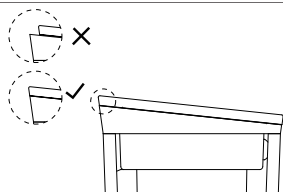





Signify Commercial UK Limited  
Unit 3, Guildford Business Park,  
Guildford, Surrey, GU2 8XG, UK

Signify  
I.B.R.S. / C.C.R.I. Numéro 10461  
5600 VB Eindhoven,  
the Netherlands  
☎00800-74454775

Philips and the Philips Shield Emblem are registered trademarks  
of Koninklijke Philips N.V. and are used under license

3241 662 11361  
[www.philips.com/lighting](http://www.philips.com/lighting)

© 2024 Signify Holding

The Signify logo, which consists of a stylized lowercase 's' inside a circle, followed by the word "signify" in a lowercase, sans-serif font.