



CoreLine Projector gen2

ST151T LED30S/930 MB BK

CoreLine Projector gen2, Track-mounted, 30 W, D80 mm, 3000 lm, 3000 K, CRI>90, Medium beam, Black

Track-mounted, D80 mm, Aluminium, Black, Power supply unit (On/Off), 3000 lm, 30 W, 100 lm/W, 3000 K, (0.4355, 0.4045) SDCM <4, CRI>90, UGR19, Medium beam, Polycarbonate, IP20 | Finger-protected, IK03 | 0.3 J, Safety class I, 3C Track

Warnings and Safety

- The luminaire should be mounted outside of arm's reach
- The luminaire should be installed by a qualified electrician and wired in accordance with the latest IEE electrical regulations or the national requirements

Product data

General Information		Luminous efficacy (rated) (nom.)	
Light source replaceable	No		100 lm/W
Number of gear units	Unit	Colour rendering index (CRI)	>90
Driver included	Yes	Beam angle of light source	25 degree(s)
Service Tag	No	Light source colour	930 warm white
Lighting Technology	LED	Optic type	Medium beam
Value ladder	Performance	Luminaire light beam spread	25°
Warranty period	5 years	Unified Glare Rating (CEN)	19
Light Technical		Operating and Electrical	
Luminous Flux	3,000 lm	Input Voltage	220 to 240 V
Saturated Red (R9)	>50	Line Frequency	50 or 60 Hz
Correlated Colour Temperature (Nom)	3000 K	Initial CLO power consumption	30 W
		Average CLO power consumption	30 W

CoreLine Projector gen2

Inrush current	43.8 A
Inrush time	0.0115 ms
Power Consumption	30 W
Power Factor (Fraction)	0.9
Connection	3C Track
Cable	-
Number of products on MCB (16 A type B)	30
Suitable for random switching	No
Protection class IEC	Safety class I
Total harmonic distortion	20 %

Controls and Dimming

Dimmable	No
Driver/power unit/transformer	Power supply unit (On/Off)
Constant light output	No
Maximum dim level	Not applicable

Mechanical and Housing

Housing material	Aluminium
Reflector material	-
Optic material	Polycarbonate
Optical cover/lens material	Polycarbonate
Fixation material	-
Housing Colour	Black
Optical cover/lens finish	-
Overall length	207 mm
Overall width	87 mm
Overall height	125 mm
Overall diameter	80 mm
Dimensions (height x width x depth)	125 x 87 x 207 mm
Ingress protection code	IP20 [Finger-protected]
Mech. impact protection code	IK03 [0.3 J]
Net Weight (Piece)	0.510 kg

Approval and Application

Glow-wire test	Temperature 650 °C, duration 30 s
Flammability mark	-
CE mark	Yes
ENEC mark	ENEC mark
Photobiological risk	Photobiological risk group 0 @200mm to EN62778
Photobiological risk specification	0.2 m
EU RoHS compliant	Yes
Performance ambient temperature Tq	25 °C
Flickering value (PstLM)	1
Stroboscopic effect	1.6

Ambient temperature range	-20 to +40 °C
---------------------------	---------------

Initial Performance (IEC Compliant)

Luminous flux tolerance	+/-10%
Initial chromaticity	(0.4355, 0.4045) SDCM <4
Power consumption tolerance	+/-10%
Standard Deviation of Colour Matching (McAdam ellipse)	SDCM≤4

Over Time Performance (IEC Compliant)

Control gear failure rate at median useful life 50,000 h	5 %
Lumen maintenance (EN-IEC 62722-2-1) at median useful life* 50000 h	L70

Sustainability Data

Sustainability rating	Unclassified
Repair class	Repair Class D, this product is not designed to be repaired.
Embedded carbon (A1-A3)	10.3 kg CO ₂ e
Product non-virgin material ratio	8.02 %
Recyclable the content ratio of the finished product	37.7 %
GWP total B6 (kg CO ₂ eq) Declared Unit	Please calculate using your local energy mix value: Power Declared Unit (kW) * Service life (hrs) Declared Unit * Energy mix (kg CO ₂ eq / kWh)
GWP total B6 (kg CO ₂ eq) Functional Unit	Please calculate using your local energy mix value: POWER DECLARED UNIT (kW) * 1000 (lm) / LUMEN OUTPUT DECLARED UNIT (lm) * 35000 (hrs) * ENERGY MIX (kg CO ₂ eq / kWh)

Product Data

Order product name	ST151T LED30S/930 MB BK
Full product name	ST151T LED30S/930 MB BK
Full EOC	871951452855099
Order code	911401846582
Material no. (12 NC)	911401846582
Numerator – quantity per pack	1
EAN/UPC – Product/Case	8719514528550
Numerator – packs per outer box	10
EAN/UPC - Case	8719514528635

CoreLine Projector gen2

Dimensional drawing

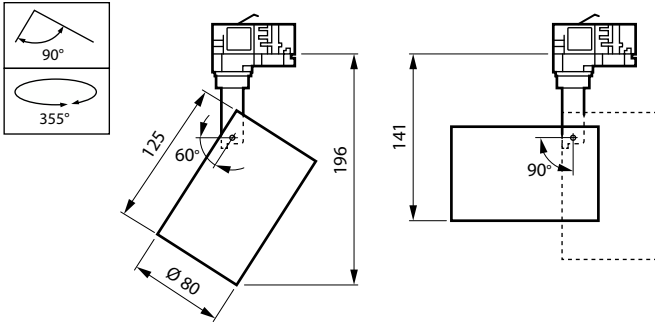

Photometric data

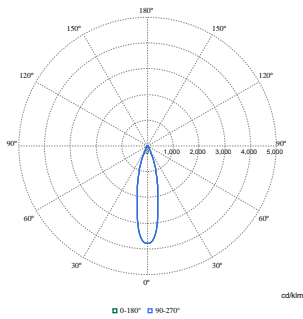

Polar Normal (separate) - 911401846582

