



CoreLine Projector gen2

ST151T LED30S/940 MB WH

CoreLine Projector gen2, Track-mounted, 27 W, D80 mm, 3000 lm, 4000 K, CRI>90, Wide beam, White

Track-mounted, D80 mm, Aluminium, White, Power supply unit (On/Off), 3000 lm, 27 W, 110 lm/W, 4000 K, (0.3837, 0.3828) SDCM <4, CRI>90, Wide beam, Polycarbonate, IP20 | Finger-protected, IK03 | 0.3 J, Safety class I, 3C Track

Warnings and Safety

- The luminaire should be mounted outside of arm's reach
- The luminaire should be installed by a qualified electrician and wired in accordance with the latest IEE electrical regulations or the national requirements

Product data

| General Information | | Luminous efficacy (rated) (nom.) | |
|-------------------------------------|-------------|----------------------------------|-------------------|
| Light source replaceable | No | | 110 lm/W |
| Number of gear units | Unit | Colour rendering index (CRI) | >90 |
| Driver included | Yes | Beam angle of light source | 25 degree(s) |
| Service Tag | No | Light source colour | 940 neutral white |
| Lighting Technology | LED | Optic type | Wide beam |
| Value ladder | Performance | Luminaire light beam spread | 25° |
| Warranty period | 5 years | Unified Glare Rating (CEN) | 20 |
| Light Technical | | Operating and Electrical | |
| Luminous Flux | 3,000 lm | Input Voltage | 220 to 240 V |
| Saturated Red (R9) | >50 | Line Frequency | 50 or 60 Hz |
| Correlated Colour Temperature (Nom) | 4000 K | Initial CLO power consumption | 27 W |
| | | Average CLO power consumption | 27 W |

CoreLine Projector gen2

| | |
|---|----------------|
| Inrush current | 43.8 A |
| Inrush time | 0.0115 ms |
| Power Consumption | 27 W |
| Power Factor (Fraction) | 0.9 |
| Connection | 3C Track |
| Cable | - |
| Number of products on MCB (16 A type B) | 30 |
| Suitable for random switching | No |
| Protection class IEC | Safety class I |
| Total harmonic distortion | 20 % |

Controls and Dimming

| | |
|-------------------------------|----------------------------|
| Dimmable | No |
| Driver/power unit/transformer | Power supply unit (On/Off) |
| Constant light output | No |
| Maximum dim level | Not applicable |

Mechanical and Housing

| | |
|-------------------------------------|-------------------------|
| Housing material | Aluminium |
| Reflector material | - |
| Optic material | Polycarbonate |
| Optical cover/lens material | Polycarbonate |
| Fixation material | - |
| Housing Colour | White |
| Optical cover/lens finish | - |
| Overall length | 207 mm |
| Overall width | 87 mm |
| Overall height | 125 mm |
| Overall diameter | 80 mm |
| Dimensions (height x width x depth) | 125 x 87 x 207 mm |
| Ingress protection code | IP20 [Finger-protected] |
| Mech. impact protection code | IK03 [0.3 J] |
| Net Weight (Piece) | 0.510 kg |

Approval and Application

| | |
|------------------------------------|--|
| Glow-wire test | Temperature 650 °C, duration 30 s |
| Flammability mark | - |
| CE mark | Yes |
| ENEC mark | ENEC mark |
| Photobiological risk | Photobiological risk group 0 @200mm to EN62778 |
| Photobiological risk specification | 0.2 m |
| EU RoHS compliant | Yes |
| Performance ambient temperature Tq | 25 °C |
| Flickering value (PstLM) | 1 |
| Stroboscopic effect | 1.6 |

| | |
|---------------------------|---------------|
| Ambient temperature range | -20 to +40 °C |
|---------------------------|---------------|

Initial Performance (IEC Compliant)

| | |
|--|--------------------------|
| Luminous flux tolerance | +/-10% |
| Initial chromaticity | (0.3837, 0.3828) SDCM <4 |
| Power consumption tolerance | +/-10% |
| Standard Deviation of Colour Matching (McAdam ellipse) | SDCM≤4 |

Over Time Performance (IEC Compliant)

| | |
|---|-----|
| Control gear failure rate at median useful life 50,000 h | 5 % |
| Lumen maintenance (EN-IEC 62722-2-1) at median useful life* 50000 h | L70 |

Sustainability Data

| | |
|--|---|
| Sustainability rating | Unclassified |
| Repair class | Repair Class D, this product is not designed to be repaired. |
| Embedded carbon (A1-A3) | 9.96 kg CO ₂ e |
| Product non-virgin material ratio | 6.51 % |
| Recyclable the content ratio of the finished product | 37.7 % |
| GWP total B6 (kg CO ₂ eq) Declared Unit | Please calculate using your local energy mix value: Power Declared Unit (kW) * Service life (hrs) Declared Unit * Energy mix (kg CO ₂ eq / kwh) |
| GWP total B6 (kg CO ₂ eq) Functional Unit | Please calculate using your local energy mix value: POWER DECLARED UNIT (kW) * 1000 (lm) / LUMEN OUTPUT DECLARED UNIT (lm) * 35000 (hrs) * ENERGY MIX (kg CO ₂ eq / kwh) |

Product Data

| | |
|---------------------------------|-------------------------|
| Order product name | ST151T LED30S/940 MB WH |
| Full product name | ST151T LED30S/940 MB WH |
| Full EOC | 871951452858199 |
| Order code | 911401846882 |
| Material no. (12 NC) | 911401846882 |
| Numerator – quantity per pack | 1 |
| EAN/UPC – Product/Case | 8719514528581 |
| Numerator – packs per outer box | 10 |
| EAN/UPC - Case | 8719514528666 |

CoreLine Projector gen2

Dimensional drawing

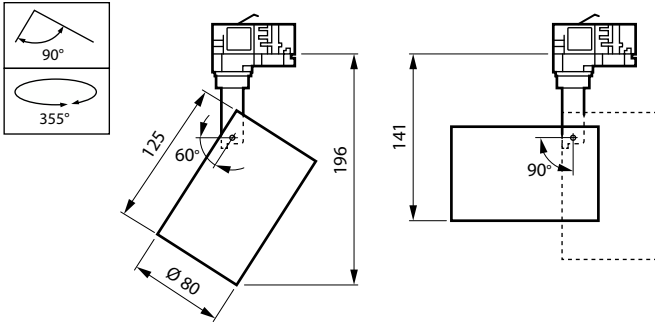

Photometric data

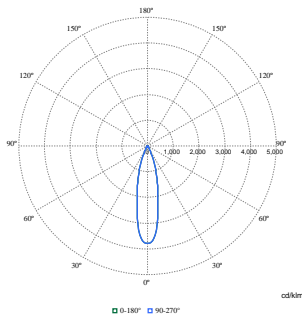

Polar Normal (separate) - 911401846882

