



CoreLine Projector gen2

ST151T LED30S/930 WB WH

CoreLine Projector gen2, Track-mounted, 30 W, D80 mm, 3000 lm, 3000 K, CRI>90, Wide beam, White

The well-known CoreLine Projector with its latest generation has undergone important design and performance improvement, raising the bar even higher and setting a new standard for track projectors used in retail and hospitality applications.

Warnings and Safety

- The luminaire should be mounted outside of arm's reach
- The luminaire should be installed by a qualified electrician and wired in accordance with the latest IEE electrical regulations or the national requirements

Product data

General Information		Saturated Red (R9)	
Light source replaceable	No		>50
Number of gear units	Unit	Correlated Colour Temperature (Nom)	3000 K
Driver included	Yes	Luminous efficacy (rated) (nom.)	100 lm/W
Lighting Technology	LED	Colour rendering index (CRI)	>90
Value ladder	Performance	Beam angle of light source	38 degree(s)
Serviceability class	Class C, luminaire without serviceable parts, not serviceable	Light source colour	930 warm white
Warranty period	5 years	Optic type	Wide beam
Sustainability rating	Unclassified	Luminaire light beam spread	38°
		Unified Glare Rating (CEN)	19
Light Technical		Sustainability Data	
Luminous Flux	3,000 lm	Product non-virgin material ratio	6.63 %

CoreLine Projector gen2

GWP total B6 (kg CO2eq) Declared Unit	Please calculate using your local energy mix value: Power Declared Unit (W) * Service life (hrs) Declared Unit * Energy mix (kg CO2eq / kwh)
GWP total B6 (kg CO2eq) Functional Unit	Please calculate using your local energy mix value: Power Declared Unit (W) * 1000 (lm) / lumen output (lm) Declared Unit * 35000 (hrs) * Energy mix (kg CO2eq / kwh)

Operating and Electrical

Input Voltage	220 to 240 V
Line Frequency	50 or 60 Hz
Initial CLO power consumption	30 W
Average CLO power consumption	30 W
Inrush current	43.8 A
Inrush time	0.0115 ms
Power Consumption	30 W
Power Factor (Fraction)	0.9
Connection	3C Track
Cable	-
Number of products on MCB (16 A type B)	30
Suitable for random switching	No
Protection class IEC	Safety class I
Total harmonic distortion	20 %

Controls and Dimming

Dimmable	No
Driver/power unit/transformer	Power supply unit (On/Off)
Constant light output	No
Maximum dim level	Not applicable

Mechanical and Housing

Housing material	Aluminium
Reflector material	-
Optic material	Polycarbonate
Optical cover/lens material	Polycarbonate
Fixation material	-
Housing Colour	White
Optical cover/lens finish	-
Overall length	207 mm
Overall width	87 mm
Overall height	125 mm
Overall diameter	80 mm

Dimensions (height x width x depth)	125 x 87 x 207 mm
Ingress protection code	IP20 [Finger-protected]
Mech. impact protection code	IK03 [0.3 J]
Net Weight (Piece)	0.510 kg

Approval and Application

Glow-wire test	Temperature 650 °C, duration 30 s
Flammability mark	-
CE mark	Yes
ENEC mark	ENEC mark
Photobiological risk	Photobiological risk group 0 @200mm to EN62778
Photobiological risk specification	0.2 m
EU RoHS compliant	Yes
Performance ambient temperature Tq	25 °C
Flickering value (PstLM)	1
Stroboscopic effect	1.6
Ambient temperature range	-20 to +40 °C

Initial Performance (IEC Compliant)

Luminous flux tolerance	+/-10%
Initial chromaticity	(0.4355, 0.4045) SDCM <4
Power consumption tolerance	+/-10%
Standard Deviation of Colour Matching (McAdam ellipse)	SDCM≤4

Over Time Performance (IEC Compliant)

Control gear failure rate at median useful life 50,000 h	5 %
Lumen maintenance (EN-IEC 62722-2-1) at median useful life* 50000 h	L70

Product Data

Order product name	ST151T LED30S/930 WB WH
Full product name	ST151T LED30S/930 WB WH
Full EOC	871951452861199
Order code	911401847182
Material no. (12 NC)	911401847182
Numerator – quantity per pack	1
EAN/UPC – Product/Case	8719514528611
Numerator – packs per outer box	10
EAN/UPC – Case	8719514528697

CoreLine Projector gen2

Dimensional drawing

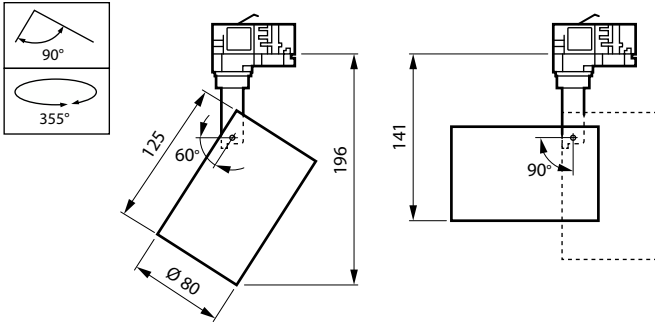

Photometric data

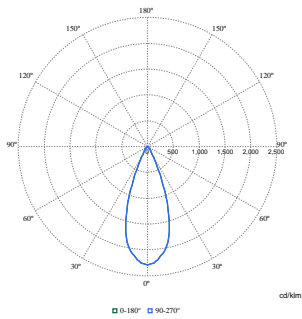

Polar Normal (separate) - null - 911401847182

