



# HID ignitors for series systems

## SND 57 220-240V 50/60HZ

HID ignitors for series systems

### Product data

|                          |                             |
|--------------------------|-----------------------------|
| Operating and Electrical |                             |
| Input Voltage            | 220 to 240 V                |
| Line Frequency           | 50 to 60 Hz                 |
| Input frequency          | 50 to 60 Hz                 |
| Wiring                   |                             |
| Connector type           | Screw                       |
| Temperature              |                             |
| T-Case maximum (max.)    | 90 °C                       |
| Mechanical and Housing   |                             |
| Housing                  | SNI-85                      |
| Net Weight (Piece)       | 0.050 kg                    |
| Approval and Application |                             |
| Approval marks           | CE marking ENEC certificate |

|                                 |                         |
|---------------------------------|-------------------------|
| Ambient temperature range       | -20°C to 85°C           |
| Product Data                    |                         |
| Order product name              | SND 57 220-240V 50/60Hz |
| Full product name               | SND 57 220-240V 50/60HZ |
| Full EOC                        | 871150093066830         |
| Order code                      | 93066830                |
| Material no. (12 NC)            | 913700184966            |
| Local order code                | SND57                   |
| Numerator – quantity per pack   | 1                       |
| EAN/UPC – Product/Case          | 8711500930668           |
| Numerator – packs per outer box | 48                      |
| EAN/UPC - Case                  | 8711500930675           |

# HID ignitors for series systems

## Dimensional drawing

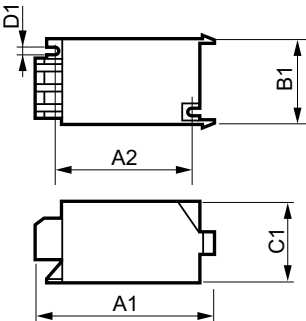

| Product                 | D1     | C1      | A1      | A2      | B1      |
|-------------------------|--------|---------|---------|---------|---------|
| SND 57 220-240V 50/60Hz | 4.3 mm | 38.5 mm | 84.5 mm | 65.0 mm | 41.5 mm |

