



HID-HighPower for SON/MH/HPL/HPI

BHL 1000 L78 230/240V 50HZ HP-207

Encapsulated ballasts for use with SON (T) (Plus), HPL, HPI and MH lamps with rated wattages of 1000 W and above

Product data

Operating and Electrical	
Input Voltage	230 V (default) or 240 V
Line Frequency	50 Hz
Input frequency	50 Hz
Wiring	
Connector type	Screw
Mechanical and Housing	
Net Weight (Piece)	9.000 kg
Approval and Application	
Approval marks	CE marking ENEC certificate

Product Data	
Order product name	BHL 1000 L78-A2 230/240V 50Hz HP-207
Full product name	BHL 1000 L78 230/240V 50HZ HP-207
Full EOC	871150006237600
Order code	06237600
Material no. (12 NC)	913700217303
Local order code	BHL1000L78
Numerator – quantity per pack	1
EAN/UPC – Product/Case	8711500996657
Numerator – packs per outer box	1
EAN/UPC – Case	8711500062376

HID-HighPower for SON/MH/HPL/HPI

Dimensional drawing

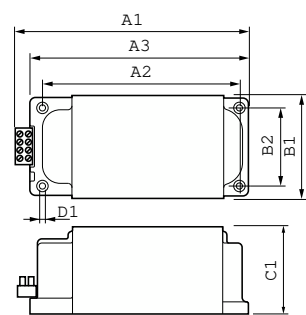

Product	D1	C1	A1	A2	A3	B1	B2
BHL 1000 L78-A2	6.5	102.0	207.0	172.0	196.0	117.0	88.0
230/240V 50Hz	mm	mm	mm	mm	mm	mm	mm
HP-207							

