



HID-HighPower for SON/MH/HPL/HPI

BHL 2000 L76 380/400/415V 50HZ HP-317

Encapsulated ballasts for use with SON (T) (Plus), HPL, HPI and MH lamps with rated wattages of 1000 W and above

Product data

Operating and Electrical	
Input Voltage	380 to 415 V
Line Frequency	50 Hz
Input frequency	50 Hz
Wiring	
Connector type	Screw
Mechanical and Housing	
Net Weight (Piece)	17.000 kg
Approval and Application	
Approval marks	CE marking ENEC certificate

Product Data	
Order product name	BHL 2000 L76-A2 380/400/415V 50Hz HP-317
Full product name	BHL 2000 L76 380/400/415V 50HZ HP-317
Full EOC	871150006384700
Order code	06384700
Material no. (12 NC)	913700217903
Local order code	BHL2000L76
Numerator – quantity per pack	1
EAN/UPC – Product/Case	8711500996664
Numerator – packs per outer box	1
EAN/UPC – Case	8711500063847

HID-HighPower for SON/MH/HPL/HPI

Dimensional drawing

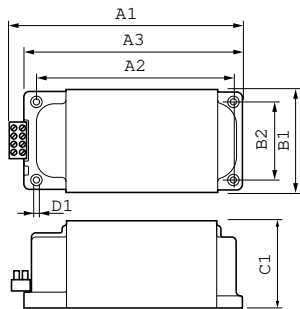

Product	D1	C1	A1	A2	A3	B1	B2
BHL 2000 L76-A2	6.5	102.0	317.0	282.0	306.0	117.0	88.0
380/400/415V 50Hz	mm	mm	mm	mm	mm	mm	mm
HP-317							

