



# PrimaVision Power for CDM

## HID-PV C 150 /S CDM 220-240V 50/60Hz

PrimaVision Power gear is designed for optimal performance of 100 and 150 W CDM lamps – ideal where high-intensity light is key.

### Product data

Operating and Electrical		Net Weight (Piece)	
Input Voltage	220 to 240 V		0.360 kg
Line Frequency	50 to 60 Hz	Approval and Application	
Input frequency	50 to 60 Hz	Approval marks	F-Marking CE marking VDE certificate VDE-EMV certificate CB certificate
Earth leakage current (max.)	0.35 mA	Ambient temperature range	-20°C to 60°C
Inrush current width	.50 ms	Product Data	
Inrush current peak (max.)	50 A	Order product name	HID-PV C 150 /S CDM 220-240V 50/60Hz
Number of products on MCB (16 A type B) (nom.)	6	Full product name	HID-PV C 150 /S CDM 220-240V 50/60Hz
Wiring		Full EOC	871150091052330
Cable length from device to lamp	2.0 m	Order code	913700614066
Connector type	Insert	Material no. (12 NC)	913700614066
Temperature		Local order code	HIDPVC150S
T-case lifetime (nom.)	75 °C	Numerator – quantity per pack	1
T-Case maximum (max.)	85 °C	EAN/UPC – Product/Case	8711500910523
Mechanical and Housing		Numerator – packs per outer box	12
Housing	/S	EAN/UPC - Case	8711500910530

# PrimaVision Power for CDM

## Dimensional drawing

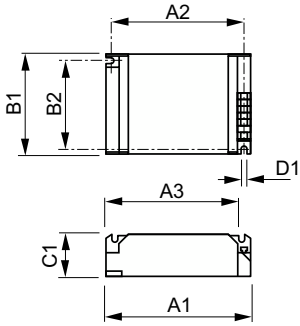

Product	D1	C1	A1	A2	B1	B2
HID-PV C 150 /S CDM 220-240V 50/60Hz	4.8 mm	32.0 mm	135.0 mm	123.5 mm	75.0 mm	63.5 mm

