

DESCRIPTION

The Accord™ redefines fluorescent lighting by improving on aesthetics, comfort and energy savings. The Accord™ provides the right amount of light while eliminating surface shadows commonly found in parabolics. Therefore, Accord™ increases the comfort level while providing significant energy savings.

The Accord™ is the ideal solution for offices, schools, hospitals, retail and other applications.

Catalog #	Type
Project	
Comments	Date
Prepared by	

SPECIFICATION FEATURES

Construction

Shallow 3-1/4" deep housing is die formed of code gauge, prime cold rolled steel. Heavy gauge end plates are securely attached with screws for strength and rigidity and the elimination of gaps. Four auxiliary fixture end suspension points are provided. KOs for continuous row wiring. Large access plate for supply connection.

Electrical*

Ballasts are Class "P" and are positively secured. Rotor-lock lampholders ensure positive lamp retention. UL/CUL listed. Suitable for damp locations.

Ballast Access

Ballast can be removed from below without tools.

Finish

Durable cold rolled steel with multistage, iron phosphate pretreatment and white enamel finish to ensure maximum bonding and rust inhibition.

Reflectors

Reflector has high reflectance baked matte white enamel finish for luminous uniformity.

Shielding

Positively retained frosted acrylic profile lenses provide a soft but effective distribution of light.

Air Return

Optional Air Return model provides air flow through air slots in the housing.



**2AC
BX40**

**COMPACT FLUORESCENT
LAMPS**

2' x 2' Recessed
Troffer Series

accord
Enhanced Lighting Series

powered by
fifthlight
technology

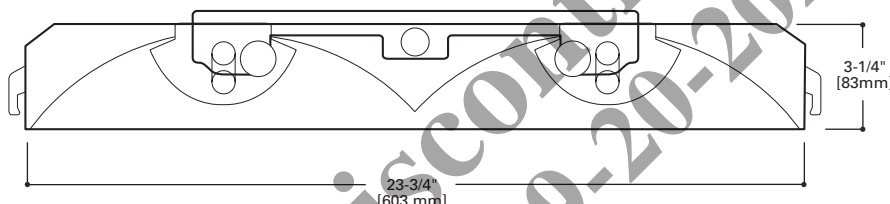

MOUNTING DATA

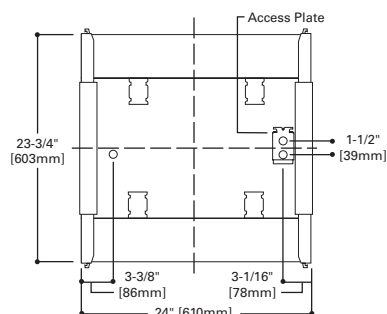

NOTE: 2' x 2' and 2' x 4' allow for row mounting
(1' x 4' does not support feature)

LAMP CONFIGURATION

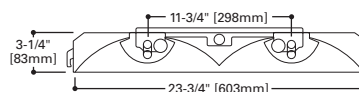

ENERGY DATA

Input Watts:

EB Ballast & STD Lamps @ 120V
2BX40T5 (78)

Luminaire Efficacy Rating

LER = FL56

Catalog Number: 2AC-2BX40

Yearly Cost of 1000 lumens,
3000 hrs at .08 KWH = \$4.28

*Reference the lamp/ballast data in the
Technical Section for specific lamp/
ballast requirements.

**Consult Pre Sales Technical Support.

***See Drywall Frame Kit Accessory

CEILING COMPATIBILITY

G	F	Ceiling	Trim
Grid/Lay-in	Drywall Frame	Type**	Type
Standard	Kit	Exposed Grid	G
		Concealed T	G or T
		Slot Grid	G or T
		Flange	***

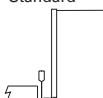

PHOTOMETRICS

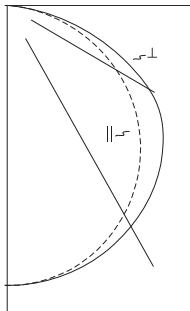
**2AC-2BX40**

Electronic Ballast

(2) F40BX lamps
3000 lumensSpacing criterion:
(||) 1.3 x mounting
height, (⊥) 1.4 x
mounting height

Efficiency 79.6%

Test Report:
241P137

LER = FL-58

Yearly Cost of 1000
lumens, 3000 hrs
at .08 KWH = \$4.28**Candela**

Angle	Along	45°	Across ⊥
0	1558	1558	1558
5	1555	1554	1558
10	1537	1541	1545
15	1508	1516	1526
20	1463	1481	1497
25	1405	1435	1459
30	1336	1380	1415
35	1256	1316	1362
40	1167	1244	1302
45	1068	1162	1232
50	960	1072	1152
55	843	973	1059
60	717	864	926
65	586	743	751
70	449	580	571
75	312	406	391
80	186	237	218
85	81	84	68
90	0	0	0

Coefficients of Utilization

rc	Effective floor cavity reflectance												20%											
	80%				70%				50%				30%				10%				0%			
rw	70	50	30	10	70	50	30	10	50	30	10	50	30	10	50	30	10	50	30	10	0	0	0	0
RCR																								
0	95	95	95	95	93	93	93	93	88	88	88	85	85	85	81	81	81	80						
1	86	82	79	75	84	80	77	74	77	74	72	74	72	70	71	69	68	66						
2	78	71	65	61	76	70	64	60	67	62	58	64	60	57	62	59	56	54						
3	71	62	55	50	69	61	54	49	58	53	48	56	51	48	54	50	47	45						
4	65	55	47	42	63	54	47	41	51	46	41	50	44	40	48	43	40	38						
5	59	49	41	36	57	48	41	35	46	40	35	44	39	35	43	38	34	33						
6	55	44	36	31	53	43	36	31	41	35	30	40	34	30	39	34	30	28						
7	50	39	32	27	49	39	32	27	37	31	27	36	31	27	35	30	26	25						
8	47	36	29	24	46	35	29	24	34	28	24	33	28	24	32	27	24	22						
9	44	33	26	22	43	32	26	22	31	26	21	31	25	21	30	25	21	20						
10	41	30	24	19	40	30	24	19	29	23	19	28	23	19	28	23	19	18						

Zonal Lumen Summary

Zone	Lumens	%Lamp	%Fixture
0-30	1238	19.7	24.7
0-40	2061	32.7	41.1
0-60	3814	60.5	76.0
0-90	5016	79.6	100.0
0-180	5016	79.6	100.0

Luminance Data

Angle in Deg	Average 0-Deg cd/sm	Average 45-Deg cd/sm	Average 90-Deg cd/sm
45	4238	4611	4888
55	4124	4759	5180
65	3890	4933	4986
75	3382	4401	4239
85	2608	2704	2189

ORDERING INFORMATION

SAMPLE NUMBER: 2AC-2BX40-UNV-LB30-EB51-U

Rating Blank= Standard NY=New York Rated ATW-SW4= Chicago Rated	Number of Lamps (Not included) 2=2 Lamp	Shielding Blank=Frosted Acrylic SQP=Lens with Square Pattern Insert RDP=Lens with Round Pattern Insert	Lamps LB30=BiAx Lamp, 40W, 3000K LB35=BiAx Lamp, 40W, 3500K LB41=BiAx Lamp, 40W, 4000K	Ballast Type EB5 =T5 BiAx Electronic Instant Start. Total Harmonic Distortion < 20% No. of Ballast 1, 2 or 3	Packaging U=Unit Pack PALC=Job Pack, in carton
Width 2=2' Width	Wattage (Length) BX40=40W Compact Fluorescent (24")	Voltage⁽¹⁾ UNV=Universal Voltage 120-277		Fifthlight Ballasts⁽²⁾ 5LT5B =T5 BiAx DALI Program Rapid Start. Total Harmonic Distortion < 10%. Ballast Factor 1.0 No. of Ballast 1, 2 or 3	
Series AC=Accord Series		Options GL=Single Element Fuse GM=Double Element Fuse Flex=Flex installed EL=Emergency Installed			
Type A=Air (optional)					

ACCESSORIES

T3A END E.Q. BRACKET PARTS BAG

NOTES: ⁽¹⁾ Products also available in non-US voltages and frequencies for international markets. ⁽²⁾ For a complete listing of Fifthlight Technology products and other solutions from Cooper Lighting Solutions, visit www.cooperlighting.com

Specifications & dimensions subject to change without notice. Consult your Cooper Lighting Solutions Representative for availability and ordering information.

SHIPPING DATA

Catalog No.	Wt.
2AC-2BX40	28 lbs.