

# Mazda Batten

BN007C

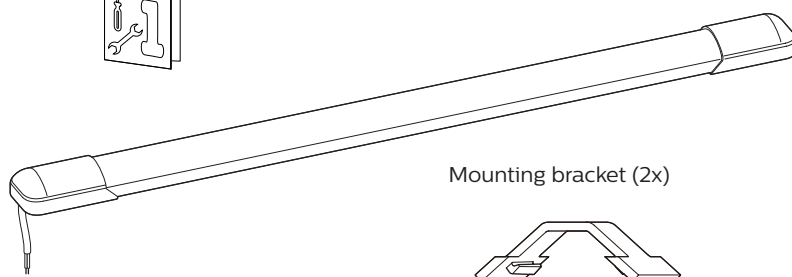

Mounting bracket (2x)

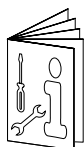

220V  
240V

50Hz  
60Hz



LEDs

IP20



BN007C LED32S/840 L1200

CCT (K)  
4000

P (W)  
32



0.57

Dimensions in mm

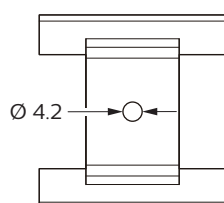

Mounting bracket

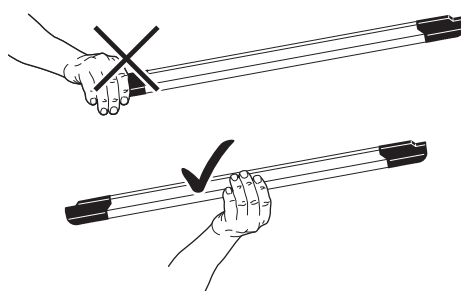
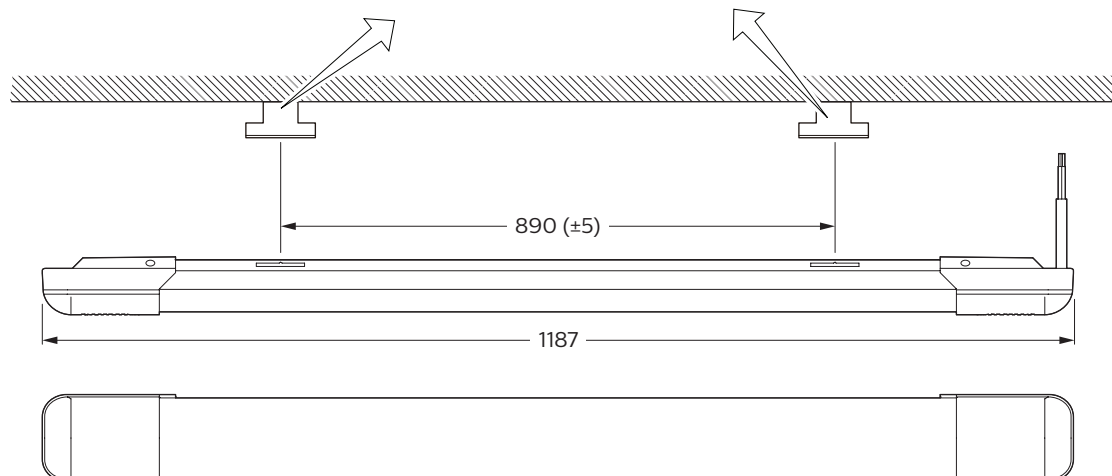

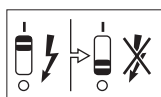

Ø5 x 25  
included

ST 3.5 x 20  
included

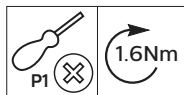

1

## Surface mounting

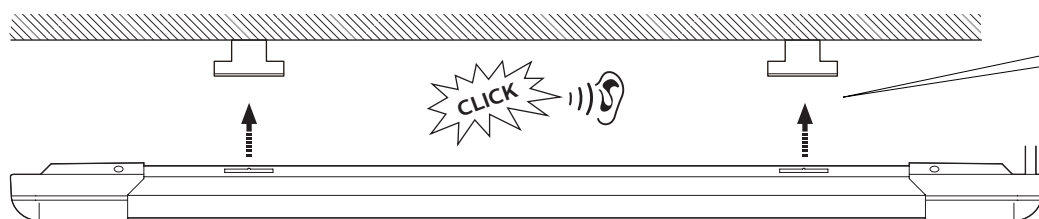

2a

## Suspended mounting

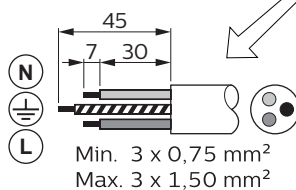
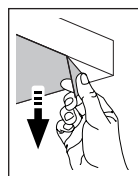
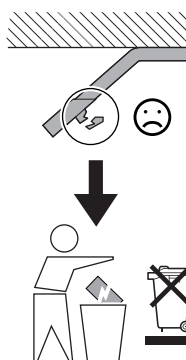
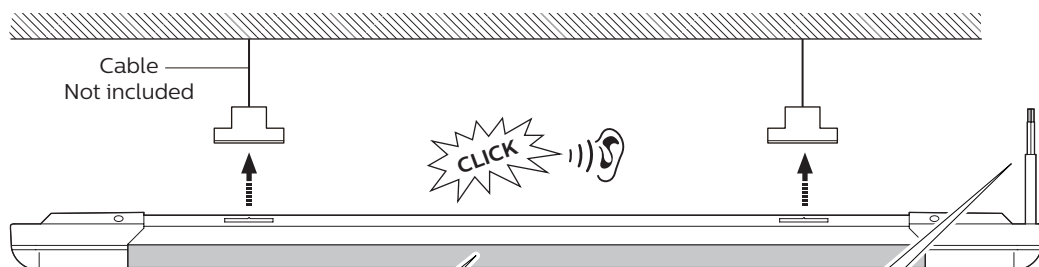

2b



- The luminaire shall be installed by a qualified electrician and wired in accordance with the latest IEE electrical regulations or the national requirements.
- The light source of this luminaire is not replaceable; when the light source reaches its end of life the whole luminaire shall be replaced.
- The external flexible cable or cord of this luminaire cannot be replaced; if the cord is damaged, the luminaire shall be destroyed.



ATTENTION  
OBSERVE PRECAUTIONS  
FOR HANDLING  
ELECTROSTATIC  
SENSITIVE  
DEVICES