

Hong Kong Palace Museum

Hong Kong, China

A cultural institution

Located at West Kowloon Cultural District, the Hong Kong Palace Museum is one of the world's leading cultural institutions committed to the study and appreciation of Chinese art and culture, while advancing dialogue among world civilisations through international partnerships.

The seven-storey Hong Kong Palace Museum features an exhibition space of 7,800m² across nine galleries. It also houses the Auditorium, Activity Rooms and other ancillary facilities, offering spaces for a rich variety of public programmes to foster visitors' interest in arts and culture.



The architect

Rocco Design Architects Associates Ltd – Based around a contemporary interpretation of classic Chinese visual and spatial aesthetics, the museum design builds on a concept of linked courtyards translated into a vertical series of atriums that draw the visitor upwards.

Lighting design

Ove Arup & Partners Hong Kong Ltd – Lighting in galleries plays a fundamental role in how exhibits are experienced by visitors. Arup carefully designed a lighting track and control system, which covers all locations and ensures a precise environment is provided to the artwork, whilst at the same time balancing visual comfort to the visitors.

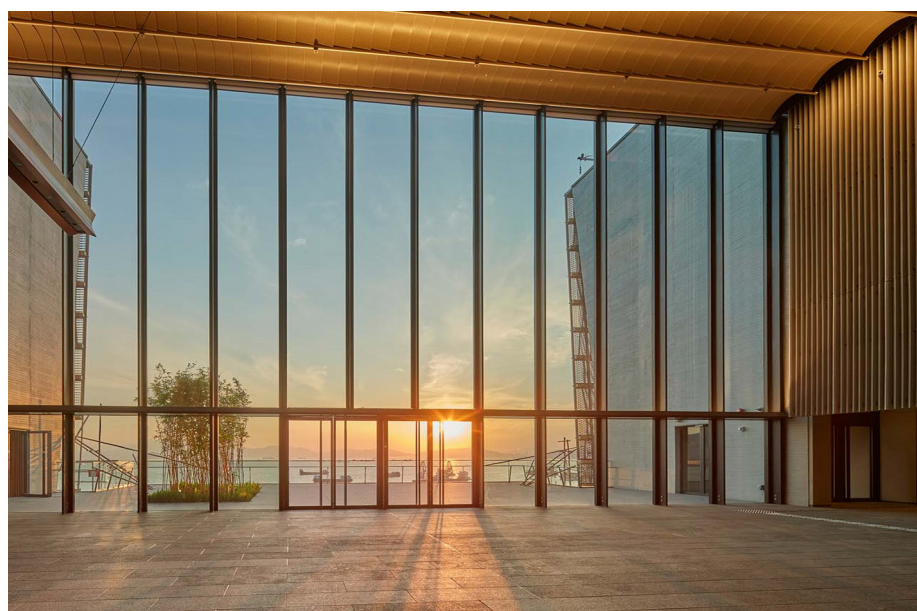

Kenon-controls worked through the lighting control system design with Arup in the design stage.



Project details

Project team
Kenon-controls

Contact details
info@kenon-light.com

Products involved
Philips Dynalite controllers, sensors and user interfaces, System Manager Software