

by § signify

LP904P NC Lightscape White R9003
LP904P NC Lightscape Grey R7043 30%

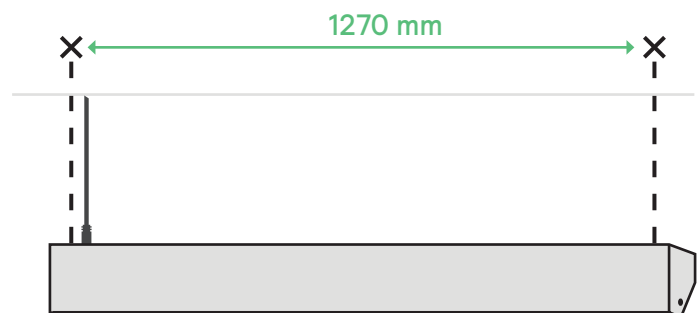

	Power (W)	Dimensions LxWxH (mm)	EU Energy class of the light source	 kg
Lightscape	104	1350 x 120 x 150	G	10

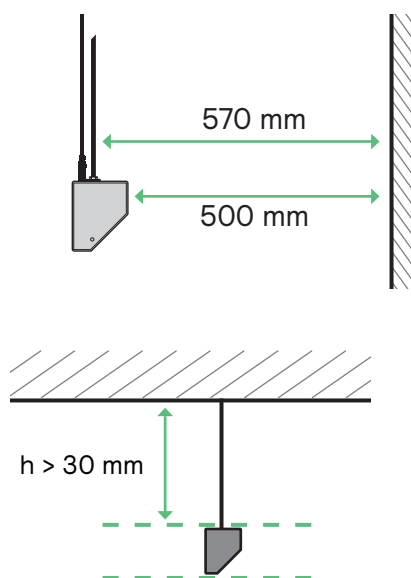
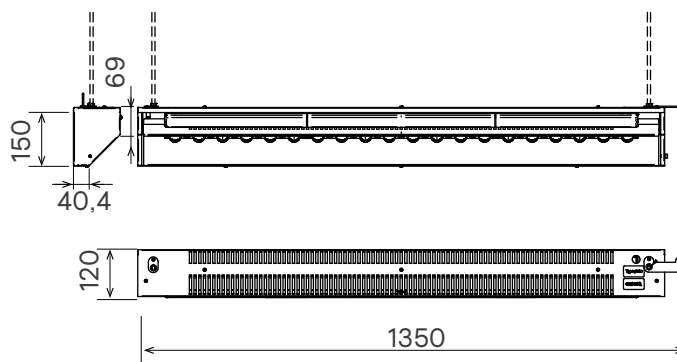

Use M8 Class 8.8 threaded rods (not included)

For more detailed mounting instruction, please consult your Signify representative for the NatureConnect system installation manual.

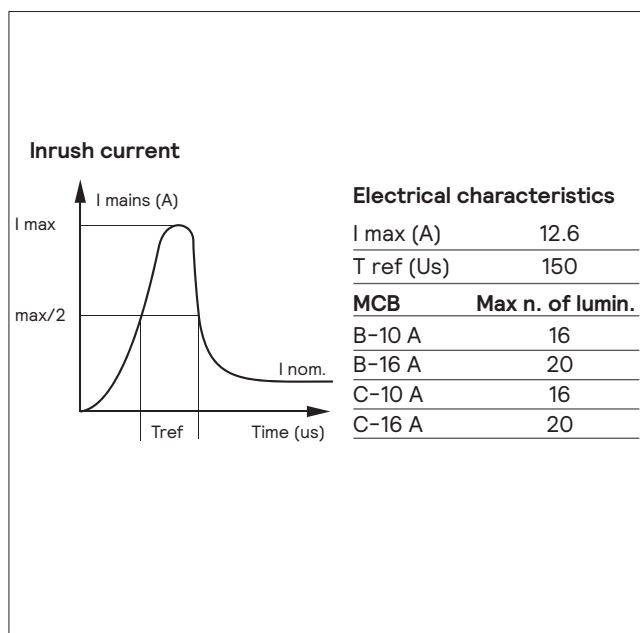
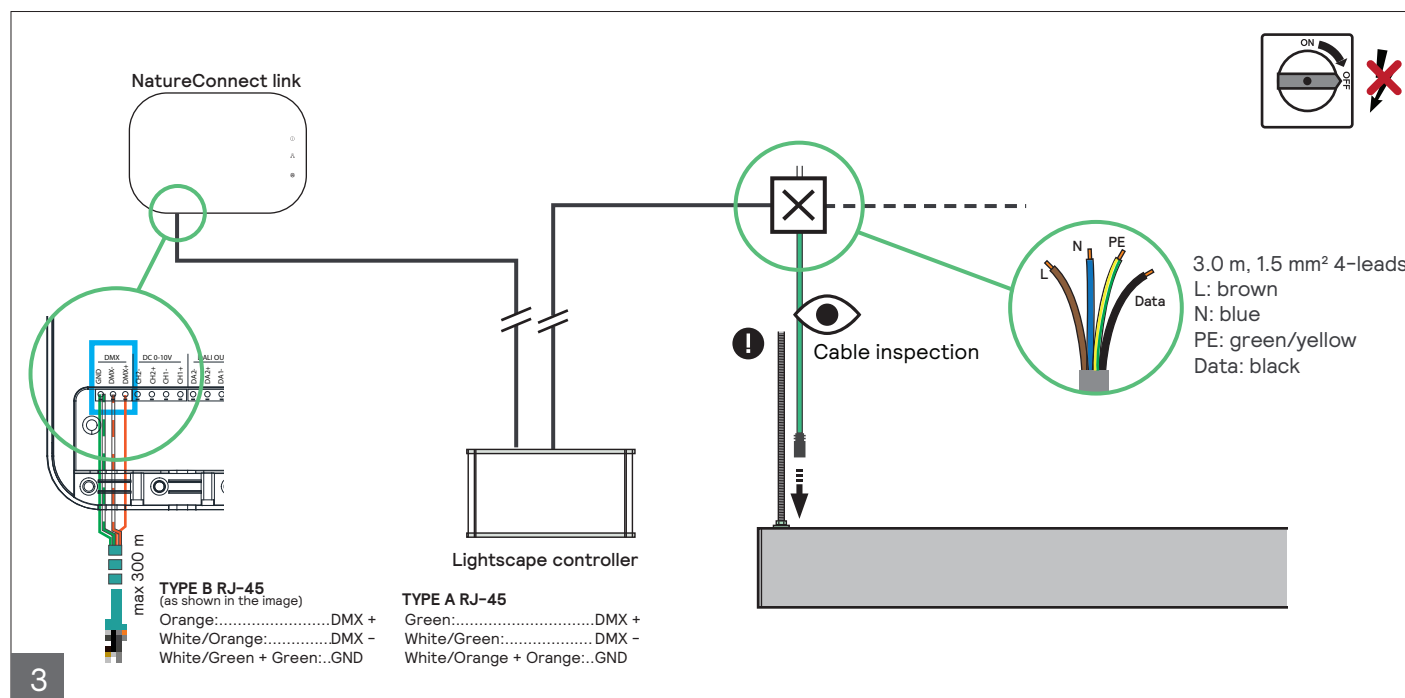
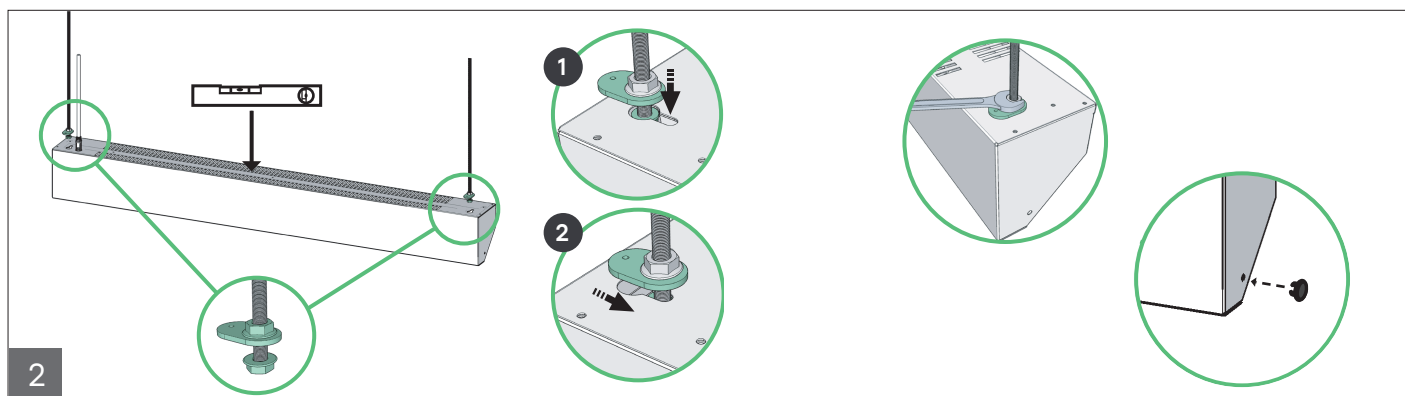

- ! ATTENTION**
OBSERVE PRECAUTIONS
FOR HANDLING
ELECTROSTATIC
SENSITIVE
DEVICES
- The luminaire shall be installed by a qualified electrician and wired in accordance with the latest IEE electrical regulations or the national requirements.
 - The light source of this luminaire is not replaceable; when the light source reached its end of life the whole luminaire shall be replaced.
 - If the external flexible cable or cord of this luminaire is damaged, it shall be exclusively replaced by the manufacturer, his service agent or similar qualified person in order to avoid hazard.
 - During installation or maintaining the luminaire please use gloves to avoid spots on the cover.
 - To remove dust and spots use the following:
 - Dust: use micro fiber cloths only
 - Fingerprints, etc.: use a cleaner for synthetic materials with antistatic properties.
 - The product is IPX0 & as such is not protected against water ingress & as such we strongly recommend that the environment in which the luminaire is to be installed is suitably checked.
 - If the above advice is not taken and the luminaires are subject to water ingress, Signify cannot guarantee safe failure & product warranty will become void.

© 2023 Signify Holding.

All rights reserved. The information provided herein is subject to change, without notice. Signify does not give any representation or warranty as to the accuracy or completeness of the information included herein and shall not be liable for any action in reliance thereon. The information presented in this document is not intended as any commercial offer and does not form part of any quotation or contract, unless otherwise agreed by Signify. All trademarks are owned by Signify Holding or their respective owners.