

Signify  
NatureConnect

NatureConnect  
daylight W120L120

LP911P NC2 DAYLIGHT W120L120



4x

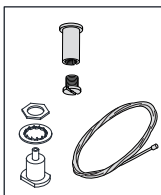

1x

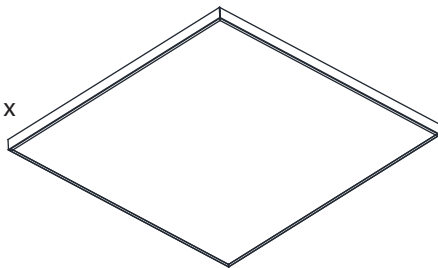

220V  
240V

50Hz  
60Hz



IK02



Ta  
35 °C



NatureConnect daylight W120L120

Power

113 W

Current

0.48 A

Dimensions  
LxWxH

1195x1195x85 mm



23 kg

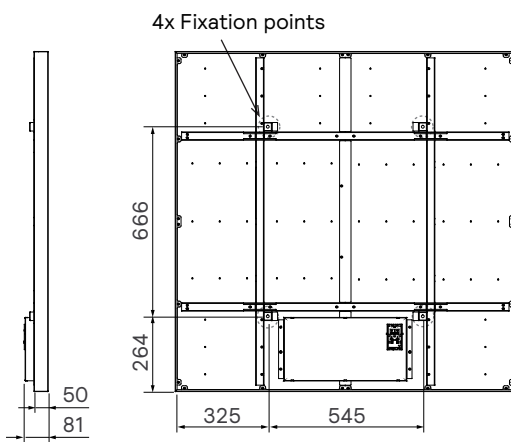
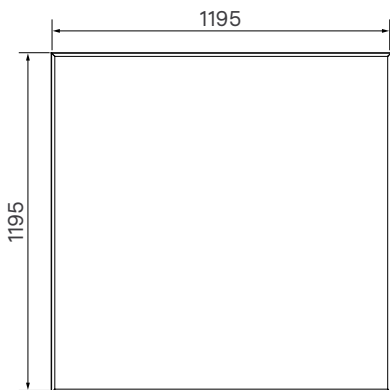

### Three installation methods:

a. Suspended recessed

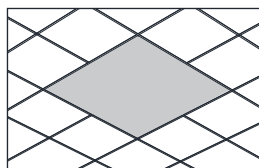

Always use gloves when installing luminaire.



b. Suspended surface mounted

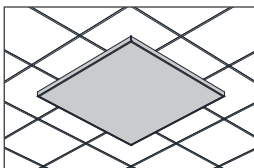

Do not put any pressure on the lens plate.

c. Suspended open ceiling

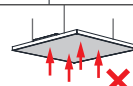
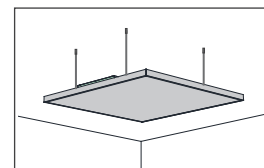



Fix the four steel cables to the ceiling according to the orientation of the luminaire

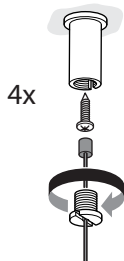

Install 4 grippers to the luminaire

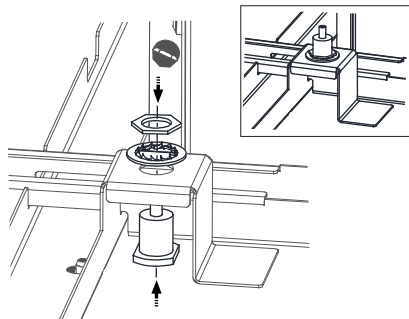

1

2

Lift and suspend NatureConnect mini island to the required height.

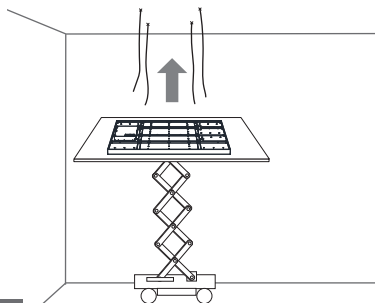

3

Insert the suspension cables in the four cable grippers

4x

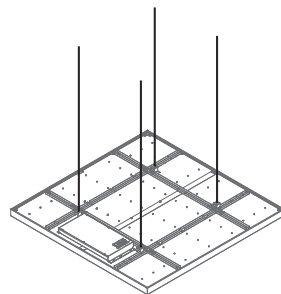
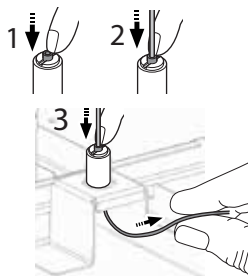

4



When pulling up the luminaire, keep the steel wire and the gripper in a straight line. No tilting of the luminaire.

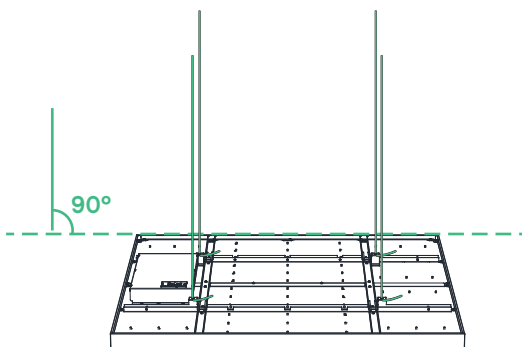

### Suspended recessed in system ceiling

2x2 tiles (600x600 mm) opening in the ceiling



6a

### Insert the luminaire through the opening

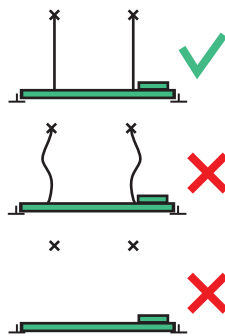
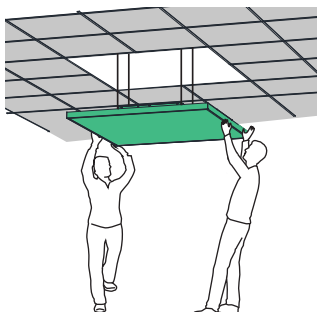

7a

! No mechanical load on the ceiling

### Suspended surface mounted in system ceiling (600 x 600 mm)

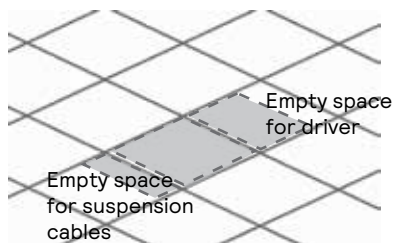

6b

### Insert the middle part of the luminaire in the opening.

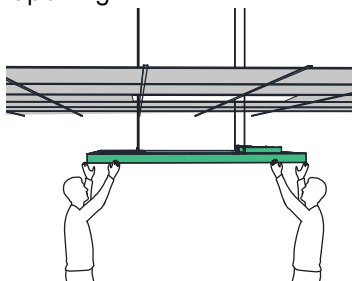

7b



### Suspended open ceiling

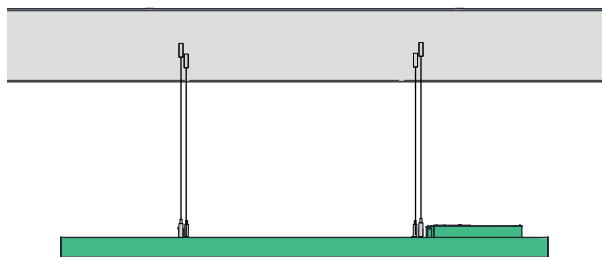

6c

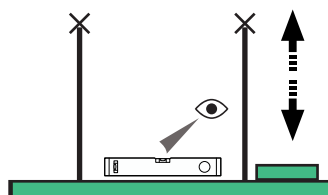



## Connection to mains and DALI

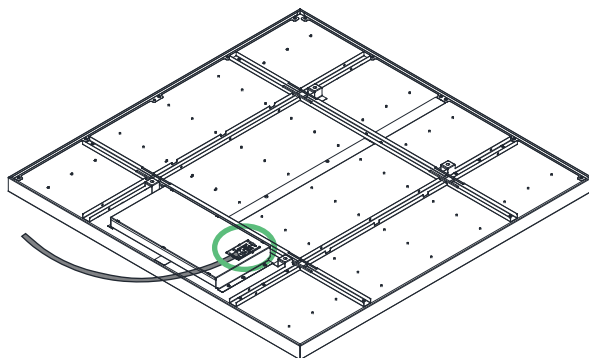
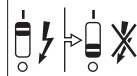

1

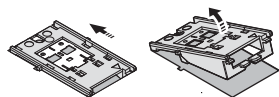

2

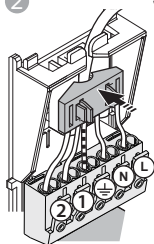

5 x 0.75 - 1.0 mm<sup>2</sup>

② ①  $\overline{\text{N}}$  L

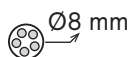
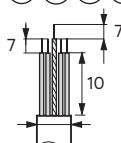

3

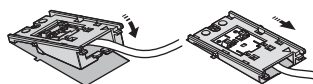

7

## Inrush current

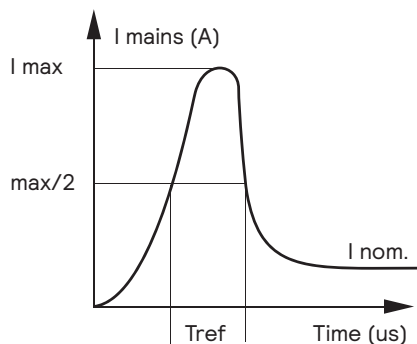

## Electrical characteristics

I max (A)	50
T ref (Us)	330
MCB	Max n. of lumin.
B-10 A	3
B-16 A	6
C-10 A	6
C-16 A	10



- Read these SAFETY PRECAUTIONS carefully. Strictly follow them during the installation work to protect yourself.
- Installation work must be performed by skilled persons. Improper or incompetent execution may cause injury, e.g. due to overturn of the luminaire.
- The luminaire shall be installed by a qualified electrician and wired in accordance with the latest IEE electrical regulations or the national electrical code.
- Make sure that the mains voltage is disconnected before installing or servicing the luminaire to avoid any risk of electric shock.
- Mounting of the luminaire is only allowed in ceilings that can support the weight of the luminaire (30kg).
- Install the luminaire correctly according to the instructions in this manual. Wrong installation may cause injury due to the luminaire falling or may result in electric shock or fire hazard.
- Only use the original accessory parts inside the box.
- The product is partially IPX0 & as such it is not protected against water ingress & as such we strongly recommend to check the conditions of the environment in which the luminaire is being installed.
- If the above advice is not taken and the luminaire is subject to water ingress, warranty will become void.
- Always consult the manufacturer for repair or service. Do not repair the luminaire by yourself.
- During installation and maintenance please use gloves to avoid spots on the cover.
- To remove dust and spots use the following:
  - Dust: use micro fiber cloths only
  - Fingerprints, etc.: use a cleaner for synthetic materials with antistatic properties.
- The luminaire has basic insulation between the mains voltage (L-N) and the control conductors (DALI).



- The luminaire shall, under no circumstance, be covered with thermal insulation matting or similar material.

Use QR code to download Commissioning guide for Interact PRF and other information about NatureConnect.



<https://www.signify.com/global/innovation/natureconnect/download-assets>

## INFORMATION ON MINIMUM CLEARANCE DISTANCES (for Australia and New Zealand)

NatureConnect LP911P NC2 DAYLIGHT W120L120 is a Do-Not-Cover luminaire type.

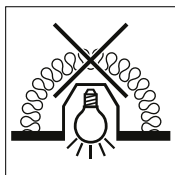

Please note the following warnings for recessed application:

- **Australia and New Zealand**

**WARNING — RISK OF OVERHEATING OR FIRE IF THE CLEARANCE DISTANCES ARE COMPROMISED.**

Abbreviations (clearances):

1. HCB (Height clearance to building element)  
Minimum distance as specified by the luminaire manufacturer between the top of the recessed luminaire and any building element above it.
2. MIC (Minimum insulation clearance)  
Minimum distance as specified by the luminaire manufacturer between the top of the recessed luminaire and the building insulation above it.
3. SCB (Side clearance to building element)  
Minimum distance between the side of the recessed luminaire and any building element as specified in AS/NZS 3000, or as specified by the luminaire manufacturer.
4. SCI (Side clearance to insulation)  
Minimum distance as specified by the luminaire manufacturer between the recessed luminaire and any building insulation.

Minimum clearances requirements for LP911P NC2 DAYLIGHT W120L120 luminaire:

**RISK OF FIRE — BUILDING INSULATION MUST NOT COVER  
THIS LUMINAIRE**

HCB = 0 mm MIC = 10 mm SCB = 0 mm SCI = 0 mm

- **New Zealand (additional)**

WARNING — THIS LUMINAIRE IS NOT SUITABLE FOR INSTALLATION IN LOCATIONS WHERE THERMAL INSULATION IS PRESENT, OR MAY REASONABLY BE EXPECTED TO BE INSTALLED IN THE FUTURE, OR WHERE THERE IS A LIKELIHOOD OF OTHER COMBUSTIBLE MATERIAL, E.G. LEAVES OR VERMIN DEBRIS, ETC. COLLECTING ON OR AROUND THE LUMINAIRE. IT IS NOT SUITABLE FOR DOMESTIC INSTALLATIONS OR INSTALLATION IN RESIDENTIAL AREAS OF NON-DOMESTIC INSTALLATIONS (RESIDENTIAL INSTITUTIONS, HOTELS, BOARDING HOUSES, HOSPITALS, ACCOMMODATION HOUSES, MOTELS, HOSTELS AND THE LIKE).

© 2025 Signify Holding.

All rights reserved. The information provided herein is subject to change, without notice. Signify does not give any representation or warranty as to the accuracy or completeness of the information included herein and shall not be liable for any action in reliance thereon. The information presented in this document is not intended as any commercial offer and does not form part of any quotation or contract, unless otherwise agreed by Signify.

All trademarks are owned by Signify Holding or their respective owners.