



Signify

OptiVision LED gen3.5  
Lighting that is a winner  
for everyone

# Contents

1. Meet OptiVision LED gen 3.5
2. Product overview
3. Service tag
4. Dimensional drawings
5. Product specifications



# Sports are evolving – and so are we!

- Decades of experience and expertise in recreational sports lighting
- A rich portfolio of products, offering superb quality of light
- Wide range of systems and services
- Sustainable and future-proof solutions
- A single source partner for a totally integrated, intelligent lighting offer – from concept to completion – backed up by exceptional levels of after-sales care

# OptiVision LED gen3.5



**BVP528**



**BVP518**



**EVP500  
DALI Driver**

# Driving differentiation – OptiVision LED gen3.5

Higher flux leading to lower quantities, total weight of installation and TCO

Inbuilt tilt of 5° of housing leading to lower tilt and SCx values

Simplified internal wiring from LED board to connection box

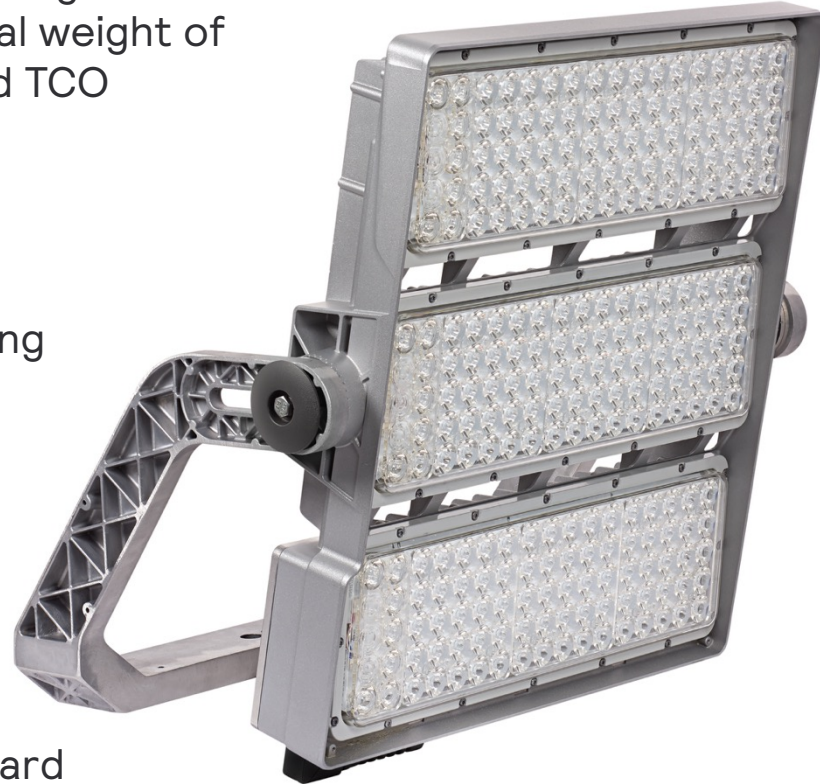

Source lumen output:

- CRI70, CCT 5700K: up to 220k lm
- CRI70, CCT 4000K: up to 220k lm
- CRI70, CCT 3000K: up to 207k lm

Single piece die cast housing with integrated connection box and self retaining screws

Both symmetric and asymmetric optics for better comfort and low glare for lower mounting height

# Dare to be different – OptiVision LED gen3.5



**Flexibility**

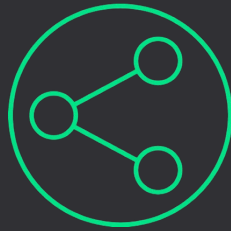

**Iconic design**



**Efficiency**



**Future-proof**



**Easy to install  
and maintain**

# Flexibility

- A wide choice of dedicated optics and beams (asymmetrical and symmetrical) ensures optimal solutions
- Improved uniformity and efficiency
- Excellent spill light control

# Iconic design

- DALI angle piece PDC housing
- Connection box integrated in housing
- Simple single cable wiring between housing and driver
- IP66 protection for housing and driver
- Better durability due to die cast ear caps
- IP66 protection against dust and water for both housing and driver

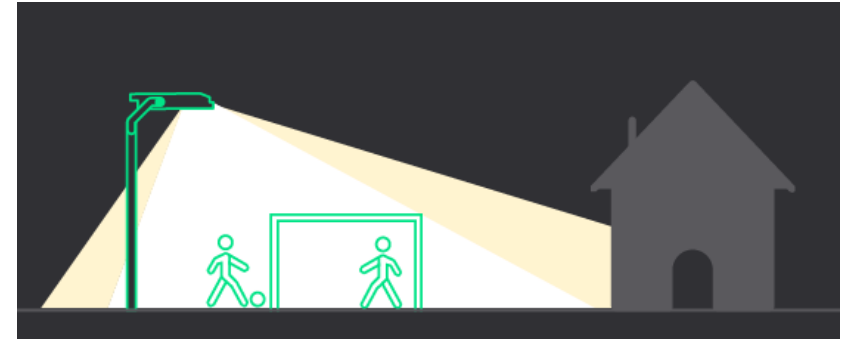

Without spill light control



With spill light control

# High level of efficiency

- Provides maximum light output with two housing choice for different sports application, while ensuring effective thermal management
- CLO option to optimize on power consumption over lifetime.
- Optimized on different max. lumen pack for different ambient temperature to minimize TCO
- Ideal 1:1 replacement for existing conventional lighting
- Excellent spill light control options with louvers
- Zero tilt optics with limited glare and upward leakage of light, which benefits local residential areas at night





## Future proof

- DALI driver box enables connectivity to control system
- The combination of controls and new features leads to significant energy savings (up to 65%)

## Easy to install and maintain

- No wiring complexity between driver box and luminaire
- Service tag : CLASS A serviceability
- Long lasting LEDs, thermal management system, reliable IP66 driver box all lead to minimized maintenance costs

# Interact for smart lighting

With Interact, it's easier than ever to realize the benefits of smart lighting: higher energy savings, improved space utilization, greater well-being and employee productivity – and a big step towards achieving sustainability goals.

## General benefits

- No additional (DALI) control wires needed
- Perfect for projects of any size
- Quick to install and ready to use in a few clicks

## Sustainable

- Sensor-enabled motion and daylight harvesting for instant energy savings
- Interact is part of our lighting for circularity offer

## Smart

- Benefit from remote control and monitoring and reporting capabilities
- Use data to make better informed decisions more quickly

## Efficient

- Collect actionable space analysis data
- Be informed of issues to enable timely and cost-efficient maintenance

[Discover Interact for sports](#)

[Discover Interact for area lighting](#)

This is all you need for your smart lighting system



OptiVision LED gen3.5  
with integrated sensor



Software applications

# Signify Service tag

- A unique QR code-based LED luminaire asset identification system
- Providing detailed information on specification and spare parts, simply by scanning the code on the packaging or luminaire with the Signify Service tag app.
- The system simplifies the installation and maintenance of lighting infrastructure by utilizing cloud technology.
- Service tag also plays a key role in the circular design of our lighting solutions, as it extends their service life and reduces maintenance efforts, ensuring efficient servicing and avoiding waste.



## Your benefits at a glance:



Easy installation  
and commissioning



Simplified  
maintenance



Asset  
management

Learn more at [signify.com/global/service-tag](https://www.signify.com/global/service-tag)

# Signify Service tag: Installation



## #1. Download the app

Download the Service tag app from the App store or Play store on your mobile device (iOS or Android).



## #2. Register the luminaire

Register the luminaire by simply scanning the QR code on the packaging or luminaire. The system automatically identifies the type of each luminaire.



## #3. Create a group QR code

If you have multiple luminaires, it's possible to use the Service tag app to combine individual luminaires into a group. Each group will have its own unique group QR code.



## #4. Luminaire information

Scan the QR code on your luminaire for easy access to the installation manual.

# Maintenance

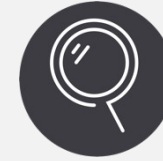

## #1. Spare parts identification

Use the Service tag app to view a luminaire's spare parts, which contains all necessary information for quick ordering.



## #2. Spare parts programming

Quickly program a spare driver using the Service tag app—without needing a faulty driver on hand. Scan the QR code of a luminaire with your device, put your mobile device on the spare driver, press “Program” and the spare driver receives the right settings for this specific luminaire.



Learn more at  
[signify.com/global/service-tag](https://signify.com/global/service-tag)

©ignify

©signify

# Product specifications

# Dimensional drawings

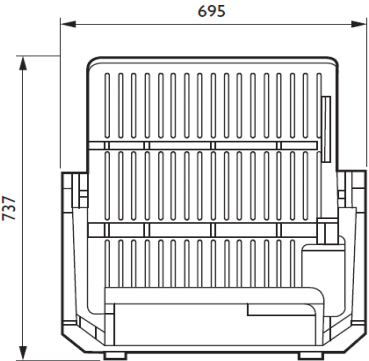

BVP528

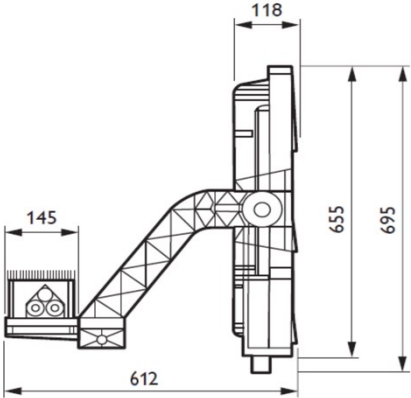

HGB

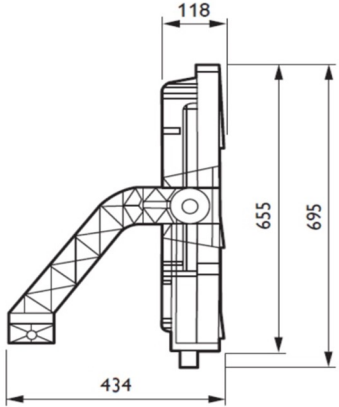

BV

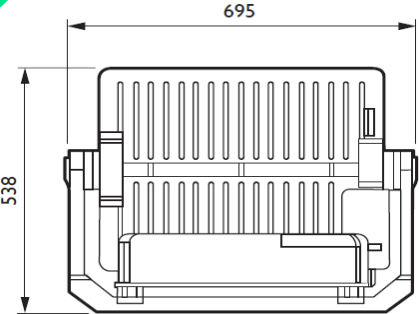

BVP518

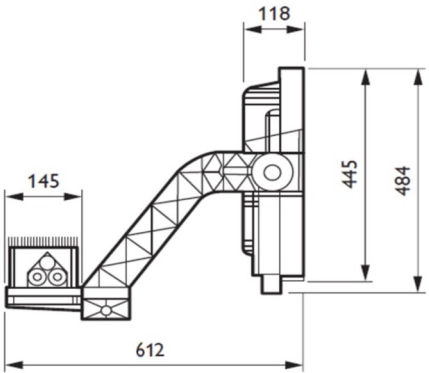

HGB

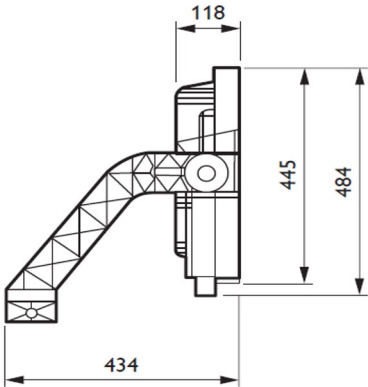

BV

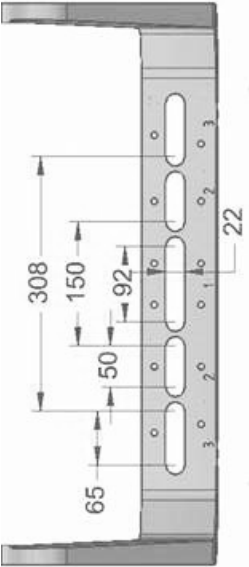

# Product specifications

Luminaire types	BVP518 (2 LED Engines) / BVP528 (3 LED Engines)
Luminaire versions	BV: Basic Version (separate driver box) HGB: Housing Gear Box (driver box pre-fitted on the mounting bracket) in a Box
Driver box type	EVP500 (DALI version)
Source light flux (Ta dependent)	<ul style="list-style-type: none"> <li>Up to 220,000 lm (BVP528; CCT 5700, CRI 70)</li> <li>Up to 220,000 lm (BVP528; CCT 4000, CRI 70)</li> <li>Up to 207,000 lm (BVP528; CCT 3000, CRI 70)</li> <li>Up to 148,000 lm (BVP518; CCT 5700, CRI 70)</li> <li>Up to 148,000 lm (BVP518; CCT 4000, CRI 70)</li> <li>Up to 138,000 lm (BVP518; CCT 3000, CRI 70)</li> <li>(tolerances on light flux: +/- 7%)</li> </ul>
System power	Up to 1500 W (BVP528) / Up to 1000 W (BVP518) (tolerances on system power: +/- 10%)
Luminaire efficacy	Up to 145 lm/W (depends on floodlight's Ta dependent version, CCT and CRI)
Correlated Color Temp. (CCT)	Cool White (CW) 5700 K / Natural White (NW) 4000 K / Warm White 3000 K (WW) (tolerances on CCT: +/-400 K)
Color Rendering Index (CRI)	min: 70

TLCI per color code	49 (757) / 48 (740)
SDCM (MacAdam ellipse)	< 5
Light distributions / optics	4 Rotational Symmetrical beam optics from 2 x 11° to 2 x 19° / 14 Asymmetrical optics Narrow to Extra Wide Beam
Operating temperature range	-40°C up to +45°C (depends on floodlight's Ta dependent version)
Electrical insulation class	Class I
Degree of Ingress Protection	IP66
Luminaire dimensions (L x W x H)	737 x 695 x 128 mm (BVP528) / 538 x 695 x 118 mm (BVP518)
Driver box dimensions (L x W x H)	500 x 145 x 120 mm



BVP528



EVP500  
DALI Driver



BVP518

# Product specifications

Luminaire weight	BVP518 (BV): 22 kg BVP518 (HGB): 29 kg BVP528 (BV): 26,5 kg BVP528 (HGB): 33 kg (tolerances on weight: +/- 10%)
Driver box weight	6.3 kg
Luminaire windage area (SCx)	BVP518 (BV: 0.10 - 0.34) (HGB: 0.18 - 0.33) BVP528 (BV: 0.12 - 0.48) (HGB: 0.20 - 0.47) Tilt between 0° - 90°
Material / Finishing	<ul style="list-style-type: none"> <li>Housing/ Electrical connection box / Mounting bracket: PDC Molded aluminum</li> <li>End caps: PDC Aluminum in GREY color</li> <li>Plastics / Cables: UV protected</li> <li>Standard Raw aluminum color. Optional Dark grey RAL 10714 for Housing, Bracket and Front Face</li> <li>Driver box is always painted in raw aluminum color (other paint colors are not possible)</li> </ul>
Driver box mains input	230-400V/50-60Hz (tolerances on mains supply voltage fluctuations: +/- 10%) (some limitation of light flux versions for BVP528 / BVP518 floodlight if used at 220V)

Driver box installation	<ul style="list-style-type: none"> <li>Indoor/outdoor open air without need of cabinet or inside electrical cabinet (IP54) or inside electrical room or inside mast (min. entrance door opening 125 x 600 mm)</li> <li>Either pre-fitted on the luminaire (HGB version) or remotely at max 200 m distance to luminaire</li> <li>Fixation on flat surface by means 4 standard screws/bolts thru the key slot holes</li> <li>Universal fixation position (cable glands never upward for outdoor)</li> </ul>
Luminaire electrical connection / Cabling	<ul style="list-style-type: none"> <li>Luminaires are always supplied with electrical connection box pre-fixed enabling wiring between floodlight and driver box</li> <li>Cable entry via 1xM25 cable gland accepting cable diameter between 13 and 18 mm and wiring with screw-less terminals for wires up to 2.5mm<sup>2</sup></li> </ul>
Driver box electrical connection / Cabling	<ul style="list-style-type: none"> <li>Mains input: Screw-less terminals for wires up to 4mm<sup>2</sup>/ Cable entry via 1xM25 cable gland accepting cable diameter between 13 and 18 mm (no thru-wiring in/out)</li> <li>Output to luminaire: Screw-less terminals for wires up to 2.5mm<sup>2</sup>/ Cable entry via 1xM25 cable gland accepting cable diameter between 13 and 18 mm</li> <li>Cable to luminaire (BV version luminaire): One cable of 7-core (8-core for distance &gt; 50m) at length of customer choice (cables are not supplied with the product)</li> </ul>

# Product specifications

Inrush current	20 A during 160 $\mu$ s at 230 V mains 30 A during 160 $\mu$ s at 400 V mains
Power factor	> 0.95 at full power
Surge protection	10 kV standard (driver integral)
Life-time / Lumen maintenance	L80B50: up to 100000 hours
Driver box lifetime / Failure rate	50,000 hours at operation temperature range 0.5% per 5000 hours
Luminaire installation	<ul style="list-style-type: none"> <li>Outdoor: on mast-head frame/wall/catwalk or Indoor: on roof or ceiling/wall or catwalk</li> <li>U-shaped mounting bracket with foot-print suitable for 3-point fixation by means of M20 bolts</li> <li>Vertical aiming from the horizontal: <math>-90^{\circ}</math> / <math>+90^{\circ}</math> (not suitable for uplighting)</li> <li>Standing-up or hanging-down mounting (not for HGB version, Refer Mounting Instruction sheet for options)</li> </ul>

Integral dimming controls	Dynadimmer in three options DDF1, DDF2, DDF3 (factory preset)
DALI control interface	Screw-less terminals suitable wires up to 2.5 mm <sup>2</sup> / Cable entry via 1xM20 cable gland accepting cable diameter between 10 and 14 mm (no thru-wiring in/out)
Luminaire accessories	External spill-light control louvre, Precision Aiming Device (Optional)
Optional versions	CLO / Integral spill-light control louvre or control plate for asymmetrical beam optics (LO, BL or LT) / Indoor swimming pool protected (SWP) / Marine salt protected (MSP)
Certification / Listing	CE, ENEC, VDE-Ball proof
Packaging content	Contains floodlight and driver box either pre-fitted (HGB) or separate (BV). Driver box of BV version contains a suspension kit with its fixing parts

# You and Signify – a reliable partnership

Signify is the world leader in connected LED lighting systems, software and services. We proudly bring to market the best lighting brands in the world, including Signify, Philips and Interact.

We believe in close cooperation before, during, and after every project. Our local teams provide the support and information you need—with flexible, on-time delivery and reliable product availability.

To help you stay ahead, the [Signify Lighting Academy](#) offers a comprehensive range of educational resources to grow your expertise and earn certification.

Get more info on our products, services and tools:

[signify.com/installer](https://www.signify.com/installer)

[signify.com/specifier](https://www.signify.com/specifier)

## Our global brands

 Signify

Signify represents our commitment to sustainable innovation. As our leading brand for connected lighting systems, luminaires and components for the specification project business, Signify solutions serve the segments where we collaborate most closely with our customers.

 Signify interact

Signify Interact is our IoT software platform for managing smart lighting systems and unlocking the value of the data they collect. Easy to install and configure, Interact supports a wide range of applications—from small offices to entire cities.

**PHILIPS**

Philips stands for quality and energy efficiency in lighting. It is our leading brand for innovative, off-the-shelf lighting products for professionals and consumers alike.

# Get into pole position with high-performance, energy-efficient LED



Signify is Official Lighting Partner of  
Mercedes-AMG PETRONAS F1 Team

Official Lighting Partner

 Signify



 AMG  
PETRONAS  
FORMULA ONE TEAM

**@signify**

the meaning of light