



Quick installation guide

Philips LED tubes

LED tubes provide the fastest and simplest way to convert existing luminaires to LED technology. The installation is 100% safe and totally unproblematic, due to lamp-for-lamp replacement.

Use our quick guides below for instant guidance on how to install a LED tube on which existing ballast.

Which type of LED tube do you need?

T8

← or →

T5

Choose the correct installation guide according to the ballast type below.

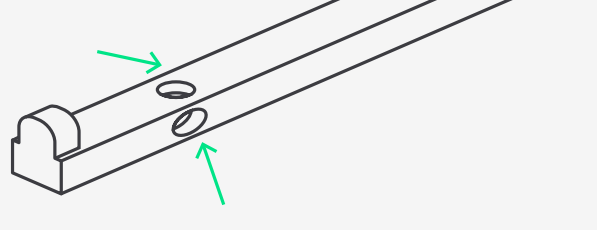

Does your luminaire have a starter?

Yes

No

T8

Installation instructions for Electro-magnetic Ballast (EM)

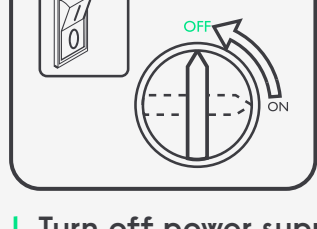

1. Turn off power supply

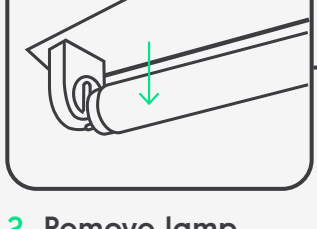

2. Remove lamp

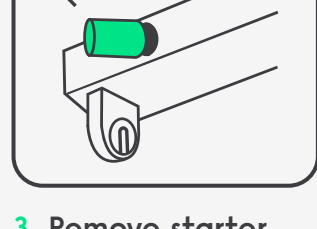

3. Remove starter

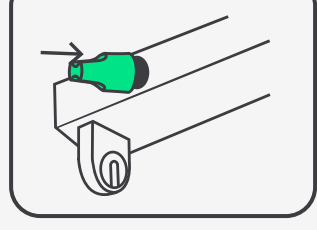

4. Install LED starter

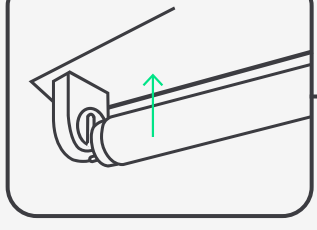

5. Install LED tube (T8; EM/Mains or UN) with light opening facing downwards

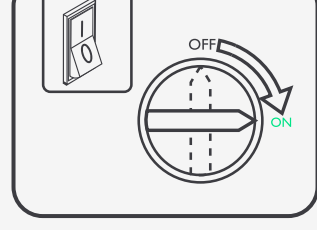

6. Turn on power supply

T8

T5

Installation instructions for High-frequency Electronic Ballast (HF)

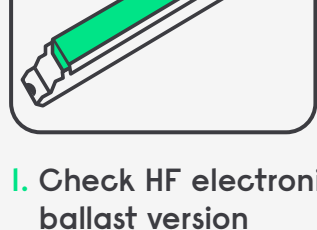

1. Check HF electronic ballast version

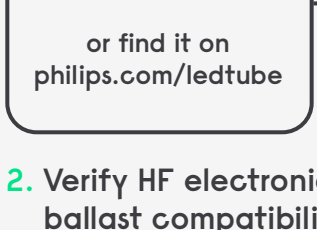

2. Verify HF electronic ballast compatibility



3. Turn off power supply

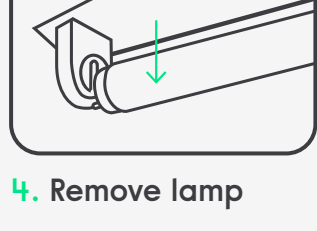

4. Remove lamp

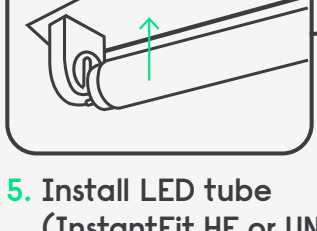

5. Install LED tube (InstantFit HF or UN) with light opening facing downwards

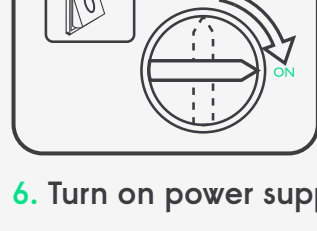

6. Turn on power supply

T8

T5

Installation instructions for direct mains connection

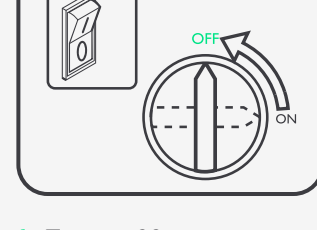

1. Turn off power supply

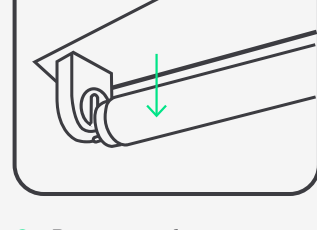

2. Remove lamp

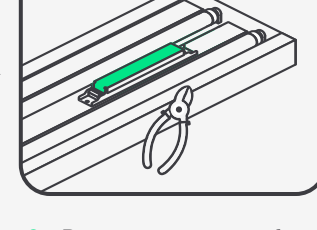

3. Remove cover to expose ballast

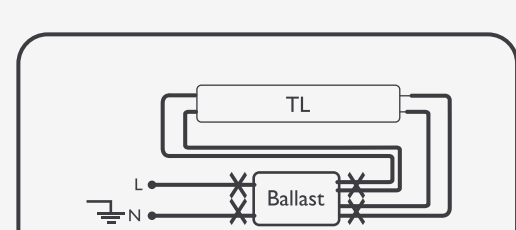

4. Cut wires and remove ballast

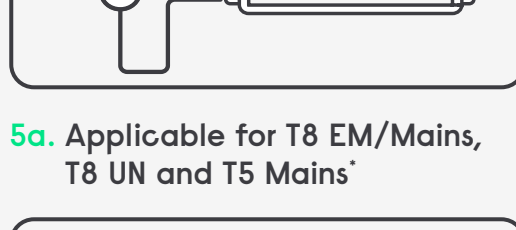

5a. Applicable for T8 EM/Mains, T8 UN and T5 Mains*

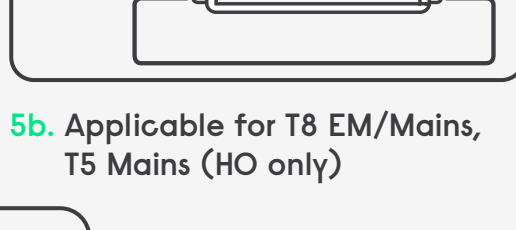

5b. Applicable for T8 EM/Mains, T5 Mains (HO only)

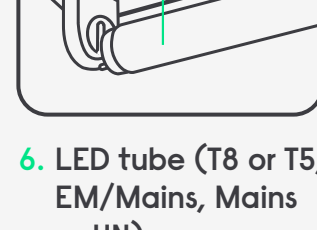

6. LED tube (T8 or T5; EM/Mains, Mains or UN)



7. Turn on power supply

*This method is not permitted in Switzerland

There's a Philips LED tube for every application

PHILIPS



Simplicity and ultra-efficiency make Philips LED tubes the quickest and easiest way to upgrade to LED for immediate energy savings over a long and reliable lifetime.

Finding the right LED tubes for different plans, needs and budgets is easy with the extensive Philips portfolio. It ensures that you always have a quality solution at the price you want.

philips.com/ledtube

Pro tip for choosing a Philips LED tube: Watch out for the rings!

T8



One ring: EM/Mains (Electro-magnetic ballast or direct mains)

T8



Two rings: HF (High-frequency Electronic ballast)

T8



Three rings: UN (Universal)

T5



No ring/one ring: Mains (Electro-magnetic ballast or direct mains)

T5



Two rings: HF (High-frequency Electronic ballast)

Find everything you need to work faster, better, and smoother on signify.com/installers