

ECOLINK

ECO-E3/MT-BKD

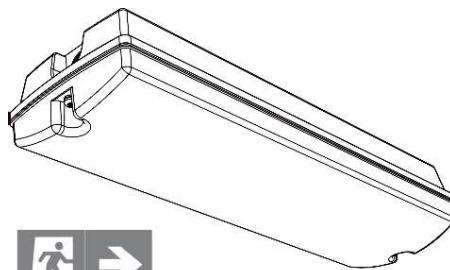

legend



220V
240V

50Hz
60Hz



LEDs

IP65

GLOW
WIRE
650 °C

Max.
45 °C
Min.
0 °C



	Test	CCT (K)	Lumen (lm)	P (W)	
ECOLINK EM BULKHEAD 3HR MANUAL IP65	manual	6500	150	3	0.63

Dimensions in mm

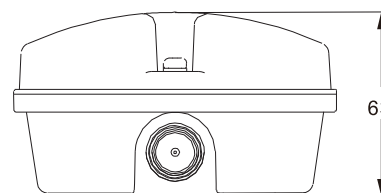
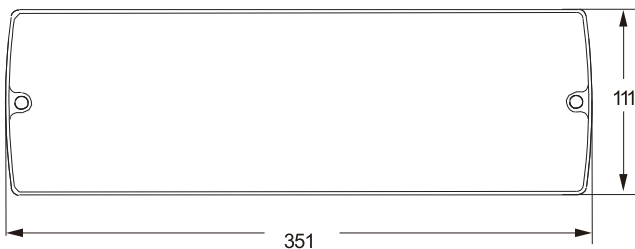

Inrush current

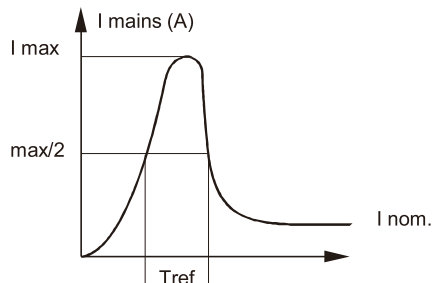

Electrical characteristics

<u>Inom (mA)</u>	<u>30</u>
<u>I_{max} (A)</u>	<u>4.96</u>
<u>Tref (μs)</u>	<u>100</u>

MCB Luminaires Max.

B-10 A	172
B-13 A	224
B-16 A	276
C-10 A	212
C-13 A	276
C-16 A	339



ATTENTION
OBSERVE PRECAUTIONS
FOR HANDLING
ELECTROSTATIC
SENSITIVE
DEVICES

- The luminaire shall be installed by a qualified electrician and wired in accordance with the latest IEE electrical regulations or the national requirements.
- When the light source reaches its end of life the whole luminaire shall be replaced.
 - Clean with dry cloth.

indicated drivers are used.

ALWAYS SWITCH OFF THE
MAINS SUPPLY BEFORE
INSTALLATION OR SERVICING

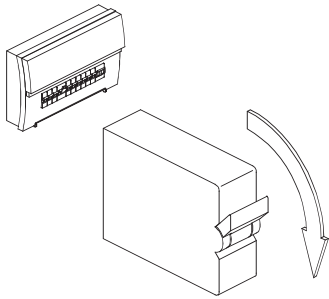

1

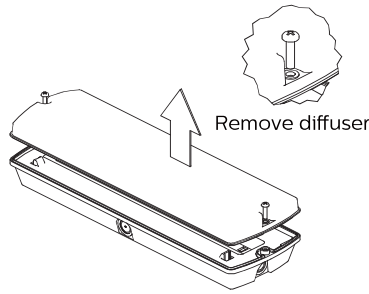

2

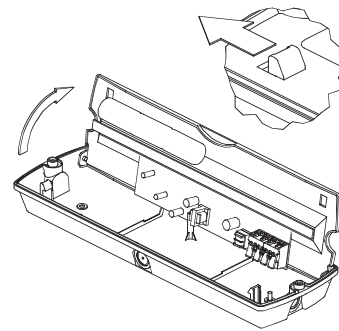

3

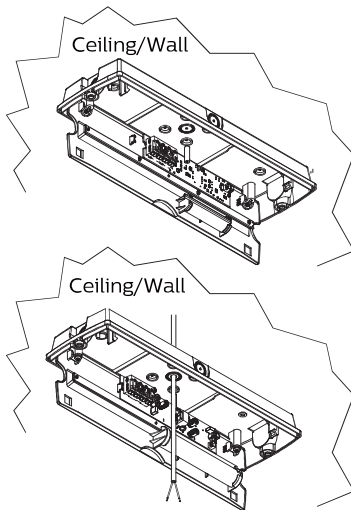

4

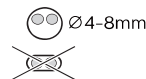
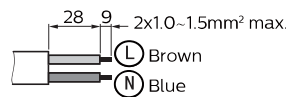
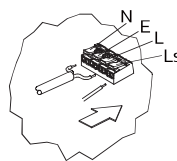
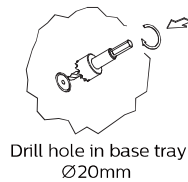

Note: if using side entry:
drill Ø16mm hole and apply
PG9 cable gland (not supplied)

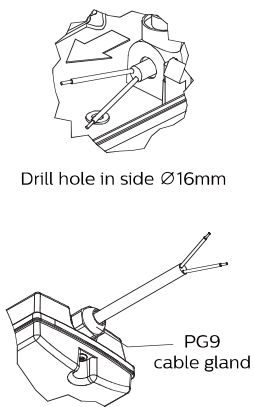

EMERGENCY TERMINATIONS NON-MAINTAINED

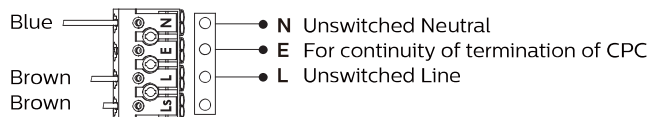

EMERGENCY TERMINATIONS MAINTAINED

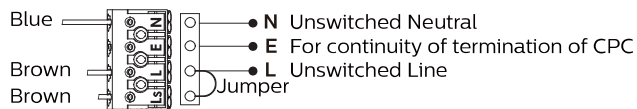

EMERGENCY TERMINATIONS MAINTAINED (SWITCHABLE)

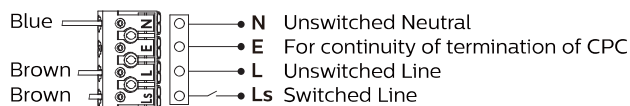

5

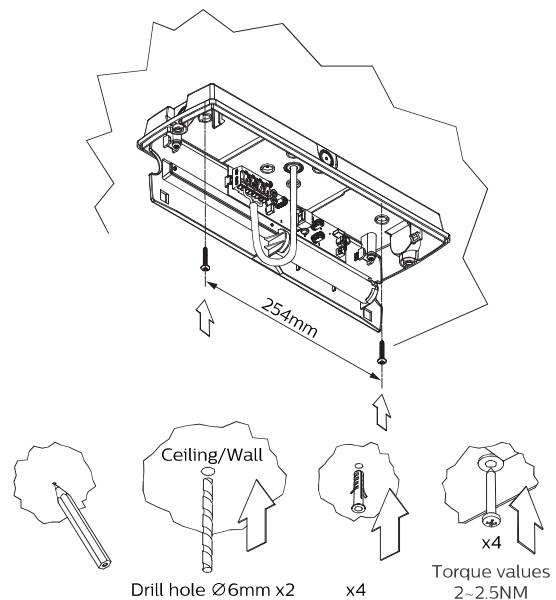

6

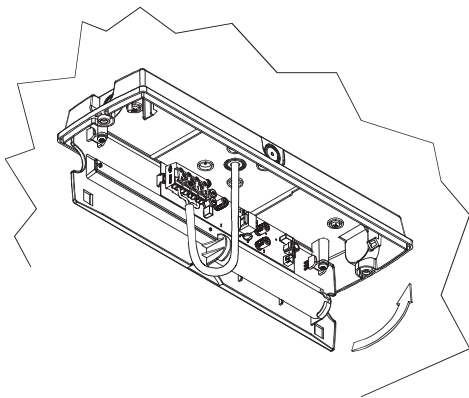

7

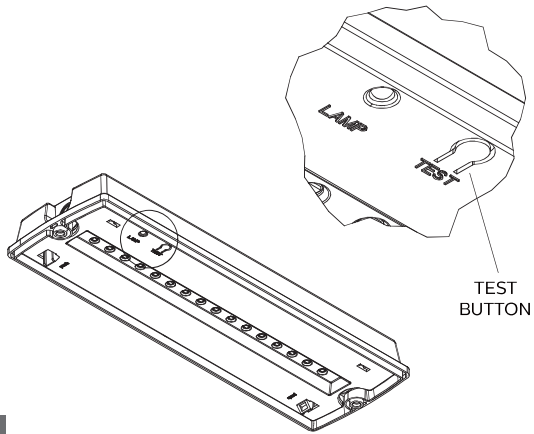

8

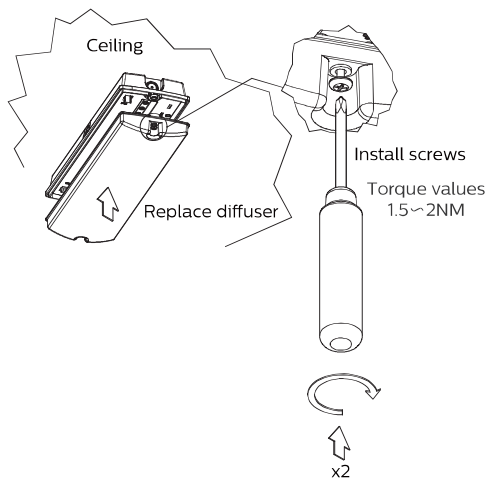

9

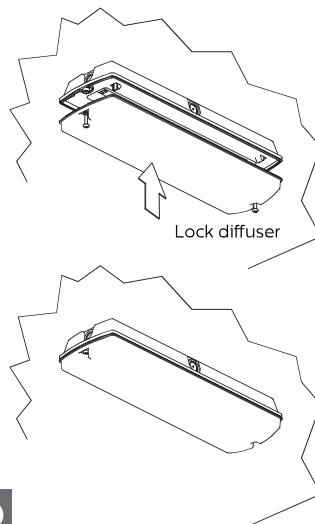

10

SWITCH ON THE MAINS
SUPPLY AFTER
INSTALLATION OR
SERVICING

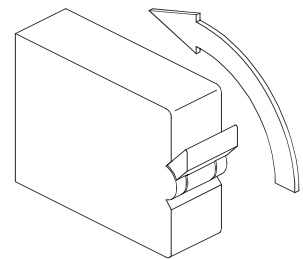

11

Battery replacement

LiFePO₄ -18650-1500mAh-3.2V

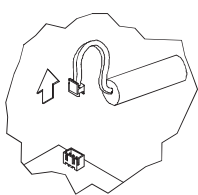

Disconnect battery
to converter

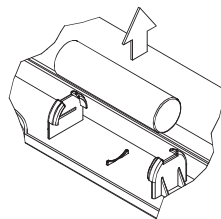

Remove the battery

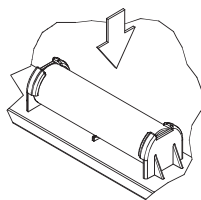

Replace the battery

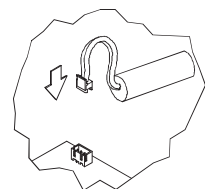

Connect new battery
to converter

Luminous Intensity Distribution

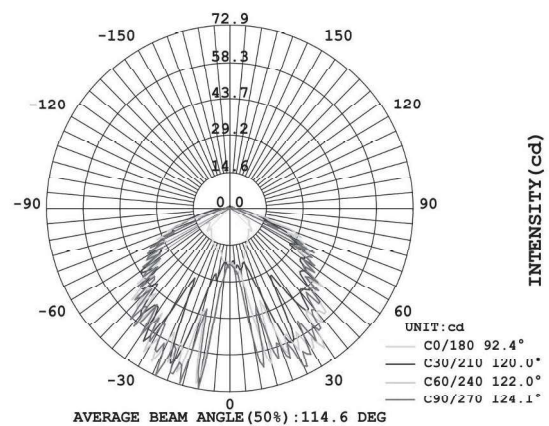

Spacing Data (1 lux)

Mounting Height (m)					
2.50	1.57	4.77	6.74	8.92	3.64
3.00	1.32	4.55	6.94	9.57	3.49
3.50	0.62	4.38	7.00	9.88	3.73
4.00	0.00	3.96	3.88	7.15	0.00



1. For indoor use only.
2. The luminaire complies with IEC60598-1/IEC 60598-2-22.
The luminaire must be installed by a qualified electrician and wired in accordance with the latest IEE Electrical regulations or the national requirements.
3. Turn off the power supply before checking, installation, maintenance or moving.
4. Do not switch on before complete installation.
5. The light source and/or controller contained in this luminaire shall only be replaced by the manufacturer or his service agent or a similar qualified person.
6. Batteries shall only be replaced by the manufacturer or his service agent or a similar qualified person.
7. Batteries should be replaced when the luminaire no longer meets the 3 hours duration performance.
8. Product mains surge immunity is 0.5/1KV (diff. / comm. mode). To prevent excessive currents and voltages from damaging the device, make sure that the power supply input is equipped with additional protection devices such as surge protectors. For any questions regarding the product's surge protection, please consult the manufacturer's professional.



Please inform yourself about the local waste disposal, separation and collection system for electrical and electronic products and packaging. Please act according to your local rules and do not dispose your old product and packaging with your normal household waste. The correct disposal of the packaging, your product and/or batteries will help prevent potential negative consequences for the environment and human health. Batteries should be disposed separately from the municipal waste stream via designated collection facilities. When disposing a product that contains non-user replaceable batteries, the non-user replaceable batteries shall be removed by a professional.

Testing Record

Product: _____

Location: _____

Installation Date: _____

Month	Functional/Duration	Year 1	Year 2	Year 3	Year 4	Year 5
1						
2						
3						
4						
5						
6						
7						
8						
9						
10						
11						
12						