

PHILIPS Day-Brite CFI

Special Application

Kleenseal HL

Cleanroom
T8



Project: _____
Location: _____
Cat.No: _____
Type: _____
Lamps: _____ Qty: _____
Notes: _____

The Philips Day-Brite / Philips CFI Kleenseal HL recessed is a cleanroom luminaire with hazardous location listing suited for electronic, biological, pharmaceutical, cleanrooms and most hazardous locations.

Ordering guide

Example: HL2443G1TAK1-1/4-EB

Family	Size	No. of Lamps	Lamp Type	Ceiling Type	Door Frame	Lens Type	Voltage	No. of Ballasts	Ballast Type	Options
HL							—	—	—	
HL Kleenseal HL	14 1x4 22 2x2 24 2x4	2 Two lamps 3 Three lamp 4 Four lamps (2x2,2x4)	1 17WT8 3 32WT8	G Grid F Flange	1 Aluminum Flush 5 Stainless Steel Overlap	TAK .125" Acrylic Prismatic POK Polycarbonate Prismatic C73 Tempered Glass Prismatic XTK .187" Acrylic Prismatic VPL Sealed Louver	U Universal voltage, 120-277V 1 120V 2 277V 3 347V	1/2 One 2-lamp ballast 2/1 Two 1-lamp ballasts 1/3 One 3-lamp ballast 1/21 2-lamp & 1-lamp ballasts 1/4 One 4-lamp ballast 2/2 Two 2-lamp ballasts	EB Electronic ballast <10% THD EB10R T8 electronic ballast, program rapid start, <10% THD	GLR Fusing, fast blow GMF Fusing, slow blow TP Tamper Resistant Screws DN Lens Furnished SSH Prisms Down Stainless steel housing

Product Availability

Luminaire Length	Lamp Type	No. of Lamps
1x4	F32	2, 3
2x2	F17	2, 3, 4
2x4	F32	2, 3, 4

General Notes

- Many luminaire components, such as reflectors, refractors, lenses, sockets, lampholders, and LEDs are made from various types of plastics which can be adversely affected by airborne contaminants. If sulfur based chemicals, petroleum based products, cleaning solutions, or other contaminants are expected in the intended area of use, consult factory for compatibility.

HL Kleenseal recessed

Cleanroom, T8

Standards

- Certified to meet UL 1598 standards for wet location.

Construction/Finish

- Totally sealed recessed fluorescent with flush door frame.
- Housing is 20ga CRS (stainless steel optional) with silicone sealed joints.
- Fits 1" or 1-1/2" grid ceiling
- Flange mounting available. Adjustable swing arm brackets standard on flange units.
- Doors frame is extruded aluminum with silicone sealed miter joints. Optional stainless steel overlap door.
- .125" prismatic acrylic lens is silicone sealed to door frame. Optional lens materials available.
- Door frame is chain hung for safe maintenance.
- Class I, Division 2, Groups A, B, C, D, T4A, Class II, Division 2, Groups F, G, T4 (40° ambient), Class III.

Dimensions

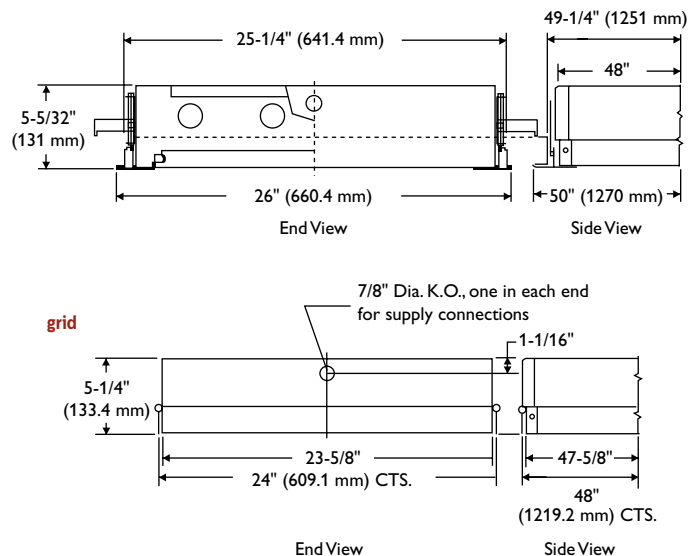

Note: For technical information or codes and classifications, see PDFs Tech1-Tech5 online.

Ceiling Opening Flange Type

1X4	13-1/4" X 49-1/4"
2X2	25-1/4" X 25-1/4"
2X4	25-1/4" X 49-1/4"



Some luminaires use fluorescent or high intensity discharge (HID) lamps that contain small amounts of mercury. Such lamps are labeled, "Contain Mercury" and/or the symbol "HG". Lamps that contain mercury must be disposed of in accordance with local requirements. Information regarding lamp recycling and disposal can be found at www.lamprecycle.org

