



# Philips Smart Bright Essential Pro: Bright Ideas for Every Application

## Smartbright Essential Pro-Flood Light

SmartBright Essential Pro, an innovative lighting solution designed to meet the diverse and demanding illumination requirements of modern environments. In a world where effective lighting plays a crucial role in safety, functionality, and aesthetics. This fixture combines advanced integrated optics with a remarkable selection of 8 wattage options, providing customizable brightness levels tailored to various applications. Whether illuminating expansive outdoor spaces, bustling industrial facilities, or large commercial areas, the SmartBright Essential Pro is engineered to deliver unparalleled performance and longevity. With a focus on efficiency, durability, and ease of use, this lighting solution is crafted to meet the needs of a wide array of environments. From enhancing residential areas and parks to brightening warehouses and construction sites, the SmartBright Essential Pro excels in any setting. Its sleek and modern design not only complements contemporary architecture but also enhances the overall ambiance of spaces, creating inviting and functional environments for work and leisure alike. Embrace the future of lighting with the SmartBright Essential Pro, where innovative technology meets practical design, transforming your spaces with reliable and stylish illumination.

# Smartbright Essential Pro-Flood Light

## Benefits

- Enhanced Durability and Reliability: Its rugged design ensures longevity, reducing the need for frequent replacements.
- Cost-Effective Lighting Solution: With its energy-efficient design, it helps lower electricity bills while providing optimal brightness.
- Easy Installation and Maintenance: The SmartBright Essential Pro is user-friendly, allowing for quick installation and straightforward upkeep.
- Stylish and Modern Design: Its sleek aesthetics make it a perfect fit for contemporary settings, enhancing the visual appeal of any area.

## Features

- High Efficiency: Delivers an impressive 100 lumens per watt, ensuring bright and effective lighting.
- All-Weather Protection: Rated IP66, the SmartBright Essential Pro is built to withstand harsh weather conditions, making it ideal for any outdoor setting.
- Robust Construction: Crafted from high-pressure die-cast aluminum, it guarantees durability and resistance to wear and tear.
- Surge Protection: Designed with high surge protection, it safeguards against electrical fluctuations, enhancing reliability.

## Application

- Walkways
- Warehouses
- Parks and Plazas

## Dimensional drawing

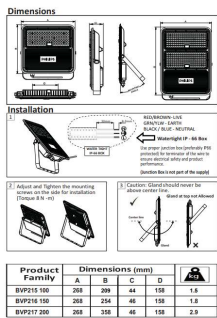

Smartbright Essential Pro-Flood Light

General Information	
Driver included	Yes
Light Technical	
Luminaire light beam spread	90°
Color rendering index (CRI)	70
Luminous Efficacy (rated) (Nom)	100 lm/W
Optic type outdoor	Symmetrical
Operating and Electrical	
Surge Protection (Common/Differential)	4/4 kV kV
Controls and Dimming	
Dimmable	No
Mechanical and Housing	
Optical cover type	Polycarbonate
Housing Color	Black
Mech. impact protection code	IK07
Ingress protection code	IP66
Approval and Application	
Ambient temperature range	0 °C to 35 °C
Flammability mark	-

Light Technical

Order Code	Full Product Name	Light source color	Correlated Color	
			Temperature (Nom)	Luminous Flux
919615896607	BVP216 LED150 CW 150W WB GR PSU	Cool white	6500 K	15,000 lm
919615896608	BVP216 LED150 WW 150W WB GR PSU	Warm white	3000 K	15,000 lm
919615896609	BVP217 LED200 CW 200W WB GR PSU	Cool white	6500 K	20,000 lm
919615896610	BVP217 LED200 WW 200W WB GR PSU	Warm white	3000 K	20,000 lm
919615896605	BVP215 LED100 CW 100W GR PSU	Cool white	6500 K	10,000 lm
919615896606	BVP215 LED100 WW 100W GR PSU	Warm white	3000 K	10,000 lm

Operating and Electrical

Order Code	Full Product Name	Power Consumption	Order Code	Full Product Name	Power Consumption
919615896607	BVP216 LED150 CW 150W WB GR PSU	150 W	919615896610	BVP217 LED200 WW 200W WB GR PSU	200 W
919615896608	BVP216 LED150 WW 150W WB GR PSU	150 W	919615896605	BVP215 LED100 CW 100W GR PSU	100 W
919615896609	BVP217 LED200 CW 200W WB GR PSU	200 W	919615896606	BVP215 LED100 WW 100W GR PSU	100 W

