



# An Energy efficient Well Glass for Industrial and commercial application

## DuraLED Well Glass

DuraLED well glass is designed to replace traditional Well Glass up to 70W with only 50% of the load for similar illumination. It is a perfect LED solution for outdoor application and industry of harsh condition like power plant, metal, and non-hazardous area in chemical and petrochemical industry. Compared to conventional HID Well Glass, it improves reliability, comfort, while reducing energy and maintenance cost dramatically. DuraLED Well Glass comes with 2 different mounting, Wall bracket (2 types) & Eye-bolt and comes with 2 color temperature and 2 lumen outputs.

### Benefits

- Suitable for use in harsh Industrial environment
- Outstanding energy efficiency leads to lowering ROI
- Comfortable diffused light
- High quality material and design leads to longer life class for luminaire

# DuraLED Well Glass

## Features

- Ingress Protection -IP65
- Impact Resistance IK08
- Inbuilt encapsulated Potted Driver
- Designed for operations under diverse environment from 0°C to 45°C
- Life class is 50000 hours (L70B50 @ Ta45°C)
- Pressure die-cast housing offers excellent corrosion-resistance and robustness
- System efficiency >120 lm/W
- High Voltage Cutoff @ 325 ± 15V with Auto Restart feature
- 440V Protection for 8 Hrs. (Phase to Phase)
- Internal Surge Protection 4KV
- CRI>80; comfortable lighting with low glare ratings

## Application

- Manufacturing
- Harsh Industry Applications

## Warnings and Safety

- Meant for use in Indoor Industrial environment only

## Dimensional drawing

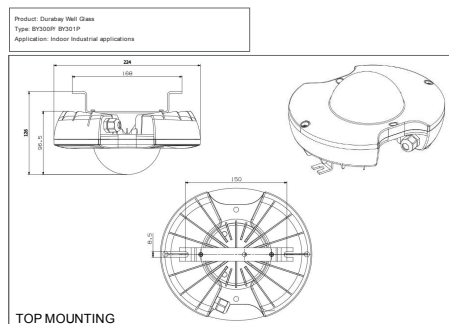

## Product details



BY300P LED



BY300P LED



BY300P LED

## DuraLED Well Glass

### General Information

Driver included	Yes
-----------------	-----

### Light Technical

Beam angle of light source	120 degree(s)
Color rendering index (CRI)	>80
Luminous Efficacy (rated) (Nom)	120 lm/W
Optic type	Beam angle 120°

### Operating and Electrical

Protection class IEC	Safety class I
Input Voltage	120 to 277 V

### Controls and Dimming

Dimmable	No
----------	----

### Mechanical and Housing

Optical cover type	Opal diffuser in polycarbonate cover
Housing Color	Gray
Mech. impact protection code	IK08
Ingress protection code	IP65

### Approval and Application

Ambient temperature range	0 to +45 °C
Flammability mark	For mounting on normally flammable surfaces

### Initial Performance (IEC Compliant)

Initial chromaticity	SDCM<5
----------------------	--------

### Light Technical

Order Code	Full Product Name	Correlated Color Temperature (Nom)	Luminous Flux
919515812315	BY300P LED 25S WW PSU S1 PC	3000 K	2,700 lm
919515812317	BY300P LED 27S CW PSU S1 PC	6500 K	2,700 lm
919515812324	BY300P LED 35S WW PSU S1 PC	3000 K	3,700 lm
919515812325	BY300P LED 37S NW PSU S1 PC	4000 K	3,700 lm
919515812332	BY300P LED 37S CW PSU S1 PC SPD	6500 K	3,700 lm

### Operating and Electrical

Order Code	Full Product Name	Power Consumption
919515812315	BY300P LED 25S WW PSU S1 PC	23 W
919515812317	BY300P LED 27S CW PSU S1 PC	23 W
919515812324	BY300P LED 35S WW PSU S1 PC	33 W

Order Code	Full Product Name	Power Consumption
919515812325	BY300P LED 37S NW PSU S1 PC	33 W
919515812332	BY300P LED 37S CW PSU S1 PC SPD	33 W

