



Ledinaire Square Wall-mounted: for your everyday lighting jobs.

Ledinaire Square Wall-mounted

Public spaces and circulation areas demand the most reliable lighting solutions – especially parking garages, offices, entrances, hallways, corridors, and staircases. With Philips Ledinaire, you get superb reliability and more. This popular range features a selection of essential LED luminaires that you can choose off the shelf. Like our modern, Ledinaire square wall-mounted WL055V model that's suitable for a wide range of general lighting applications. And just like the rest of the Ledinaire range, it's designed with Philips high quality standards at a very competitive price. An affordable, reliable, and energy-efficient choice for wall mounting, from the leading name in LED.

Benefits

- Philips quality and reliability
- Energy saving LED
- Water and vandal-proof
- Wide range of applications
- Rectangular 1:1 replacement for TCH329 luminaire

Features

- Modern, simplistic design
- High efficiency with 100lm/W
- High protection (IP65 and IK08)
- Optional emergency version with 3 hour's battery
- Optional motion detection and daylight sensor (MDU)
- Optional step dimming by dipswitch at 10% and 20%

Ledinaire Square Wall-mounted

Application

- Parking Garages
- Entrances
- Corridors
- Staircases

Warnings and Safety

- For MDU (Motion Detection Unit) versions:
- Sensor coverage may vary between indoor and outdoor applications.
- Strong wind and rain may trigger the sensor if there are no surroundings such as walls, roof etc.
- Any vibration or movement may trigger the sensor. Ensure the sensor is far from any such continuous signal.

Versions



Ledinaire Square Wall-mounted
WL055V PSU WH

Dimensional drawing

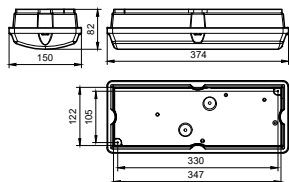

Product details

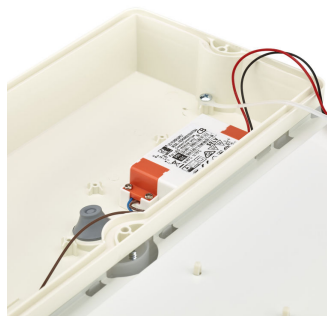

Ledinaire Square Wall-mounted
standard version (PSU)



Ledinaire Square Wall-mounted
standard version (PSU)

Ledinaire Square Wall-mounted

Product details

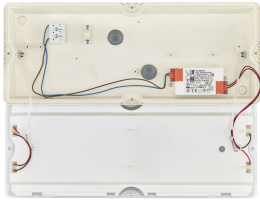

Ledinaire Square Wall-mounted
standard version (PSU)

