



# All-in-one Solar street light range up-to 18000 Lumens. Offgrid and Hybrid options.

## SmartBright All-in-one Solar Street Light

Integrated solar street light with Lithium Ferro Phosphate battery, solar panel and charger built into the luminaire. Independently tilt-able LED source and pole mounting bracket allows light beam to focus on road, and solar panel towards the sun. Microwave based motion sensor for optimizing battery autonomy.

### Benefits

- Brings light to areas without access to electric grid
- Saves energy
- Preserves landscape as no trenching for cabling required
- Environment friendly
- Sturdy construction for long life

# SmartBright All-in-one Solar Street Light

## Features

- High luminous efficacy up-to 185lm/watt to maximize battery performance
- Replaceable Lithium Ferro Phosphate battery for long life and hassle free operations.
- MPPT charge controller for maximum efficiency
- Independently tilt-able LED module and pole mounting bracket allows light beam to focus on road, and solar panel towards the sun
- Factory set dimming profile along with microwave sensor for run time maximization.
- Offgrid and Hybrid types are available. HY in the product description means Hybrid version that can be connected with AC power.
- 500hours salt spray testing pass

## Application

- Class A & B roads
- Rural areas
- Parks, pedestrian path lighting
- Industries, office, schools
- Shopping centers, corporate campuses, plazas

## Versions



# SmartBright All-in-one Solar Street Light

## Dimensional drawing

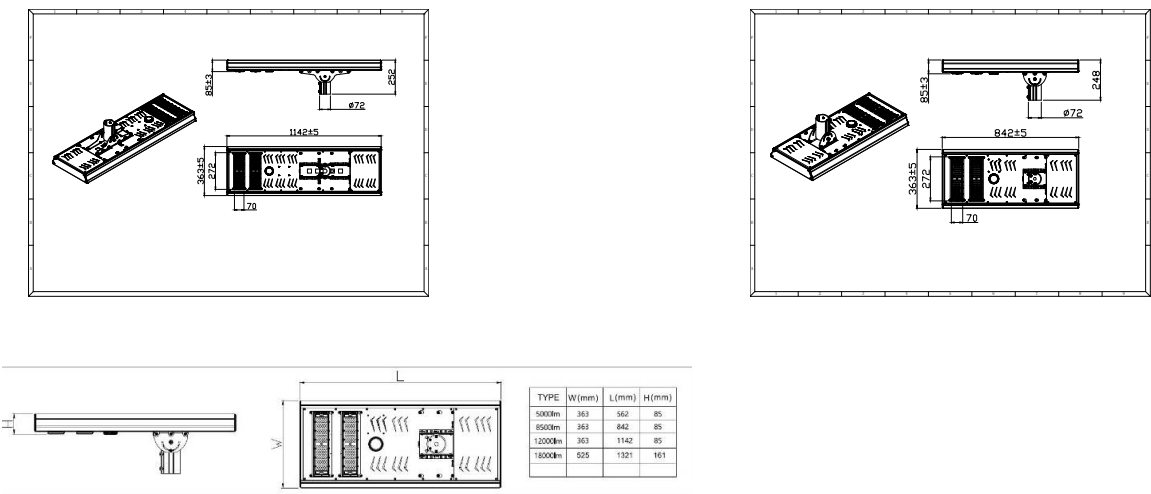

SmartBright All-in-one Solar Street Light

Light Technical	
Correlated Color Temperature (Nom)	5700 K
Color rendering index (CRI)	>70
Operating and Electrical	
Battery charging & discharging cycles	2000
Charge controller type	MPPT
Panel type	Mono crystalline
Controls and Dimming	
Dimmable	Yes
Configurability	Configurable
Solar dimming profile	First 2 Hrs - On motion : 100%, without motion :30% ; Next 3 Hrs - On motion : 60%, without motion :20% ; Next 6 Hrs On motion : 30%, without motion :10% ; Rest of the Night: On motion : 50%, without motion :30%
Mechanical and Housing	
Battery location	Inbuilt
Housing Color	RAL7040
Ingress protection code	IP65

Operating and Electrical (1/2)

Order Code	Full Product Name	Battery ampere	Battery type	Battery voltage	Cable connection kit
		hour			
911401834102	BRP110 LED120/757 G2	72 Ah	LiFePO4	6.4 V	-
911401834202	BRP110 LED180/757 G2	30 Ah	LiFePO4	25.6 V	-
911401878602	BRP110 LED85/757 G2 HY Solar	18 Ah	Lithium Ferro Phosphate	12 V	Excluded
911401833902	BRP110 LED50/757 G2	60 Ah	LiFePO4	3.2 V	-
911401878502	BRP110 LED120/757 G2 HY Solar	24 Ah	Lithium Ferro Phosphate	12 V	Excluded
911401834002	BRP110 LED85/757 G2	54 Ah	LiFePO4	6.4 V	-

Operating and Electrical (2/2)

Order Code	Full Product Name	Charge controller wattage	Grid connection type	Panel peak wattage	Panel voltage
911401834102	BRP110 LED120/757 G2	-	Off grid	80 W	13 V
911401834202	BRP110 LED180/757 G2	-	Off grid	125 W	34.5 V
911401878602	BRP110 LED85/757 G2 HY Solar	42 W	Hybrid	55 W	18 V

Order Code	Full Product Name	Charge controller wattage	Grid connection type	Panel peak wattage	Panel voltage
911401833902	BRP110 LED50/757 G2	-	Off grid	35 W	12 V
911401878502	BRP110 LED120/757 G2 HY Solar	65 W	Hybrid	80 W	18 V
911401834002	BRP110 LED85/757 G2	-	Off grid	55 W	14 V

Controls and Dimming

Order Code	Full Product Name	Autonomy
911401834102	BRP110 LED120/757 G2	24 hour(s)
911401834202	BRP110 LED180/757 G2	24 hour(s)
911401878602	BRP110 LED85/757 G2 HY Solar	-

Order Code	Full Product Name	Autonomy
911401833902	BRP110 LED50/757 G2	24 hour(s)
911401878502	BRP110 LED120/757 G2 HY Solar	-

# SmartBright All-in-one Solar Street Light

Order Code	Full Product Name	Autonomy
911401834002	BRP110 LED85/757 G2	24 hour(s)

## Mechanical and Housing

Order Code	Full Product Name	Overall height	Overall length	Overall width
911401834102	BRP110 LED120/757 G2	85 mm	1,142 mm	363 mm
911401834202	BRP110 LED180/757 G2	161 mm	1,320 mm	525 mm
911401878602	BRP110 LED85/757 G2 HY Solar	86 mm	842 mm	364 mm

Order Code	Full Product Name	Overall height	Overall length	Overall width
911401833902	BRP110 LED50/757 G2	85 mm	562 mm	363 mm
911401878502	BRP110 LED120/757 G2 HY Solar	86 mm	1,142 mm	364 mm
911401834002	BRP110 LED85/757 G2	85 mm	842 mm	363 mm

## Approval and Application

Order Code	Full Product Name	Ambient temperature range
911401834102	BRP110 LED120/757 G2	0 to +50 °C
911401834202	BRP110 LED180/757 G2	0 to +50 °C
911401878602	BRP110 LED85/757 G2 HY Solar	-10 °C to 60 °C

Order Code	Full Product Name	Ambient temperature range
911401833902	BRP110 LED50/757 G2	0 to +50 °C
911401878502	BRP110 LED120/757 G2 HY Solar	-10 °C to 60 °C
911401834002	BRP110 LED85/757 G2	0 to +50 °C

## Application Conditions

Order Code	Full Product Name	Ambient temperature range for charging	Ambient temperature range for discharging (when light is on)
911401834102	BRP110 LED120/757 G2	-	-
911401834202	BRP110 LED180/757 G2	-	-
911401878602	BRP110 LED85/757 G2 HY Solar	0 °C to 50 °C	-10 °C to 60 °C

Order Code	Full Product Name	Ambient temperature range for charging	Ambient temperature range for discharging (when light is on)
911401833902	BRP110 LED50/757 G2	-	-
911401878502	BRP110 LED120/757 G2 HY Solar	0 °C to 50 °C	-10 °C to 60 °C
911401834002	BRP110 LED85/757 G2	-	-

