



# Outdoor Solar LED Wall light

## Essential SmartBright Solar Wall Light

Outdoor solar wall light with inbuilt lithium ferro phosphate battery, solar panel, inbuilt motion sensor, switch to change modes and LED lights integrated in ABS plastic housing.

### Benefits

- DIY easy installation
- No wiring required
- Suitable for outdoor installation.
- Motion sensor to optimize battery and light requirements.
- Easily configurable as per consumer need.

### Features

- All in one construction, the device can be installed on a wall screw.
- Completely powered by solar energy.
- IP54 rated ABS plastic housing.
- PIR motion sensor to detect motion and optimize battery life.
- Toggle switch on front to cycle through multiple operational modes.
- LiFePO4 battery included inside the luminaire.

### Application

- Garden
- Walkways
- Parking areas
- Architectural Lighting
- Landscape

### Warnings and Safety

- This product includes rechargeable batteries which must be adequately charged under sunlight before use.

# Essential SmartBright Solar Wall Light

## Versions



Essential SmartBright Solar Wall  
Light

## Dimensional drawing

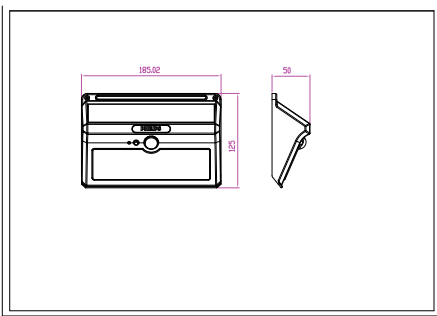
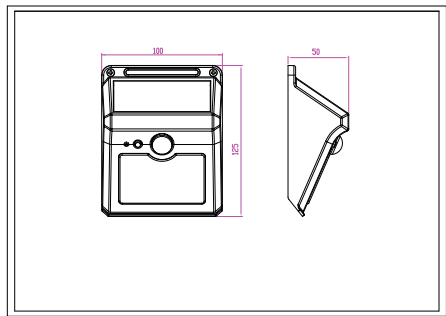

Light Technical	
Correlated Color Temperature (Nom)	6500 K
Color rendering index (CRI)	>70
Operating and Electrical	
Charge controller type	PWM
Grid connection type	Off grid
Controls and Dimming	
Dimmable	Yes
Configurability	Not configurable
Solar dimming profile	As per mode switch
Mechanical and Housing	
Battery location	Inbuilt
Housing Color	Gray
Ingress protection code	IP54
Overall length	125 mm
Overall width	50 mm
Approval and Application	
Ambient temperature range	0 °C to 45 °C

## Operating and Electrical (1/2)

Order Code	Full Product Name	Battery ampere hour	Battery charging & discharging		Battery voltage
			cycles	Battery type	
911401877202	BWS010 LED05/765 G2	1.2 Ah	500	Lithiumion - NMC	3.7 V
911401877502	BWS010 LED05/765 Pro G2	1.1 Ah	1000	Lithium Ferro Phosphate	3.2 V
911401877302	BWS010 LED1/765 G2	1.2 Ah	500	Lithiumion - NMC	3.7 V
911401877402	BWS010 LED3/765 G2	1 Ah	500	Lithiumion - NMC	3.7 V
911401877602	BWS010 LED1/765 Pro G2	1.1 Ah	1000	Lithium Ferro Phosphate	3.2 V
911401877702	BWS010 LED3/765 Pro G2	1.6 Ah	1000	Lithium Ferro Phosphate	3.2 V

## Operating and Electrical (2/2)

Essential SmartBright Solar Wall Light

Order Code	Full Product Name	Charge controller	Panel peak wattage	Panel type	Panel voltage
		wattage	wattage		
911401877202	BWS010 LED05/765 G2	0.5 W	0.5 W	Poly crystalline	5.5 V
911401877502	BWS010 LED05/765 Pro G2	0.5 W	0.5 W	Poly crystalline	4.5 V
911401877302	BWS010 LED1/765 G2	0.75 W	0.75 W	Poly crystalline	5.5 V

Order Code	Full Product Name	Charge controller	Panel peak wattage	Panel type	Panel voltage
		wattage	wattage		
911401877402	BWS010 LED3/765 G2	2 W	1.3 W	Mono crystalline	5.5 V
911401877602	BWS010 LED1/765 Pro G2	0.75 W	0.75 W	Poly crystalline	4.5 V
911401877702	BWS010 LED3/765 Pro G2	2 W	1.3 W	Mono crystalline	4.5 V

Mechanical and Housing

Order Code	Full Product Name	Overall height
911401877202	BWS010 LED05/765 G2	105 mm
911401877502	BWS010 LED05/765 Pro G2	105 mm
911401877302	BWS010 LED1/765 G2	185 mm

Order Code	Full Product Name	Overall height
911401877402	BWS010 LED3/765 G2	185 mm
911401877602	BWS010 LED1/765 Pro G2	185 mm
911401877702	BWS010 LED3/765 Pro G2	185 mm

Application Conditions

Order Code	Full Product Name	Ambient temperature range for charging	Ambient temperature range for discharging (when light is on)
911401877202	BWS010 LED05/765 G2	0 °C to 45 °C	0 °C to 45 °C
911401877502	BWS010 LED05/765 Pro G2	0 °C to 55 °C	0 °C to 55 °C
911401877302	BWS010 LED1/765 G2	0 °C to 45 °C	0 °C to 45 °C

Order Code	Full Product Name	Ambient temperature range for charging	Ambient temperature range for discharging (when light is on)
911401877402	BWS010 LED3/765 G2	0 °C to 45 °C	0 °C to 45 °C
911401877602	BWS010 LED1/765 Pro G2	0 °C to 55 °C	0 °C to 55 °C
911401877702	BWS010 LED3/765 Pro G2	0 °C to 55 °C	0 °C to 55 °C

