



Clearflood gen2 : Your optimized TCO solution for general area and recreational sports projects

Clearflood gen2

This new generation of Clearflood range brings the total cost of ownership of your project to the next level. The range comes in 3 sizes (BVP655, BVP656, BVP657) with several finishing and serviceability options, and leverages on the light engine of our Recreational Sports & Area flagship floodlight. This light engine is optimized for sports applications, as well as large areas, such as logistical hubs, outdoor car parks and storage area. Now an innovative design approach allows the availability of connected options such as the SR socket, fully integrated on the floodlight housing, and a multi-sensor on the bracket. The product range is compatible with Interact systems.

Benefits

- Optimized total cost of ownership thanks to a good balance between initial investment and operational costs
- Compatible with Interact systems
- Choose your serviceability level and finishing
- Long lasting, robust design

Clearflood gen2

Features

- Features dedicated Sports&Area light engine and optics
- 3 different sizes (BVP655, BVP656, BVP657)
- CCT available from 2700K to 5700K
- Electrical class I and II
- IP66, IK08
- Serviceability options: toolless opening or fixed glass
- Finishing options: raw, standard, marine protection (MSP), swimming pool protection (SPO)
- Connectivity options: SR socket, OLC node and multi-sensor options are available

Application

- Arena and Sports
- Airports
- Manufacturing
- Warehouses
- Harbor

Versions



BVP656 Clearflood gen2 medium

Dimensional drawing

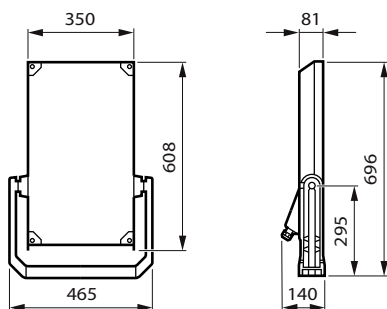

Product details

Opening without tool



Fixed glass



Combo SR node and OSB sensor



SR socket on bracket



SR node on housing



Polar Wide Diagrams

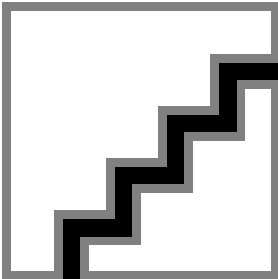

Polar Normal (separate) - BVP656I - 912300060559

