



# Clearflood gen2 : Your optimized TCO solution for general area and recreational sports projects

## Clearflood gen2

This new generation of Clearflood range brings the total cost of ownership of your project to the next level. The range comes in 3 sizes (BVP655, BVP656, BVP657) with several finishing and serviceability options, and leverages on the light engine of our Recreational Sports & Area flagship floodlight. This light engine is optimized for sports applications, as well as large areas, such as logistical hubs, outdoor car parks and storage area. Now an innovative design approach allows the availability of connected options such as the SR socket, fully integrated on the floodlight housing, and a multi-sensor on the bracket. The product range is compatible with Interact systems.

### Benefits

- Optimized total cost of ownership thanks to a good balance between initial investment and operational costs
- Compatible with Interact systems
- Choose your serviceability level and finishing
- Long lasting, robust design

# Clearflood gen2

## Features

- Features dedicated Sports&Area light engine and optics
- 3 different sizes (BVP655, BVP656, BVP657)
- CCT available from 2700K to 5700K
- Electrical class I and II
- IP66, IK08
- Serviceability options: toolless opening or fixed glass
- Finishing options: raw, standard, marine protection (MSP), swimming pool protection (SPO)
- Connectivity options: SR socket, OLC node and multi-sensor options are available

## Application

- Arena and Sports
- Airports
- Manufacturing
- Warehouses
- Harbor

## Versions



BVP657 Clearflood gen2 large



BVP656 Clearflood gen2 medium



BVP655 Clearflood gen2 small

## Dimensional drawing

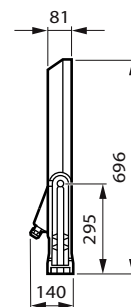
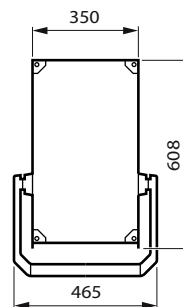
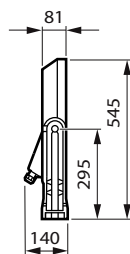
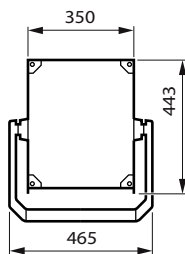

Clearflood gen2

Dimensional drawing

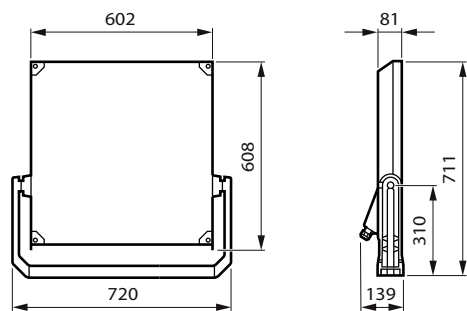

Product details

Opening without tool



Fixed glass



Combo SR node and OSB sensor



SR socket on bracket



SR node on housing



General Information	
Driver included	Yes
Service tag	Yes
Light Technical	
Luminaire light beam spread	5° - 13° x 128°
Light source color	740 neutral white
Correlated Color Temperature (Nom)	4000 K
Color rendering index (CRI)	70
Optic type outdoor	Asymmetrical
Upward light output ratio	0
Operating and Electrical	
Surge Protection (Common/ Differential)	6/8 kV
Controls and Dimming	
Dimmable	No
Mechanical and Housing	
Optical cover type	Clear glass
Housing Color	Aluminum
Mech. impact protection code	IK08
Ingress protection code	IP66
Standard tilt angle side entry	-
Standard tilt angle posttop	-
Approval and Application	
CE mark	Yes
Flammability mark	-

General Information

Order Code	Full Product Name	Lamp family code	Number of gear units
912300060565	BVP657 LED930-4S/740 PSU A65-WB ALU	LED930	3 units
912300060558	BVP656 LED600-4S/740 PSU A65-WB ALU	LED600	2 units
912300060551	BVP655 LED300-4S/740 PSU A65-WB ALU	LED300	1 unit

Light Technical

Order Code	Full Product Name	Luminous Flux
912300060565	BVP657 LED930-4S/740 PSU A65-WB ALU	70,450 lm
912300060558	BVP656 LED600-4S/740 PSU A65-WB ALU	45,630 lm

Order Code	Full Product Name	Luminous Flux
912300060551	BVP655 LED300-4S/740 PSU A65-WB ALU	23,100 lm

Operating and Electrical

Order Code	Full Product Name	Power Consumption
912300060565	BVP657 LED930-4S/740 PSU A65-WB ALU	530 W
912300060558	BVP656 LED600-4S/740 PSU A65-WB ALU	341 W

Order Code	Full Product Name	Power Consumption
912300060551	BVP655 LED300-4S/740 PSU A65-WB ALU	172 W

Product Data

Order Code	Full Product Name	Product family code
912300060565	BVP657 LED930-4S/740 PSU A65-WB ALU	BVP657
912300060558	BVP656 LED600-4S/740 PSU A65-WB ALU	BVP656

Order Code	Full Product Name	Product family code
912300060551	BVP655 LED300-4S/740 PSU A65-WB ALU	BVP655

Polar Wide Diagrams

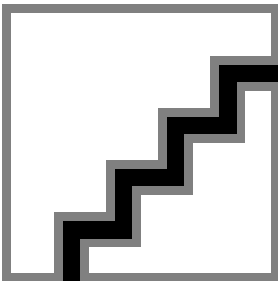

Polar Normal (separate) - BVP655I -  
912300060551

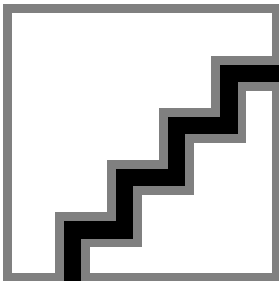

Polar Normal (separate) - BVP656I -  
912300060558

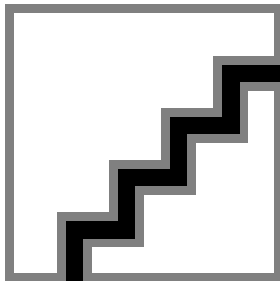

Polar Normal (separate) - BVP657I -  
912300060565

