

Simple, robust magnetic ballast

HID-Basic ballasts for HPL and HPI(PLUS) lamps

The HID-Basic ballast is an impregnated (HID standard) electromagnetic ballast for HID lamps, for use in combination with an external ignitor.

Benefits

- Limited volume of ballast coil; also lightweight
- Simple installation and cabling

Features

- Orthocyclic winding process
- Ballasts equipped with screw terminal blocks as standard
- Earthing-while-mounting facility (HID Standard ballasts)
- Low wattage losses

Application

- For built-in applications for road and public lighting with HPL, HPI and HPI (Plus) lamps
- HID-Basic ballasts should be restricted to built-in situations where relative humidity is limited.

HID-Basic ballasts for HPL and HPI(PLUS) lamps

Versions



GPPR BCHPL



GPPR BCHPL1 0001

Dimensional drawing

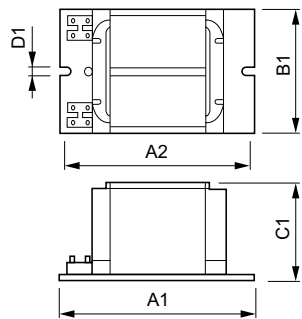

Product	D1	C1	A1	A2	B1
BHLA 125L 200	6.3 mm	64.5 mm	120.0 mm	100.0 mm	75.0 mm
BHLE 250L 200 TS	6.2 mm	64.5 mm	165.0 mm	144.0 mm	75.5 mm
BHLE 400L 200 TS	6.2 mm	64.5 mm	165.0 mm	144.0 mm	75.5 mm

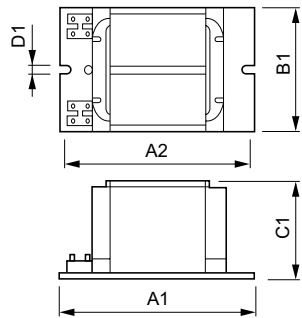

Product	D1	C1	A1	A2	B1
BHL 250L 200	6.2 mm	64.5 mm	125.0 mm	110.0 mm	75.5 mm
BHL 250L 202	6.3 mm	64.5 mm	125.0 mm	104.0 mm	72.5 mm
BHL 400L 202	6.3 mm	64.5 mm	150.0 mm	134.0 mm	75.5 mm



HID-Basic ballasts for HPL and HPI(PLUS) lamps

Operating and Electrical	
Input Frequency	50 Hz
Line Frequency	50 Hz

Operating and Electrical

Order Code	Full Product Name	Input Voltage
913710100442	BHL 250L 200	220 V
913710102550	BHL 250L 202	230 V
913710102650	BHL 400L 202	230 V

Order Code	Full Product Name	Input Voltage
913713017242	BHLE 250L 200 TS	220 V
913713017342	BHLE 400L 200 TS	220 V
913713018659	BHLA 125L 200	220 V

