



Beautiful sparkle, mini design

MASTERColour CDM-Tm Mini PGJ5

Mini, single-ended, high-efficiency Ceramic Metal Halide discharge lamp producing crisp white sparkling light

Benefits

- High-intensity beam of crisp white sparkling light makes merchandise look irresistible
- Stable color and lumen output over life keeps your store attractive season after season
- Fits in small luminaires which are less visible

Features

- Crisp white sparkling light
- Excellent color rendering, with extra red
- High efficacy
- Stable color performance during lifetime
- Mini size

Application

- Accent and display lighting in retail
- General and decorative indoor lighting
- Outdoor area lighting

MASTERCoulour CDM-Tm Mini PGJ5

Warnings and Safety

- Use only in totally enclosed luminaire, even during testing (IEC61167, IEC 62035, IEC60598)
- The luminaire must be able to contain hot lamp parts if the lamp ruptures
- Use only with electronic control gear
- Control gear must include end-of-life protection (IEC61167, IEC 62035)
- For 20W PGJ5 lamp, use only Philips electronic control gear HID PV mini PGJ5 20W
- For 35W PGJ5 lamp, use only Philips electronic control gear HID PV mini PGJ5 35W
- A lamp breaking is extremely unlikely to have any impact on your health. If a lamp breaks, ventilate the room for 30 minutes and remove the parts, preferably with gloves. Put them in a sealed plastic bag and take it to your local waste facilities for recycling. Do not use a vacuum cleaner.

Dimensional drawing

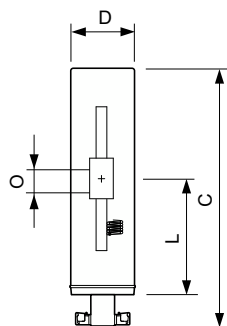

| Product | D (max) | D | O | L (min) | L (max) | L | C (max) |
|---|---------|-----------|------|---------|---------|---------|---------|
| MASTERC CDM-Tm Mini 20W/830 PGJ5 1CT/12 | 13.2 mm | 0.44 inch | 3 mm | 22.3 mm | 22.9 mm | 22.6 mm | 52 mm |
| MASTERC CDM-Tm Mini 35W/930 PGJ5 1CT/12 | 13.2 mm | 0.44 inch | 4 mm | 22.3 mm | 22.9 mm | 22.6 mm | 52 mm |

| General Information | |
|------------------------------------|-----------------|
| Cap-Base | PGJ5 |
| Operating Position | UNIVERSAL |
| Light Technical | |
| Chromaticity Coordinate X (Nom) | 0.434 |
| Chromaticity Coordinate Y (Nom) | 0.398 |
| Color Designation | Warm White (WW) |
| Correlated Color Temperature (Nom) | 3000 K |
| Controls and Dimming | |
| Dimmable | No |
| Mechanical and Housing | |
| Bulb Finish | Clear |
| Bulb Shape | T13.3 |

Light Technical

| Order Code | Full Product Name | Color rendering index (CRI) | Luminous Efficacy (rated) (Nom) | Luminous Flux |
|--------------|---|-----------------------------|---------------------------------|---------------|
| 928087905130 | MASTERC CDM-Tm Mini 20W/830 PGJ5 1CT/12 | 87 | 72 lm/W | 1,600 lm |
| 928093905130 | MASTERC CDM-Tm Mini 35W/930 PGJ5 1CT/12 | 91 | 77 lm/W | 3,000 lm |

Operating and Electrical

| Order Code | Full Product Name | Voltage (Nom) | Power Consumption |
|--------------|---|---------------|-------------------|
| 928087905130 | MASTERC CDM-Tm Mini 20W/830 PGJ5 1CT/12 | 100 V | 22.1 W |

| Order Code | Full Product Name | Voltage (Nom) | Power Consumption |
|--------------|---|---------------|-------------------|
| 928093905130 | MASTERC CDM-Tm Mini 35W/930 PGJ5 1CT/12 | 96 V | 39.1 W |

Approval and Application

MASTERColour CDM-Tm Mini PGJ5

| Order Code | Full Product Name | Energy Consumption kWh/1000 h | Mercury (Hg) Content (Max) | Mercury (Hg) Content (Nom) |
|--------------|---|----------------------------------|----------------------------|----------------------------|
| 928087905130 | MASTERC CDM-Tm Mini 20W/830 PGJ5 1CT/12 | 23 kWh | 2.4 mg | 2.4 mg |
| 928093905130 | MASTERC CDM-Tm Mini 35W/930 PGJ5 1CT/12 | 40 kWh | 2.7 mg | 2.74 mg |

