



Product Description

MASTERColour CDM-Tm Mini PGJ5

Miniature, single-ended ceramic metal halide lamp. PGJ5 twist-lock lamp base

Benefits

- Stable colour impression over lifetime
- High efficacy for low operating costs and low heat generation
- Long life compared with halogen lamps
- Relatively low heat output enhances comfort for shoppers and staff
- Mechanical retrofit in halogen capsule (GY6.35) luminaires (same light centre length). For full retrofit gear and lampholder also need to be exchanged
- UV Block for reduced fading risk of merchandise

Features

- Crisp, sparkling light for a comfortable atmosphere
- Low heat generation
- Warm white colour impression
- Good colour rendering
- Miniature size allows design of very compact luminaires with high beam intensities for mounting close to illuminated object
- Easy replacement due to robust twist-lock socket
- Universal burning position

Application

- Accent and display lighting with a sparkling effect
- Decorative outdoor floodlighting

MASTERCoulour CDM-Tm Mini PGJ5

Warnings and Safety

- Use only in totally enclosed luminaire, even during testing (IEC61167, IEC 62035, IEC60598)
- The luminaire must be able to contain hot lamp parts if the lamp ruptures
- Use only with electronic control gear
- Control gear must include end-of-life protection (IEC61167, IEC 62035)
- For 20W PGJ5 lamp, use only Philips electronic control gear HID PV mini PGJ5 20W
- For 35W PGJ5 lamp, use only Philips electronic control gear HID PV mini PGJ5 35W
- A lamp breaking is extremely unlikely to have any impact on your health. If a lamp breaks, ventilate the room for 30 minutes and remove the parts, preferably with gloves. Put them in a sealed plastic bag and take it to your local waste facilities for recycling. Do not use a vacuum cleaner.

Versions



LPPR CDM-Tm 0001

Dimensional drawing

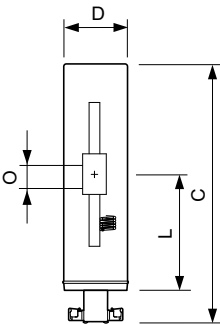

Product	D (max)	D	O	L (min)	L (max)	L	C (max)
MASTERC CDM-Tm	13.2 mm	0.44	3 mm	22.3 mm	22.9 mm	22.6	52 mm
Mini 20W/830 PGJ5		inch				mm	
1CT/12							
MASTERC CDM-Tm	13.2 mm	0.44	4 mm	22.3 mm	22.9 mm	22.6	52 mm
Mini 35W/930 PGJ5		inch				mm	
1CT/12							

MASTERColour CDM-Tm Mini PGJ5

General Information	
Cap-Base	PGJ5
Operating Position	UNIVERSAL
Light Technical	
Chromaticity Coordinate X (Nom)	0.434
Chromaticity Coordinate Y (Nom)	0.398
Color Designation	Warm White (WW)
Correlated Color Temperature (Nom)	3000 K
Controls and Dimming	
Dimmable	No
Mechanical and Housing	
Bulb Finish	Clear
Bulb Shape	T13.3

Light Technical

Order Code	Full Product Name	Color rendering	Luminous Efficacy	Luminous Flux
		index (CRI)	(rated) (Nom)	
928087905130	MASTERC CDM-Tm Mini 20W/830 PGJ5 1CT/12	87	72 lm/W	1,600 lm
928093905130	MASTERC CDM-Tm Mini 35W/930 PGJ5 1CT/12	91	77 lm/W	3,000 lm

Operating and Electrical

Order Code	Full Product Name	Voltage (Nom)	Power Consumption
928087905130	MASTERC CDM-Tm Mini 20W/830 PGJ5 1CT/12	100 V	22.1 W

Order Code	Full Product Name	Voltage (Nom)	Power Consumption
928093905130	MASTERC CDM-Tm Mini 35W/930 PGJ5 1CT/12	96 V	39.1 W

Approval and Application

Order Code	Full Product Name	Energy Consumption kWh/1000 h	Mercury (Hg) Content (Max)	Mercury (Hg) Content (Nom)
928087905130	MASTERC CDM-Tm Mini 20W/830 PGJ5 1CT/12	23 kWh	2.4 mg	2.4 mg
928093905130	MASTERC CDM-Tm Mini 35W/930 PGJ5 1CT/12	40 kWh	2.7 mg	2.74 mg

