

# Long-lasting, reliable solution

## HID-HighPower for SON/MH/HPL/HPI

Encapsulated ballasts for use with SON (T) (Plus), HPL, HPI and MH lamps with rated wattages of 1000 W and above

### Benefits

- Protected from overheating – outstanding product lifetime of 15 years average
- Minimal watt losses thanks to orthocyclic winding process
- Ideal for pole mounting

### Features

- Excellent resistance to chemical impact, humid conditions and environmental stress crack
- Class I rated (i.e. with earthing facility)
- Equipped with screw terminal blocks as standard
- Separate earth terminal (HID 'Heavy Duty')
- Ballasts for alternative mains voltages/frequencies available upon request

### Application

- Outdoor lighting (most popular application areas: sports and area lighting)

# HID-HighPower for SON/MH/HPL/HPI

## Versions



GPBR BSN-HP L02 L43 L78 PHL

## Dimensional drawing

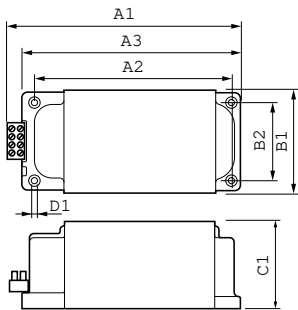

Product	D1	C1	A1	A2	A3	B1	B2
BSN 1000 L78-A2	6.5	102.0	257.0	222.0	246.0	117.0	88.0
230/240V 50Hz	mm	mm	mm	mm	mm	mm	mm
HP-257							

