



The ultra-thin downlight for general lighting applications with limited build-in height

Greenup Slim Downlight

Greenup Slim downlight is ultra-thin product for general lighting applications with limited build-in height, which is suitable for a series of Lighting applications in Office, Retail and General Area Lighting. Available in a wide variety of lumen packs, cut out size, color temp and dimming option (ETO approach).

Benefits

- Compact design for better integration with the building
- Comfortable light with high efficiency
- Reliable performance for indoor applications
- Connected lighting and future-proof smart technology

Features

- Lumen package: 600lm, 1000lm, 1500lm, 2100lm
- Cut out size: 3", 5", 6", 8"
- CCT: 3000K / 4000K
- CRI: 80
- On/off (DALI, 1-10V ETO)
- Lifetime: 50,000hours L70 Ta 25°C

Greenup Slim Downlight

Application

- Office Building
- Retail
- Hospitality

Versions



Greenup Slim downlight

Dimensional drawing

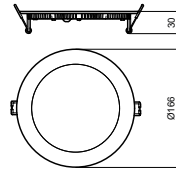
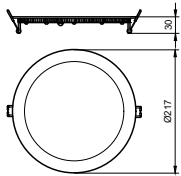

Greenup Slim Downlight

General Information	
Driver included	Yes
Number of gear units	1 unit
Service tag	Yes
Light Technical	
Beam angle of light source	- degree(s)
Correlated Color Temperature (Nom)	3000 K
Color rendering index (CRI)	>80
Luminous Efficacy (rated) (Nom)	100 lm/W
Optic type	-
Operating and Electrical	
Protection class IEC	Safety class II
Input Voltage	220 to 240 V
Line Frequency	50 or 60 Hz
Suitable for random switching	No
Controls and Dimming	
Dimmable	No
Maximum dim level	Not applicable
Mechanical and Housing	
Optical cover type	Polycarbonate Diffuser
Housing Color	White
Mech. impact protection code	IK02
Ingress protection code	IP20
Approval and Application	
Ambient temperature range	-20 to +40 °C
CE mark	Yes
ENEC mark	-
Flammability mark	-
Glow-wire test	Temperature 650 °C, duration 30 s
Initial Performance (IEC Compliant)	
Initial chromaticity	SDCM<5
Luminous flux tolerance	+/-10%
Over Time Performance (IEC Compliant)	
Driver failure rate at 5000 h	0.0015 %
Median useful life L80B50	35,000 hour(s)
Median useful life L90B50	16,000 hour(s)

Light Technical

Order Code	Full Product Name	Luminous Flux
911401803780	DN150B LED15S 830 PSU GM	1,500 lm
911401804180	DN150B LED20S 830 PSU GM	2,100 lm

Operating and Electrical

Order Code	Full Product Name	Power Consumption
911401803780	DN150B LED15S 830 PSU GM	15 W

Order Code	Full Product Name	Power Consumption
911401804180	DN150B LED20S 830 PSU GM	21 W

Greenup Slim Downlight

