

Robust design, compact form

HF-Matchbox Red

HF-Matchbox Red is an affordable, reliable, compact, lightweight and high-frequency ballast for use with system wattages below 25 W in combination with TL mini, TL-D, TL5 and TL5c, PL-T/C, and PL-L/S lamps. The HF-M Red range has a robust design, meets all relevant international safety and performance standards and has an energy efficiency index (CELMA EEI) of A2.

Benefits

- Can be operated with movement-detection control systems.
- Automatic restart (after voltage dip or lamp exchange) ensures easy operation and hassle-free re-lamping.
- Suitable for use in class I or class II luminaires

Features

- Over 60,000 on/off switches on one lamp (depending on lamp/ballast combination)
- Suitable for emergency DC operation between 190 and 254 V
- Programmed, flicker-free, pre-heated start (<0.8 s) which allows the lamp to be switched on and off without reducing useful lamp life

Application

- Used with movement-detection control systems like Philips OccuPlus
- Mainly for indoor applications such as spotlights, downlights, light boxes, and emergency and security fixtures used largely in retail stores, office buildings, hotels, private homes and residential buildings
- Domestic applications such as outdoor garden lighting, garage areas, stairways

HF-Matchbox Red

Versions

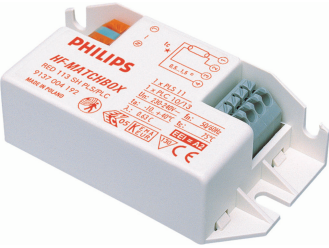

GPPR_MTL-SHRD_0002-Product photo

Dimensional drawing

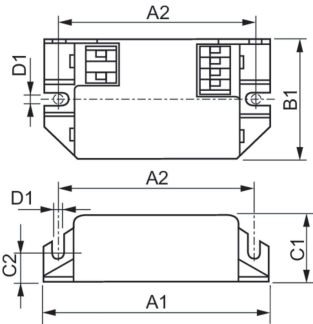

| Product | D1 | C1 | C2 | A1 | A2 | B1 |
|------------------------------------|--------|------|------|------|------|------|
| HF-M RED 114 SH | 4.2 mm | 22.0 | 10.0 | 80.0 | 70.0 | 40.0 |
| TL/TL5/PL-C/S 230-240V | | mm | mm | mm | mm | mm |
| HF-M RED 118 SH PL-C/PL-T 230-240V | 4.4 mm | 22.0 | 10.0 | 80.0 | 70.0 | 40.0 |
| T 230-240V | | mm | mm | mm | mm | mm |
| HF-M RED 124 SH | 4.4 mm | 22.0 | 10.0 | 94.0 | 70.0 | 40.0 |
| TL/TL5/PL-L 230-240V | | mm | mm | mm | mm | mm |

| Operating and Electrical | |
|--------------------------|--------------|
| Input Frequency | 50 to 60 Hz |
| Input Voltage | 230 to 240 V |
| Line Frequency | 50 to 60 Hz |
| Mechanical and Housing | |
| Housing | SH |

Operating and Electrical

| Order Code | Full Product Name | Number of Products on MCB (16A Type B) (Nom) |
|--------------|--|--|
| 913700420666 | HF-M RED 124 SH TL/TL5/PL-L 230-240V | 48 |
| 913700423266 | HF-M RED 114 SH TL/TL5/PL-C/S 230-240V | 101 |

| Order Code | Full Product Name | Number of Products on MCB (16A Type B) (Nom) |
|--------------|------------------------------------|--|
| 913700423466 | HF-M RED 118 SH PL-C/PL-T 230-240V | 73 |

