



# Beyond functionality

## Salvador Brackets

The Salvador bracket gives a dynamic look to a luminaire ensemble thanks to an extended, underlined, wavy shape.

### Benefits

- Compatible with our Accante range of conical poles
- Compatible with all Philips standard and advanced public lighting systems

### Features

- Available in single arm, double arm, pole-mounting and wall-mounting versions
- Length range: 750, 1000 or 1400mm
- Luminaire fixing: side-entry
- Optional luminous cap on the backside

### Application

- Residential areas
- City centers, commercial districts
- Roads and streets

### Versions

Salvador DA bracket-JRB350  
S1400



Salvador Pole Wall bracket-  
JRB350 S1000



# Salvador Brackets

## Versions

Salvador DA bracket-JRB350  
S1000



Salvador SA bracket-JRB350  
S1400



Salvador SA bracket-JRB350  
S1000



## Dimensional drawing

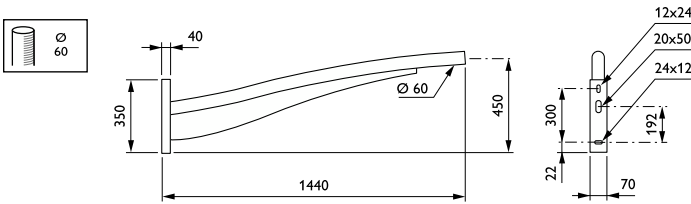
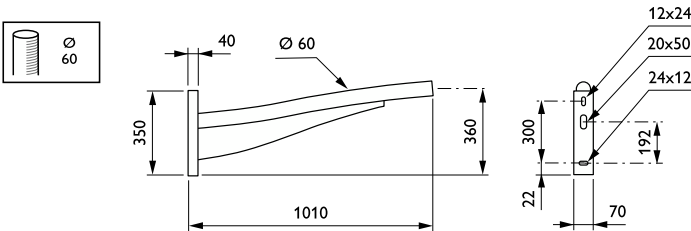
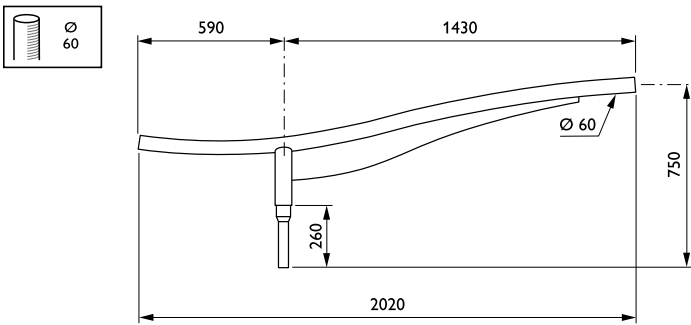
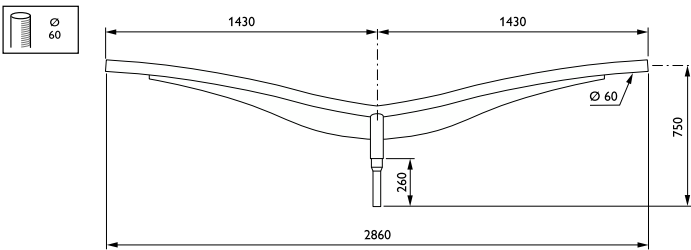

Salvador Brackets

Dimensional drawing

