



# Functional simplicity

## Batio brackets

The Batio bracket adds a simple yet elaborated touch to an environment thanks to its double drawstring design. The diversity of its mounting setups allows cohesion and adjustment to a landscape, whether it is a suburban, residential area or a busier district.

### Benefits

- Compatible with our Accante range of conical poles
- Compatible with all Philips standard and advanced public lighting systems

### Features

- Available in single arm, double arm, pole-mounting and wall-mounting versions
- Length range: 600 or 1000mm
- Luminaire fixing: side-entry

### Application

- Roads and streets
- Living areas, suburban zones
- Commercial districts
- City centers

Batio brackets

Versions

BATIO SINGLE ARM BRACKET  
S600 JRP311



BATIO DOUBLE ARM BRACKET  
S600 JRP311



BATIO POLE BRACKET S600  
JRP311



BATIO DOUBLE ARM BRACKET  
S1000 JRP311



BATIO POLE BRACKET S1000  
JRP311



BATIO SINGLE ARM BRACKET  
S1000 JRP311



BATIO\_WALL\_BRACKET\_S1000\_J  
RP311-SPP.TIF



BATIO WALL BRACKET S600  
JRP311



Batio brackets

Dimensional drawing

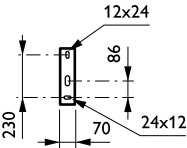
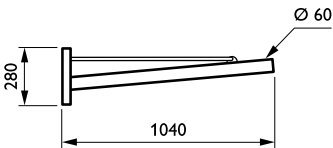
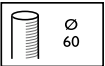
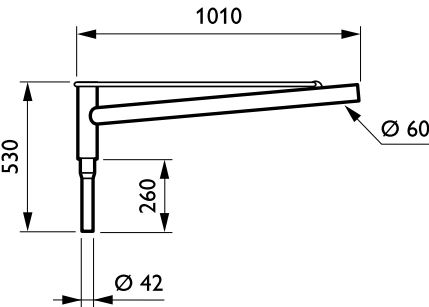
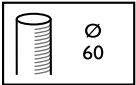
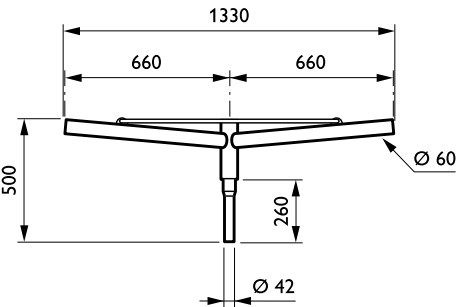
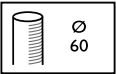
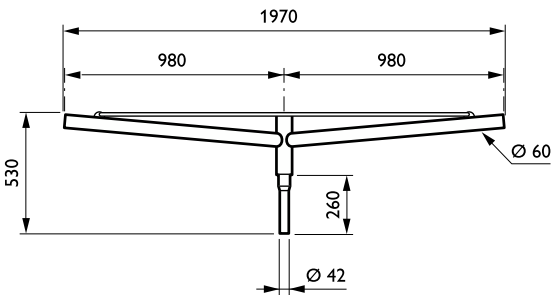
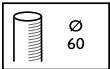
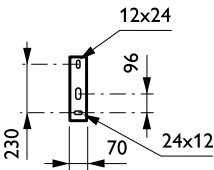
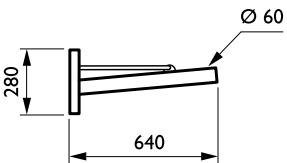
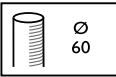
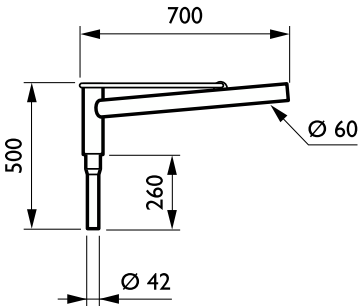
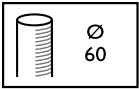
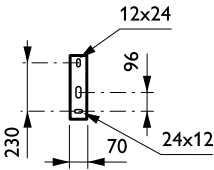
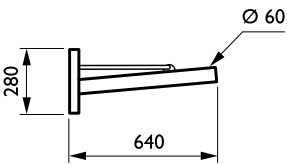
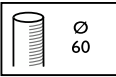

## Batio brackets

