



# Energy saving without compromise

## GreenPerform Troffer

GreenPerform troffer improves the compact design of the last generation with performance improvement and more variants for different markets. Integrating with all available system: POE, InterAct office wireless, InterAct Office Pro, ActiLume controller, GreenPerform troffer offers additional energy saving and connected features.

### Benefits

- Upgrade to smart office with more options
- Energy saving
- Slim housing
- Comfortable light
- Good light quality
- Office compliant
- Reliable performance

### Features

- Compatible with all available Philips systems
- Efficacy up to 125lm/W
- Slim design with height less than 46mm
- Improved optical design without zebra effect
- CRI > 80, SDCM<4, Flicker free
- UGR 19 available
- Lifetime L70 50,000 hours

### Application

- Open Office
- Public Area
- Meeting Room
- Training Room

Specifications

Ceiling type	T-bar ceiling
Mains Voltage	220-240V / 50-60Hz
Dimming	PSU: non-dimmable
	PSD: Dimmable via Dali-broadcasting
	WIA: Wireless control, compatible with Interact
	SIA: Wireless control, compatible with Interact and with SNS210 sensor
Control system input	Dali

Lumen maintenance at median useful life	L70B50 50.000h
Correlated color temperature - CCT	840 865
UGR	19 is available through certain types
Installation	Recessed

Versions



GreenPerform Troffer RC100B 30x120

Dimensional drawing

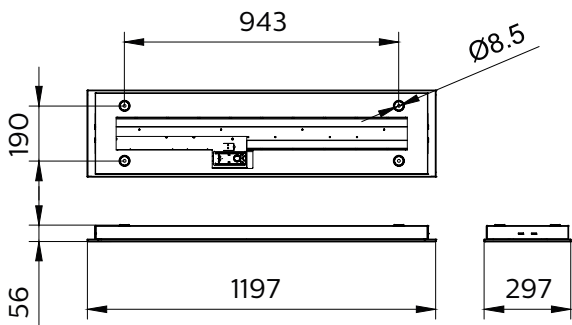
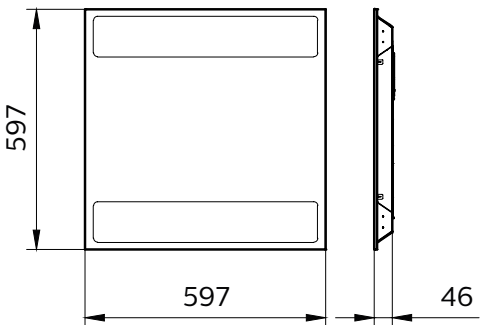
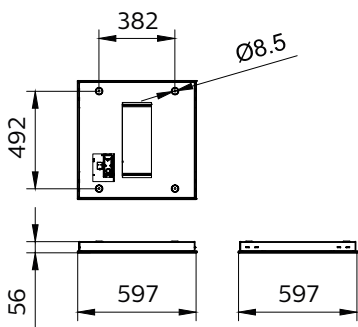
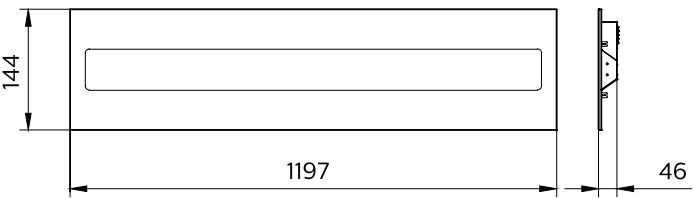

## General Information

Driver included	Yes
Light source replaceable	No
Number of gear units	1 unit
Service tag	Yes

## Light Technical

Correlated Color Temperature (Nom)	4000 K
Color rendering index (CRI)	80

## Operating and Electrical

Protection class IEC	Safety class I
Input Voltage	220 to 240 V
Line Frequency	50 to 60 Hz
Suitable for random switching	No

## Mechanical and Housing

Optical cover type	Variable linear-lens array in polycarbonate cover
Housing Color	White
Mech. impact protection code	IK03
Ingress protection code	IP20

## Approval and Application

Ambient temperature range	-20 to +40 °C
CE mark	Yes
Flammability mark	For mounting on normally flammable surfaces
Glow-wire test	Temperature 600 °C, duration 30 s

## Initial Performance (IEC Compliant)

Initial chromaticity	SDCM<4
Luminous flux tolerance	+/-10%

## Light Technical

Order Code	Full Product Name	Luminous Efficacy (rated) (Nom)	Luminous Flux
911401513351	RC100B LED37S 840 W30L120 PSU G3	116 lm/W	3,700 lm
911401519451	SM100C LED37S 840 W30L120 PSU G3	116 lm/W	3,700 lm
911401508451	RC100B LED27S 840 W60L60 PSU G3	117 lm/W	2,700 lm
911401510151	SM100C LED37S 840 W60L60 PSU G3	116 lm/W	3,700 lm
911401510751	RC100B LED37S 840 W60L60 PSU G3	116 lm/W	3,700 lm
911401511151	RC100B LED37S 840 W60L60 PSD G3	116 lm/W	3,700 lm

## Operating and Electrical

Order Code	Full Product Name	Power Consumption
911401513351	RC100B LED37S 840 W30L120 PSU G3	32 W
911401519451	SM100C LED37S 840 W30L120 PSU G3	32 W
911401508451	RC100B LED27S 840 W60L60 PSU G3	23 W

Order Code	Full Product Name	Power Consumption
911401510151	SM100C LED37S 840 W60L60 PSU G3	32 W
911401510751	RC100B LED37S 840 W60L60 PSU G3	32 W
911401511151	RC100B LED37S 840 W60L60 PSD G3	32 W

## Controls and Dimming

Order Code	Full Product Name	Dimmable
911401513351	RC100B LED37S 840 W30L120 PSU G3	No
911401519451	SM100C LED37S 840 W30L120 PSU G3	No
911401508451	RC100B LED27S 840 W60L60 PSU G3	No

Order Code	Full Product Name	Dimmable
911401510151	SM100C LED37S 840 W60L60 PSU G3	No
911401510751	RC100B LED37S 840 W60L60 PSU G3	No
911401511151	RC100B LED37S 840 W60L60 PSD G3	Yes

