

FlexBlend – Unlocking the potential of LED lighting in offices

FlexBlend Recessed

Office owners and staff responsible for lighting operations are searching for high quality yet energy-efficient lighting that complies with norms and regulations. Designed to support these needs, Philips FlexBlend is enabling building owners to fully optimize their lighting operations, by offering office-compliant lighting with an attractive return on investment. Furthermore, FlexBlend provides the required flexibility by being easy applied on different ceiling types as well as in different office spaces like open office or meeting rooms. Though technology is changing fast, the ideal lighting solution is also expected to be ready to incorporate innovations and future advances that can help optimize operations further. For this reason, Philips FlexBlend is also ready to be connected to controls such as Actilume or used together with the Philips SpaceWise lighting system. It can also be connected to software-based lighting systems like Interact Office, which provides the luminaire with further intelligence and enables it to collect valuable data about its environment

Benefits

- High-quality office-compliant lighting
- Choice of three different exit-windows
- Fast return on investment
- Application flexibility
- Scalable and ready to be connected to controls and lighting systems

FlexBlend Recessed

Features

- Fully office-compliant (UGR <19)
- Homogenous and uniform light effect
- Dimensional variety, local options
- Various mounting options
- Integrated sensors
- Can be combined with Philips ActiLume and SpaceWise systems
- Ready to be connected to software based lighting systems such as Interact Office

Application

- Offices
- Education
- Healthcare
- Banks

Versions



FlexBlend Recessed-RC340B
W30L120 MLO VPC



FlexBlend Recessed RC340B
W60L60 PCS VPC

Dimensional drawing

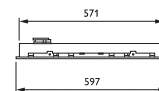
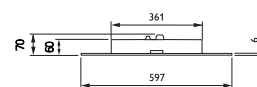
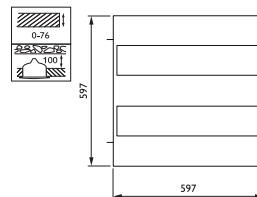
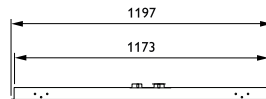
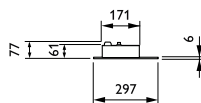

FlexBlend Recessed

Product details



FlexBlend Recessed-
RC340B_W60L60_Backcover_VP
C



FlexBlend Recessed-
RC340B_PCS_DPP



O_FlexBlend Recessed-
RC340B_W60L60_PCS_VPC



FlexBlend Recessed RC340B PIP
Open



FlexBlend Recessed-RC340B PIP
Closed

FlexBlend Recessed

| | |
|---|---|
| General Information | |
| Driver included | Yes |
| Light source replaceable | No |
| Number of gear units | 1 unit |
| Service tag | Yes |
| Light Technical | |
| Beam angle of light source | 120 degree(s) |
| Correlated Color Temperature (Nom) | 4000 K |
| Color rendering index (CRI) | ≥90 |
| Optic type | Wide beam |
| Operating and Electrical | |
| Protection class IEC | Safety class I |
| Input Voltage | 220 to 240 V |
| Line Frequency | 50 to 60 Hz |
| Suitable for random switching | Yes |
| Controls and Dimming | |
| Dimmable | Yes |
| Maximum dim level | 1% |
| Mechanical and Housing | |
| Housing Color | White |
| Mech. impact protection code | IK02 |
| Approval and Application | |
| Ambient temperature range | +10 to +40 °C |
| CE mark | Yes |
| ENEC mark | ENEC mark |
| Flammability mark | For mounting on normally flammable surfaces |
| Flickering value (PstLM) - Flickering value as per EN 61000-3-3 | 1 |
| Stroboscopic effect visibility measure (SVM) | 0.4 |
| Initial Performance (IEC Compliant) | |
| Initial chromaticity | (0.38, 0.37) SDCM ≤3 |
| Luminous flux tolerance | +/-10% |
| Over Time Performance (IEC Compliant) | |
| Driver failure rate at 5000 h | 0.01 % |
| Product Data | |
| Product family code | RC340B |

Light Technical

| Order Code | Full Product Name | Luminous Efficacy (rated) | |
|--------------|---|---------------------------|---------------|
| | | (Nom) | Luminous Flux |
| 910925867030 | RC340B 42S/940 PSD W30L120 VPC MLO W3W2 | 94.5 lm/W | 4,200 lm |
| 910925866973 | RC340B 36S/940 PSD W60L60 VPC PCS | 144 lm/W | 3,600 lm |

Operating and Electrical

| Order Code | Full Product Name | Power Consumption |
|--------------|---|-------------------|
| 910925867030 | RC340B 42S/940 PSD W30L120 VPC MLO W3W2 | 44.5 W |

FlexBlend Recessed

| Order Code | Full Product Name | Power Consumption |
|--------------|-----------------------------------|-------------------|
| 910925866973 | RC340B 36S/940 PSD W60L60 VPC PCS | 25 W |

Mechanical and Housing

| Order Code | Full Product Name | Ingress protection code |
|--------------|---|-------------------------|
| 910925867030 | RC340B 42S/940 PSD W30L120 VPC MLO W3W2 | IP20/40 |

| Order Code | Full Product Name | Ingress protection code |
|--------------|-----------------------------------|-------------------------|
| 910925866973 | RC340B 36S/940 PSD W60L60 VPC PCS | IP20/54 |

Approval and Application

| Order Code | Full Product Name | Glow-wire test |
|--------------|---|-----------------------------------|
| 910925867030 | RC340B 42S/940 PSD W30L120 VPC MLO W3W2 | Temperature 650 °C, duration 30 s |

| Order Code | Full Product Name | Glow-wire test |
|--------------|-----------------------------------|-----------------------------------|
| 910925866973 | RC340B 36S/940 PSD W60L60 VPC PCS | Temperature 850 °C, duration 30 s |

Polar Wide Diagrams

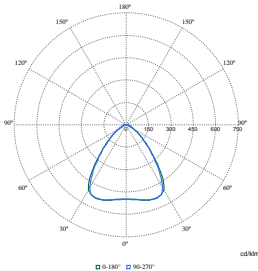
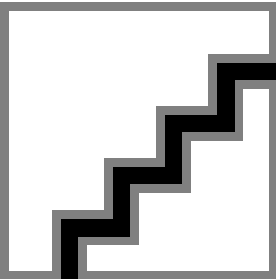

Polar Normal (separate) - RC340BI - 910925867030

Polar Normal (separate) - RC340BI - 910925866973

