



The ultimate in retail flexibility and performance

StyliD Evo

With StyliD Evo, retailers can enjoy the superior quality of light and market-leading energy efficiency of PerfectAccent optics in a series of flexible and future-proof projectors. StyliD Evo projectors are easy to reconfigure with quick and easy optic upgrades that require no tools. They also support frequent changes in store layouts, as the StyliD Evo projector can be easily repositioned on the track or Maxos fusion backbone. Covering a wide range of lighting applications, from lower light levels in convenience formats to high-ceiling installations where very high light output is required, StyliD offers continuity for every retail concept. StyliD Evo can be mounted on 3C or DALI track (ST770T, ST780T), on Maxos fusion (ST770S, ST780S, ST770X), or into the ceiling with a semi-recessed version (ST770B). All StyliD Evo projectors with PerfectAccent reflectors are certified as a circular lighting product and offer multiple system integration and dimming options, including wired as well as wireless. For prolonged shelf life and better visual representation of food, reducing food waste and increasing sales, fresh food LED lighting recipes are available. Check out our Fashion and Food catalog pages to find out more about PremiumWhite, PremiumColor, Fresh Meat, Rosé, Frost and Champagne.

Benefits

- Attract shoppers with more sparkle and superior eye comfort
- Easy to reposition and upgrade for frequent store updates
- Best-in class efficacy to reduce carbon footprint and save on energy use
- Certified as circular lighting with PerfectAccent high-efficacy reflectors

Features

- Easy optic replacement or upgrades that require no tools
- Available with PerfectAccent high-efficacy reflectors
- Optional front glass (advised in dusty environments)
- Up to 6000 lm output for high installation heights
- Available with fresh food LED lighting recipes and LED flavors
- Wired (DALI) and wireless connectivity options
- High intensity oval beam allows increased luminaire spacing when lighting fresh food counters or wordmarks on the wall

Application

- Convenience stores
- Supermarkets & hypermarkets
- Large Retail formats

Warnings and Safety

- All photometrical data is calculated without optional front glass. Flux should be reduced by 3.5% when using a front glass
- Cleaning of the optic should only be done with pressurized air. Touching the LED or reflector is forbidden. For food preparation areas and areas with high levels of dust, the use of the optional front glass is strongly advised, as it can be cleaned with a (dry) microfiber cloth.
- During maintenance, the product must be switched off and cooled down
- The product must be installed out of arm's reach. Manipulating the product when hot is only possible with an insulated glove

Versions



StyliD Evo Compact HR

Dimensional drawing

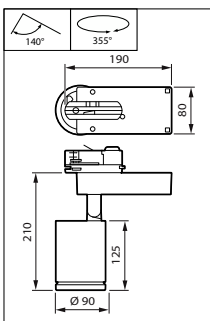

Product details



StyliD Evo Compact HR



StyliD Evo Compact HR white

Polar Wide Diagrams

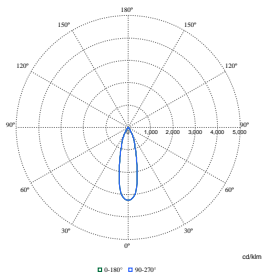

Polar Normal (separate) - ST770TI - 910505101391

