

PHILIPS

Ledinaire Waterproof

WT065C G3

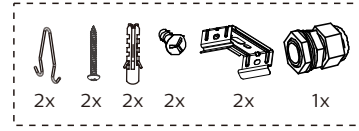
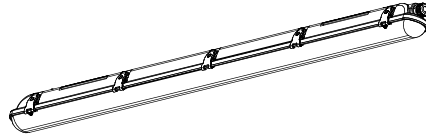

220V
240V

50Hz
60Hz

IP65

IK08

Max. 40°C
Min. -20°C



LIFE
75K hrs
@L70

GLOW WIRE
850°C

Product Description	CCT(K)	System light output(Lm)	P(W)	Energy Efficiency Class of Light source	Dimensions (mm)		kg
					L	A	
WT065C G3 LED18S/840 PSU L600 BN	4000	1800	16	D	607	210-350	0.75
WT065C G3 LED24S/840 PSU L1200 BN		2400	22	D	1207	660-880	1.10
WT065C G3 LED48S/840 PSU L1200 BN		4800	44	D	1207	660-880	1.15
WT065C G3 LED35S/840 PSU L1500 BN		3500	31	D	1507	960-1160	1.35
WT065C G3 LED68S/840 PSU L1500 BN		6800	53	C	1507	960-1160	1.40
WT065C G3 LED74S/840 PSU L1500 BN		7400	54	C	1507	960-1160	1.40

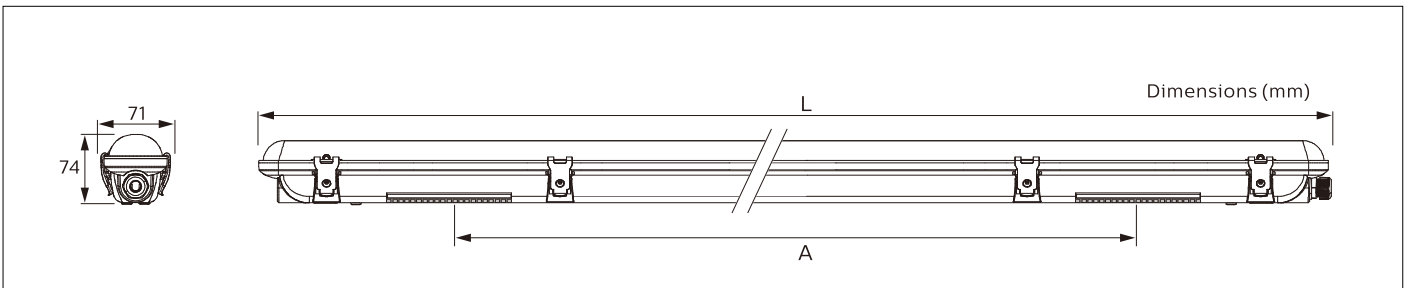

	LED18S	LED24S	LED48S	LED35S	LED68S	LED74S
Imax	14.5	15.8	18.6	15.8	17.2	17.2
Tref [µs]	182	175	153	175	172	172
Max. Nr of products						
Drivers/ MCB16A type B [max.]	72	50	36	50	31	31
Drivers/ MCB10A type B [max.]	45	32	23	32	20	20
Drivers/ MCB16A type C [max.]	122	85	61	85	53	53
Drivers/ MCB10A type C [max.]	75	52	37	52	32	32

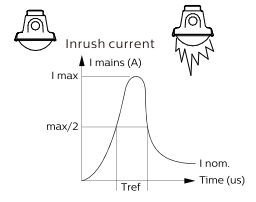

- The luminaire shall be installed by a qualified electrician and wired in accordance with the latest IEE electrical regulations or the national requirements. The light source contained in this luminaire shall only be replaced by the manufacturer or his service agent or a similar qualified person.
- Do not store/install/use the luminaire in corrosive environment with hazardous substances, e.g., sulphur, chlorine, phthalates etc., or on the location where it is exposed to conductive dust, heavily grease (esp. mineral oil or distillates, e.g., petroleum), heavily naphthenic treated with hydrogen.
- This product is not suitable for cold & humid storage areas, especially where obvious temperature gradients are present, such as ventilation opening, door, etc.
- Do not install the luminaire on the location where it is exposed to direct sunlight. UV radiation will damage the material over time, resulting in loss of waterproof sealing and IP65 rating.
- Do not stare into LED light beam.

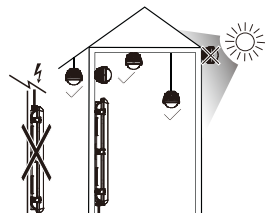

1

Type	L600	L1200	L1500
A	210-350	660-880	960-1160

Please use either of these two holes for installation

2

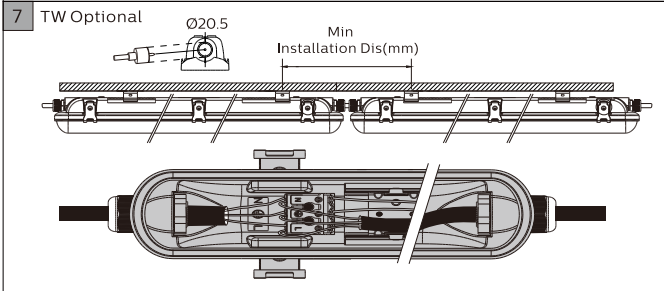
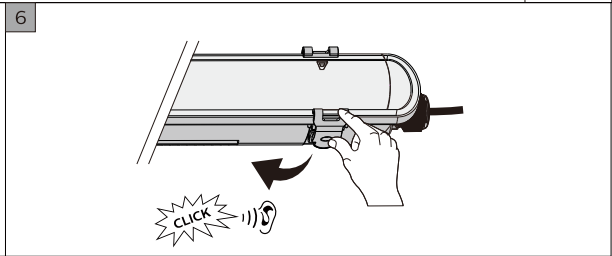
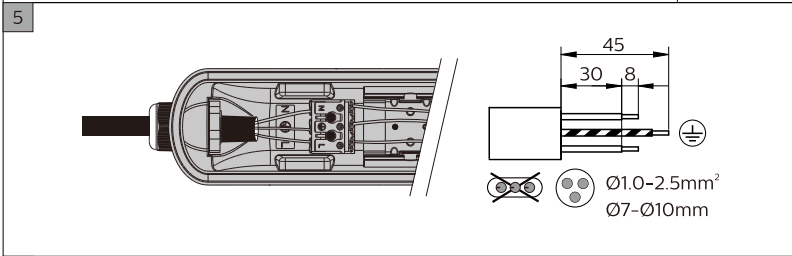
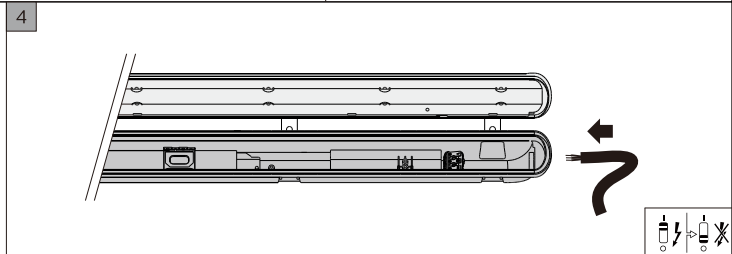
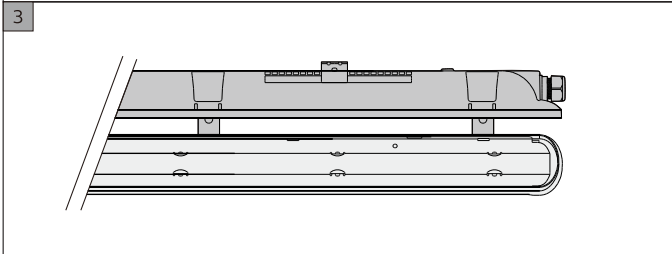

Model	Min installation distance(mm)
WT065C G3 LED185/840 PSU L600 BN	275
WT065C G3 LED245/840 PSU L1200 BN	330
WT065C G3 LED485/840 PSU L1200 BN	330
WT065C G3 LED355/840 PSU L1500 BN	360
WT065C G3 LED685/840 PSU L1500 BN	360
WT065C G3 LED745/840 PSU L1500 BN	360

