

PHILIPS

Ledinaire
Wall-mounted

WL060V

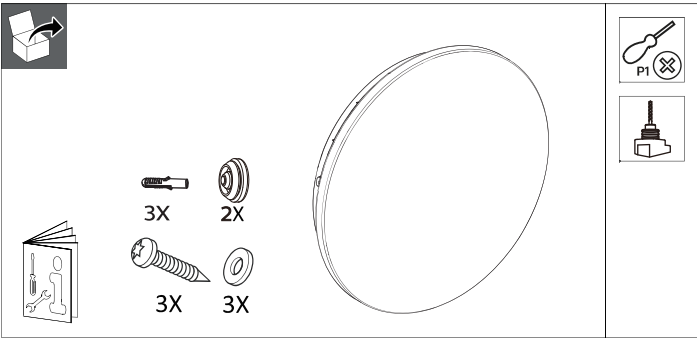

Light source of energy efficiency class		P(W)	Driver	Sensor	220V 240V	50Hz 60Hz	kg
WL060V gen2 11S/830 PSU WH IP44 D300		11	PSU	No	•	•	0.53
WL060V gen2 11S/840 PSU WH IP44 D300		11	PSU	No	•	•	0.53

Dimensions in mm

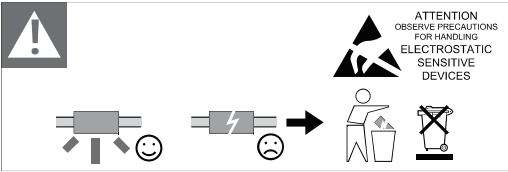
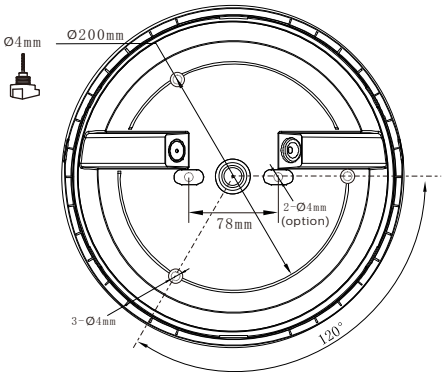
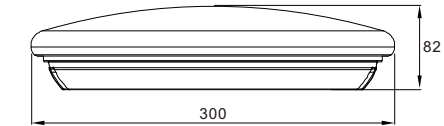

Inrush current

LED11S Electrical characteristics	
I _{max} (A)	22
T _{ref} (μs)	320
MCB	Luminaire Max.
B-10 A	11
B-13 A	15
B-16 A	18
C-10 A	19
C-13 A	24
C-16 A	31

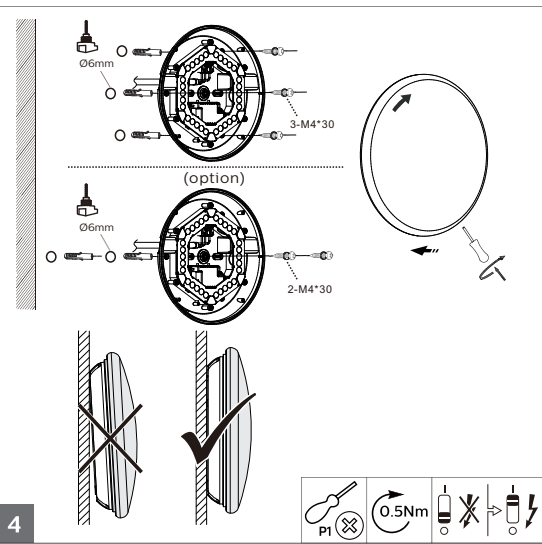
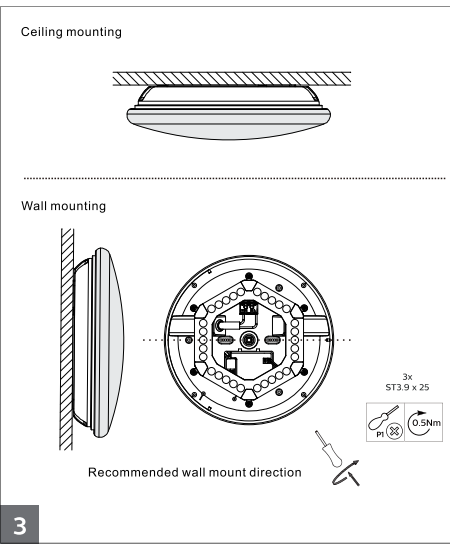
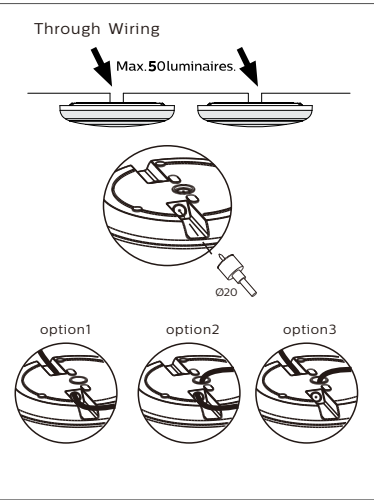
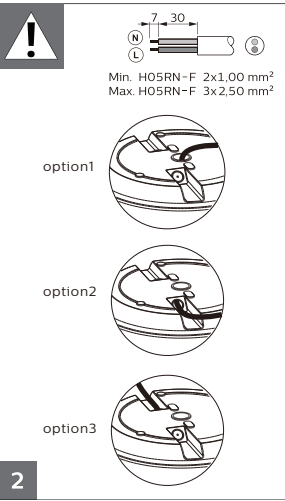
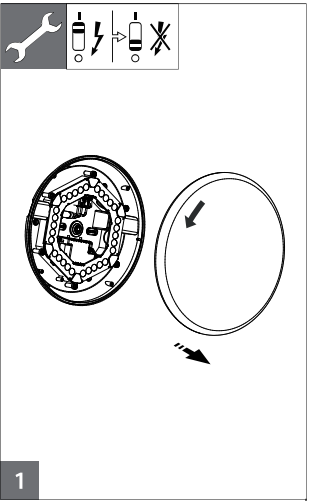
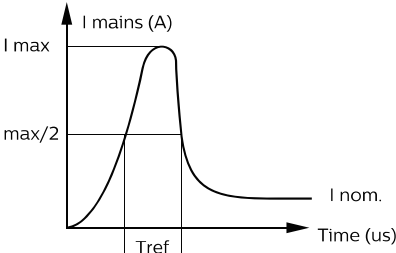

© 2025 Signify Holding.
All rights reserved. This document contains information relating to the product portfolio of Signify which information may be subject to change. No representation or warranty as to the accuracy or completeness of the information included herein is given and any liability for any action in reliance thereon is disclaimed. The information presented in this document is not intended as any commercial offer and does not form part of any quotation or contract. Philips and the Philips Shield Emblem are registered trademarks of Koninklijke Philips N.V.. All other trademarks are owned by Signify Holding or their respective owners.

Signify Holding.
The Netherlands

