

8 max. number of connected luminaire(see Inrush current table)

Inrush current

	L600		L1200		L1500		L1800	
	LED24S LED15S	LED25S LED41S LED64S	LED35S LED52S LED80S	LED64S LED100S				
Electrical characteristics								
Inom (mA)	78	80 140 220	115 180 260	220 330				
I _{max} (A)	8.3	8.3 11.6 14.4	10 10.6 15.7	15.7 17.6				
T _{ref} (μs)	345	332 499 579	508 527 678	648 832				
MCB Luminaire Max.								
B-10 A	19	19 11 8 12	11 6 6 5					
B-16 A	25	25 13 9 16	13 8 8 7					
C-10 A	24	24 13 10 16	14 8 8 6					
C-16 A	38	38 22 16 25	23 14 14 11					

Optional

Installation Mode	Suspension
12NC	911401776802
Description	BN126Z SC
Short EOC	36574999

12NC 911401853487
Description EM300V ELC HV 6.4V 2000mAh LFP
Short EOC 74936899

12NC 912401483603
Description EM300V ELB_ELP3 kit HV 6.4V 2000mAh LFP
Short EOC 98610099

Suspension Wire: 1m
See step 2.2 for installation

Only applicable to L1200 and L1500

Signify Holding.
 All rights reserved. This document contains information relating to the product portfolio of Signify which information may be subject to change. No representation or warranty as to the accuracy or completeness of the information included herein is given and any liability for any action in reliance thereon is disclaimed. The information presented in this document is not intended as any commercial offer and does not form part of any quotation or contract. Philips and the Philips Shield Emblem are registered trademarks of Koninklijke Philips N.V.. All other trademarks are owned by Signify Holding or their respective owners.

PHILIPS

CoreLine Batten

BN126C

CE **RoHS** **UK CA** **EAC** **Indoor** **Life up to 100K hrs L70** **220V 240V** **50Hz 60Hz** **IK04** **IP20** **Max 40°C Mini -20°C** **Ta 25°C**

Type	Energy efficiency class	P (W)	Lumen output (lm)	A (mm)	L (mm)	kg
BN126C LED15S_24S/830_40_65 PSU L600	E	10.8/17	1500/2400	497	600	0.62
BN126C LED25S_41S/830_40_65 PSU L1200	E	18/29.5	2500/4100	798	1135	1.03
BN126C LED35S_52S/830_40_65 PSU L1500	E	25/37	3500/5200	798	1450	1.23
BN126C LED64S_100S/830_40_65 PSU L1800	E	45.5/71	6400/10000	798	1750	1.48
BN126C LED64S/830_40_65 WIA L1200	E	45.5	Max 6400	798	1135	1.11
BN126C LED80S/830_40_65 WIA L1500	E	57	Max 8000	798	1450	1.11
BN126C LED64S/830_40_65 PSD L1200	E	45.5	Max 6400	798	1135	1.31
BN126C LED80S/830_40_65 PSD L1500	E	57	Max 8000	798	1450	1.31

Unit: mm

A: Mounting distance-L600

A: Mounting distance-L1200, L1500, L1800

Fixed or Suspension Mounting Holes

MultiLumen switch (2-in-1) - option.
Please switch off the mains before changing the lumens.
 See the Product Spec & list.

Life time table	
L85 50k hrs	All
L80 75K hrs	4100-5200lm
L70 up to 100K hrs	1500-3500lm

2nd set of installation holes For L1800

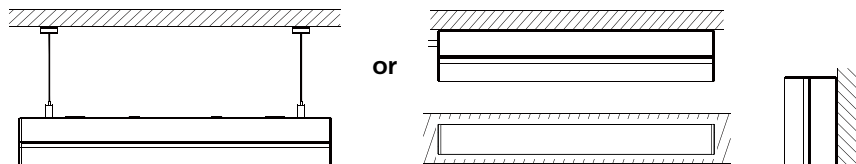
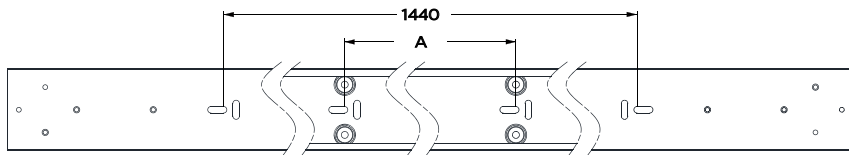

! -The luminaire shall be installed by a qualified electrician and wired in accordance with the latest IEE electrical regulations or the national requirements.

- The light source of this luminaire is not replaceable; when the light source reaches its end of life the whole luminaire shall be replaced.
- Luminaire must not be used or stored in corrosive environment where hazardous materials such as sulphur, chlorine, phthalates, etc., are present.
- This luminaire is not suitable for use as emergency lighting.
- Water entering into IP20 luminaire is strictly prohibited. IP20 luminaire is not protected against wet condition, water ingress may cause electrical failure or unsafe conditions.
- Luminaire is rated at IP40 from the front (part 1) and IP20 for a complete housing (part 2).



ATTENTION
OBSERVE PRECAUTIONS
FOR HANDLING
ELECTROSTATIC
SENSITIVE
DEVICES

1: Luminaire opening

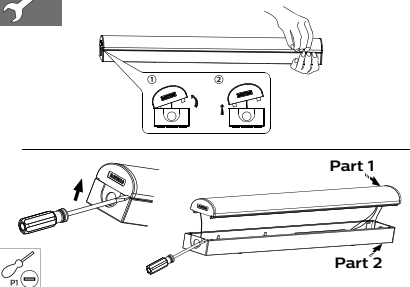

2.1: Surface Mounted

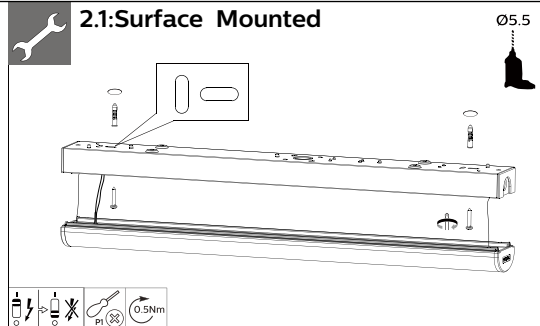

2.2: Suspend Mounted

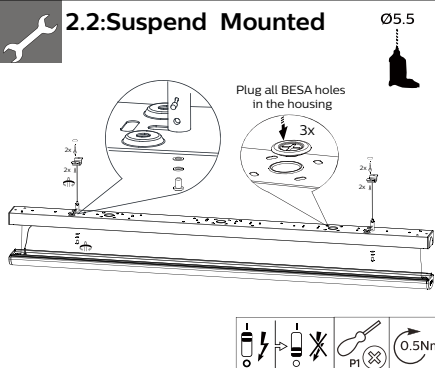

2.3: Mounted on a BESA

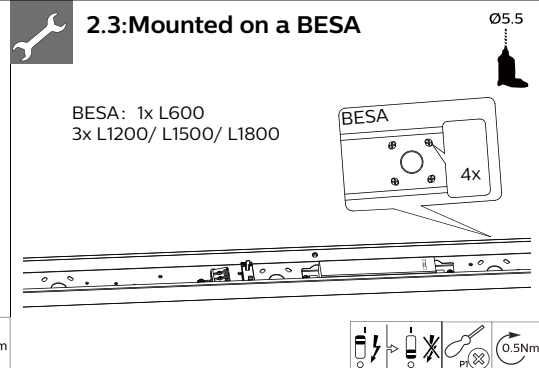

3: Wiring from end hole (side)

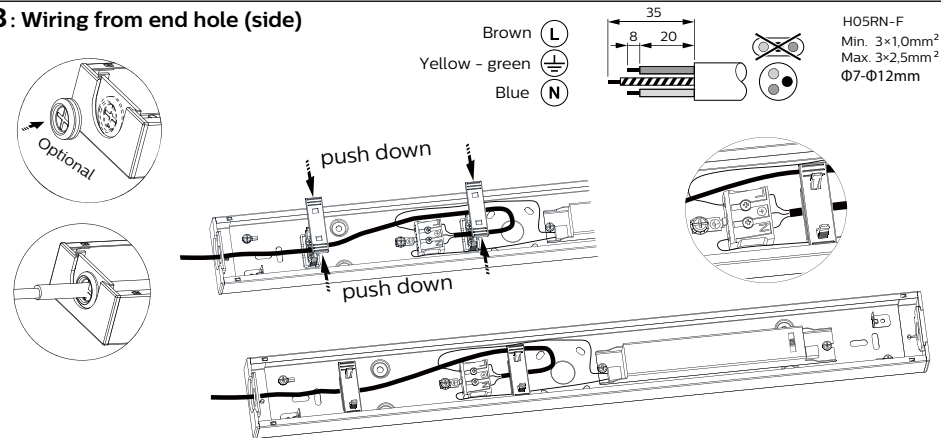

3.1: Wiring from back entry

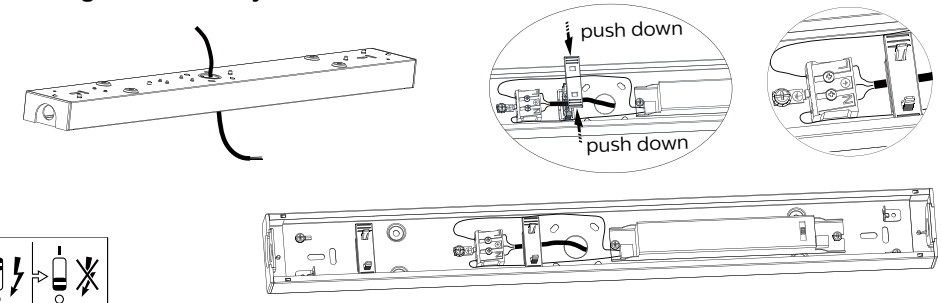

4: TW / Loop in / Light-line creation (Optional)

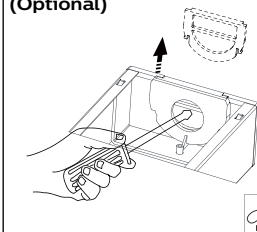

5: Light-line creation (Optional)

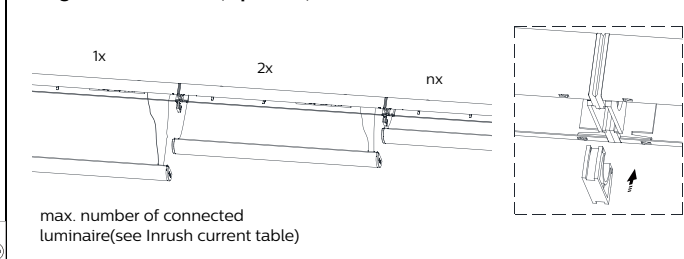

6: TW / Loop in / Light-line creation (Optional)

The power cord is not included in the luminaire

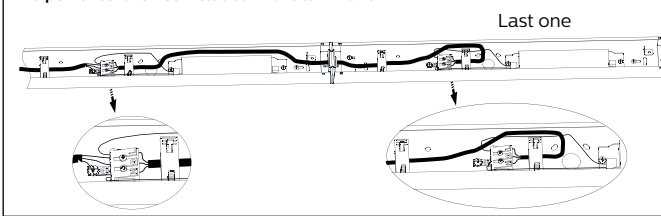

7

The end face of the first luminaire and the last luminaire

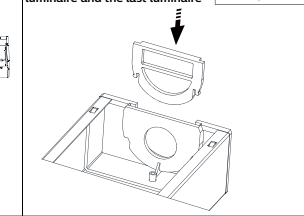

Optional

12NC	Description
912401483603	EM300V ELB_ELP3 kit HV 6.4V 2000mAh LFP
911401853487	EM300V ELC HV 6.4V 2000mAh LFP

Emergency pack is not provided.

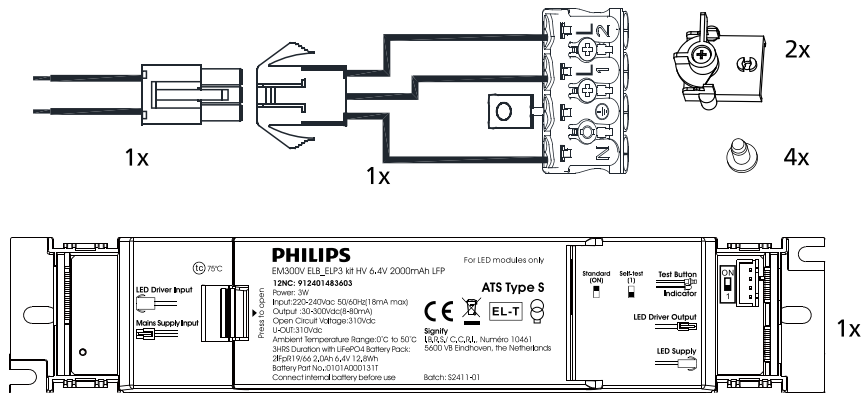

Products compatible with emergency lighting functionality.

12NC	Description	EOC	SKU
911401833984	BN126C LED41S/840 PSU L1200	871951494878599	108404533
911401834184	BN126C LED64S/840 PSU L1200	871951494880899	108404171
911401834584	BN126C LED52S/840 PSU L1500	871951494884699	108404534
911401834784	BN126C LED80S/840 PSU L1500	871951494886099	108404532
911401850087	BN126C LED80S/830_40_65 WIA L1500	872016976835299	108407827
911401850187	BN126C LED64S/830_40_65 WIA L1200	872016976836999	108407828
911401850287	BN126C LED64S/830_40_65 PSD L1200	872016976837699	108407829
911401850387	BN126C LED80S/830_40_65 PSD L1500	872016976838399	108407830
911401850587	BN126C LED25S_41S/830_40_65 PSU L1200	872016976840699	108407832
911401850687	BN126C LED35S_52S/830_40_65 PSU L1500	872016976841399	108407833

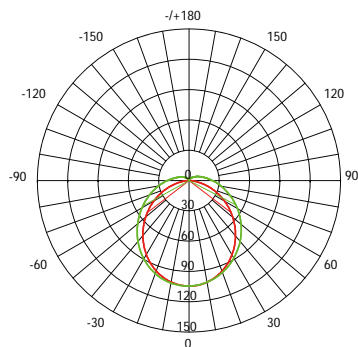

Rated lumen output in emergency mode: min 300lm

1、 Ex-factory status

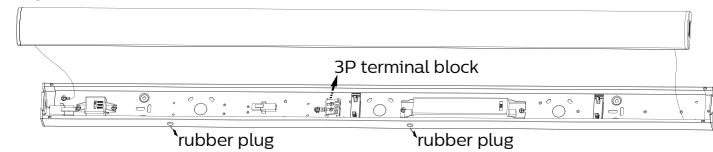

2、 2.1-Remove the rubber plug and 3P terminal block from the housing.

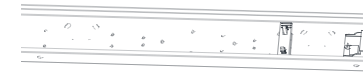

2.2- 4P terminal block to the position shown in the figure below, and then install the fixing knob of the Emergency pack.

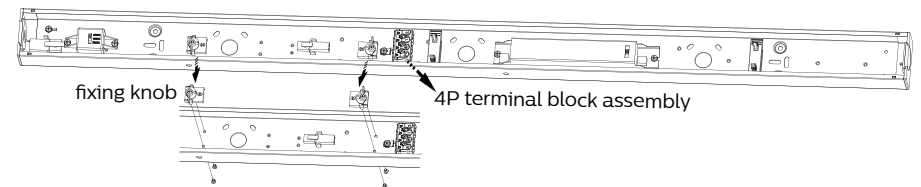

3、 Install Emergency pack, but the Emergency pack is not provided.

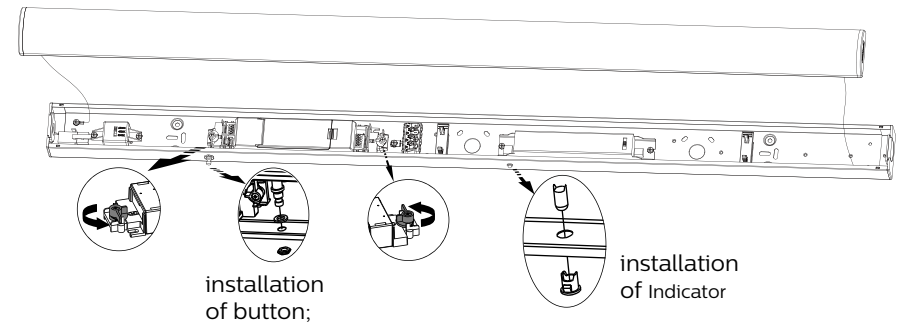

4、 Emergency wiring

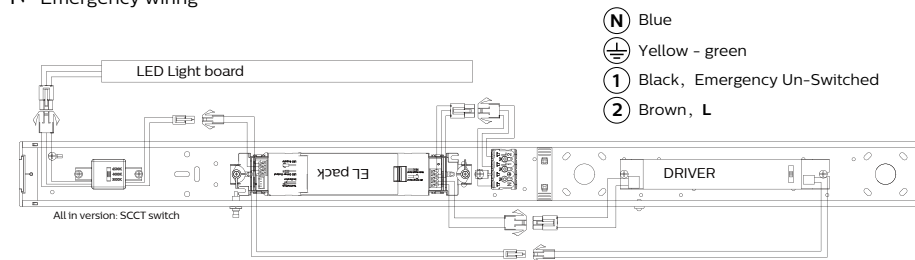

Can be assembled in the luminaires in table 1.
After installing emergency pack, customers shall ensure that the emergency light comply with IEC60598-2-22. and maximum ambiet temperature shall be less than 30C.

