

PHILIPS

Filament Bulb amber
5W (Eq.40W) ST19 E26

Smart LED

Amber

Glass

Easy plug and play

Control with WiZ app or voice

Easy to set up

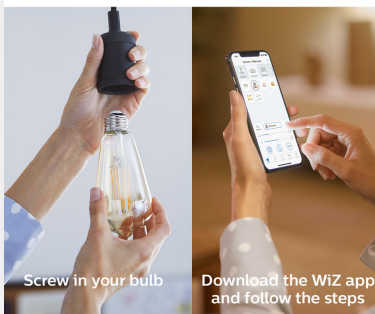

046677555566

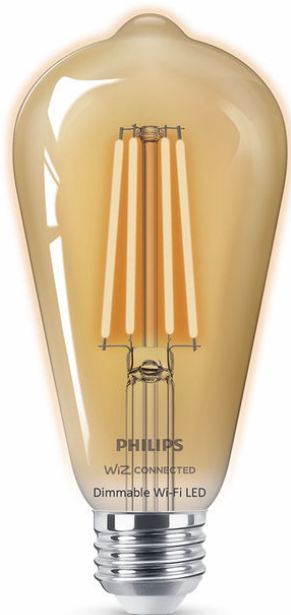

Easy-to-use smart dimmable bulb

Create the perfect atmosphere in your home with smart Wi-Fi LED lighting. This glass vintage bulb gives amber white light and dims to your desired brightness level via app or voice. A smart light that enhances room ambiance. Works with WiZ.

Easy setup

- Easy plug and play. Works with your existing Wi-Fi.

Smart control

- Control anywhere with your smartphone.
- Voice control with Google Assistant, Alexa or Siri Shortcuts

Smart features

- Smart dimming via app, voice or dimmer
- Automate your light with schedules
- Energy monitoring

Light modes

- Customize Scenes with preset dynamic light modes.

Highlights

Easy plug and play

WiZ works with your existing Wi-Fi router, no additional gateway is needed. Simply plug in your new light, download the WiZ app and you're ready to go!

Control from anywhere

Control your WiZ lights wherever you are with smartphone. No need to worry if you've left your lights on before leaving home. WiZ app is available for iOS and Android.

Voice Control

Get hands-free control of your lights by using your voice and Google Assistant, Amazon Alexa or Siri Shortcuts. Use simple voice commands to turn lights on or off, brighten and dim, change color, and set custom light Scenes.

Smart dimming

Dim your lights to your desired brightness level via your smartphone, the WiZmote or your voice. No need to install an expensive dimmer.

Automate your light with schedules

Automate the lights to fit your daily or weekly routines. Schedule your light to turn on before you arrive home and keep it off when not needed.

Energy monitoring

The WiZ app keeps records of the energy consumption of your lights. View your weekly or daily report and plan your lighting wisely for an optimized energy consumption at home.

Customized Scenes

Mix different color and white lights modes to create the perfect light ambience for your daily moment. Save it and call it out anytime with app, WiZmote or voice.

Specifications

Bulb characteristics

- Intended use: Indoor/Outdoor
- Lamp shape: ST19
- Socket: E26
- Technology: Smart Wi-Fi
- Type of glass: Amber
- Dimmable: Wireless Dim

Bulb dimensions

- Height: 13.7 cm
- Weight: 0.055 kg
- Width: 6.4 cm

Durability

- Average life (at 2.7 hrs/day): 15 year(s)
- Lumen maintenance factor: 70%
- Number of switch cycles: 20,000
- Nominal lifetime: 15,000 hour(s)

Light characteristics

- Color consistency: 6SDCM
- Color rendering index (CRI): 90
- Color temperature: 2000 K
- Light Color Category: Amber
- Nominal luminous flux: 350 lm
- Starting time: <1 s
- Warm-up time to 60% light: instant full light

Miscellaneous

- EyeComfort: No

Other characteristics

- Lamp current: 60 mA
- Efficacy: 70 lm/W

Packaging information

- EAN: 046677555566
- EOC: 555565
- Product title: 5ST19/WiFi DIM/920/VIN 4/1FB

Power consumption

- Power factor: 0.7
- Voltage: 120 V
- Wattage: 5 W
- Wattage equivalent: 40 W

Product dimensions and weight

- Length: 13.7 cm

Rated values

- Rated lifetime: 15,000 hour(s)
- Rated luminous flux: 350 lm
- Rated power: 5 W

Service

- Warranty: 5 year(s)

Technical specifications

- Frequency: 60 Hz

Packaging dimensions and weight

- EAN/UPC – product: 046677555566
- Net weight: 0.05 kg
- Gross weight: 0.11 kg
- Height: 19 cm
- Length: 9.9 cm
- Width: 7.2 cm
- Material number (12NC):
929002266303



Issue date: 2024-04-11
Version: 0.486

© 2024 Signify Holding. All rights reserved. Signify does not give any representation or warranty as to the accuracy or completeness of the information included herein and shall not be liable for any action in reliance thereon. The information presented in this document is not intended as any commercial offer and does not form part of any quotation or contract, unless otherwise agreed by Signify. Philips and the Philips Shield Emblem are registered trademarks of Koninklijke Philips N.V.

www.lighting.philips.com