



For every project where light really matters. A slim fit

CoreLine SlimDownlight

CoreLine slimdownlight delivers on the CoreLine promise of innovative, easy to use and high-quality indoor LED downlights. CoreLine slimdownlight is an innovative range of recessed and surface-mounted luminaires. It is designed to provide uniform lighting across multiple application areas. With instant energy savings and a longer lifetime, this is an environmentally friendly and cost saving solution. Its MultiColorTemp feature offers a choice of two color temperatures in a single luminaire. This makes it easy to select the right product, gives you the flexibility respond to customer preferences on site, and means fewer product codes on stock. Simple and easy installation means our slim downlight fits the same size cut-out, while the minimal built-in depth of 34mm makes this product an ideal space saving solution, especially for projects with limited fitting space. InterAct Ready option with integrated wireless communications in this family is available, to be used with InterAct gateways, sensors and software.

Benefits

- MultiColorTemp option to change color temperature on site and simplify product selection
- Energy saving and longer lifetime to reduce overall operating costs
- Covers recessed and surface-mounted installations
- Fits suspended ceilings with low space (Product height < 50mm)
- Surface of light effect creates a comfortable, uniform look

CoreLine SlimDownlight

Features

- MultiColorTemp feature: two color temperature options in a single luminaire (3000K-4000K)
- Recessed (DN145B) and surface-mounted versions (DN145C)
- Energy-efficient with a long lifespan: up to 100lm/W and 50,000 hours @L70
- Push-in connector with through-wiring option
- Multiple light output options: 650/1100/2100 lumen
- Color temperature: 3000K and 4000K
- Choice of drivers; DALI and wireless with Interact ready
- Total height (including driver): 34mm recessed; 50mm surface mounted

Application

- Corridors
- Retail stores
- Reception areas
- Restrooms
- Technical rooms

Versions



Coreline SlimDownlight-DN145C 10S



Coreline SlimDownlight-DN145C 20S

Dimensional drawing

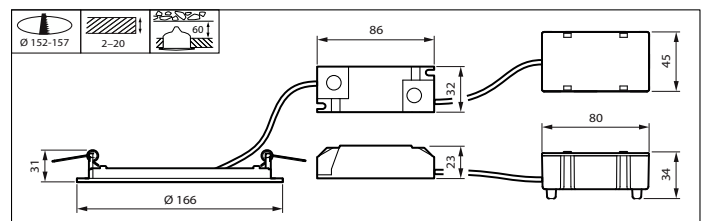
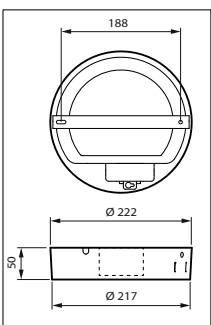

CoreLine SlimDownlight

Dimensional drawing

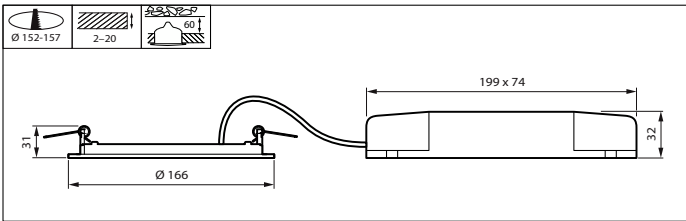
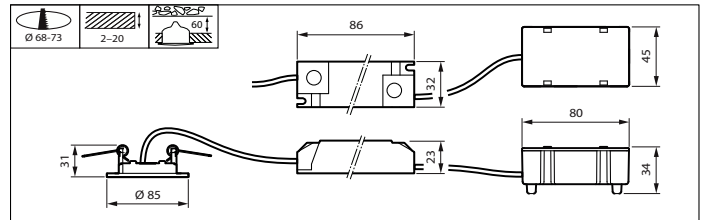
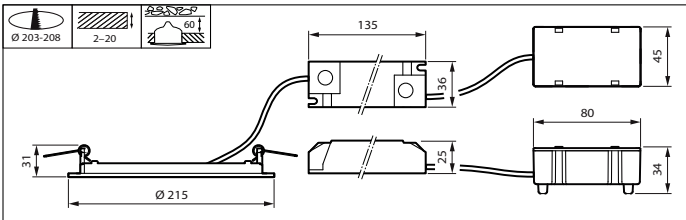
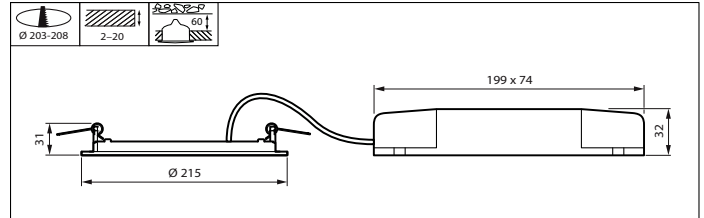
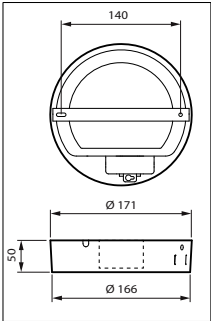

Product details

CoreLine SlimDownlight 2100lm
side view



CoreLine SlimDownlight Surface-mounted 2100lm



CoreLine SlimDownlight

Product details



Philips CoreLine SlimDownlight
Recessed DT01



CoreLine SlimDownlight 2100lm
with PSU driver and easy
connector



CoreLine SlimDownlight 2100lm



Philips CoreLine SlimDownlight
Surface DT02



Philips CoreLine SlimDownlight
Surface DT01

CoreLine SlimDownlight

General Information	
CE mark	Yes
Driver included	Yes
ENEC mark	ENEC mark
Flammability mark	For mounting on normally flammable surfaces
Glow-wire test	Temperature 650 °C, duration 30 s
Light source replaceable	No
Number of gear units	1 unit
Light Technical	
Beam angle of light source	120 degree(s)
Color rendering index (CRI)	>80
Optic type	Beam angle 90°
Flickering value (PstLM) - Flickering value as per EN 61000-3-3	1
Operating and Electrical	
Input Voltage	220 to 240 V
Line Frequency	50 or 60 Hz
Temperature	
Ambient temperature range	0 to +35 °C
Mechanical and Housing	
Housing Color	White
Approval and Application	
Protection class IEC	Safety class II
Mech. impact protection code	IK02
Initial Performance (IEC Compliant)	
Luminous flux tolerance	+/-10%
Application Conditions	
Maximum dim level	Not applicable
Suitable for random switching	Yes

General Information

Order Code	Full Product Name	Lamp family code	Product family code	Service tag
911401806380	DN145C LED10S/830 PSU II WH	LED10S	-	Yes
911401806480	DN145C LED10S/840 PSU II WH	LED10S	-	Yes
911401806580	DN145C LED20S/830 PSU II WH	LED20S	-	Yes
911401806680	DN145C LED20S/840 PSU II WH	LED20S	-	Yes
910500465903	DN145B LED20S/830 PSD-E II WH	LED20S	DN145B	Yes
910500465904	DN145B LED20S/840 PSD-E II WH	LED20S	DN145B	Yes
910505101197	DN145B LED20S/830 WIA-E WH	-	DN145B	-
910505101198	DN145B LED20S/840 WIA-E WH	-	DN145B	-
911401806180	DN145B LED20S/830 PSU II WH	LED20S	-	Yes
911401806280	DN145B LED20S/840 PSU II WH	LED20S	-	Yes
910500465901	DN145B LED10S/830 PSD-E II WH	LED10S	DN145B	Yes
910500465902	DN145B LED10S/840 PSD-E II WH	LED10S	DN145B	Yes
910505101195	DN145B LED10S/830 WIA-E WH	-	DN145B	-
910505101196	DN145B LED10S/840 WIA-E WH	-	DN145B	-
911401805980	DN145B LED10S/830 PSU II WH	LED10S	-	Yes
911401806080	DN145B LED10S/840 PSU II WH	LED10S	-	Yes
911401805780	DN145B LED6S/830 PSU II WH	LED6S	-	Yes
911401805880	DN145B LED6S/840 PSU II WH	LED6S	-	Yes

Light Technical (1/2)

Order Code	Full Product Name	Correlated Color	Optical	Luminous	Luminous Flux
		Temperature (Nom)	cover type	Efficacy (rated) (Nom)	
911401806380	DN145C LED10S/830 PSU II WH	3000 K	Opal	100 lm/W	1,100 lm
911401806480	DN145C LED10S/840 PSU II WH	4000 K	Opal	100 lm/W	1,100 lm

Order Code	Full Product Name	Correlated Color	Optical	Luminous	Luminous Flux
		Temperature (Nom)	cover type	Efficacy (rated) (Nom)	
911401806580	DN145C LED20S/830 PSU II WH	3000 K	Opal	100 lm/W	2,100 lm
911401806680	DN145C LED20S/840 PSU II WH	4000 K	Opal	100 lm/W	2,100 lm

CoreLine SlimDownlight

Order Code	Full Product Name	Correlated Color	Optical cover	Luminous Efficacy	Luminous Flux
		Temperature (Nom)	type	(rated) (Nom)	
910500465903	DN145B LED20S/830 PSD-E II WH	3000 K	Opal	93 lm/W	2,100 lm
910500465904	DN145B LED20S/840 PSD-E II WH	4000 K	Opal	93 lm/W	2,100 lm
910505101197	DN145B LED20S/830 WIA-E WH	3000 K	-	93 lm/W	2,100 lm
910505101198	DN145B LED20S/840 WIA-E WH	4000 K	-	93 lm/W	2,100 lm
911401806180	DN145B LED20S/830 PSU II WH	3000 K	Opal	100 lm/W	2,100 lm
911401806280	DN145B LED20S/840 PSU II WH	4000 K	Opal	100 lm/W	2,100 lm
910500465901	DN145B LED10S/830 PSD-E II WH	3000 K	Opal	85 lm/W	1,100 lm

Order Code	Full Product Name	Correlated Color	Optical cover	Luminous Efficacy	Luminous Flux
		Temperature (Nom)	type	(rated) (Nom)	
910500465902	DN145B LED10S/840 PSD-E II WH	4000 K	Opal	85 lm/W	1,100 lm
910505101195	DN145B LED10S/830 WIA-E WH	3000 K	-	93 lm/W	1,100 lm
910505101196	DN145B LED10S/840 WIA-E WH	4000 K	-	93 lm/W	1,100 lm
911401805980	DN145B LED10S/830 PSU II WH	3000 K	Opal	100 lm/W	1,100 lm
911401806080	DN145B LED10S/840 PSU II WH	4000 K	Opal	100 lm/W	1,100 lm
911401805780	DN145B LED6S/830 PSU II WH	3000 K	Opal	100 lm/W	650 lm
911401805880	DN145B LED6S/840 PSU II WH	4000 K	Opal	100 lm/W	650 lm

Light Technical (2/2)

Order Code	Full Product Name	Number of light sources	Stroboscopic effect
			visibility measure (SVM)
911401806380	DN145C LED10S/830 PSU II WH	1	1.6
911401806480	DN145C LED10S/840 PSU II WH	1	1.6
911401806580	DN145C LED20S/830 PSU II WH	1	1.6
911401806680	DN145C LED20S/840 PSU II WH	1	1.6
910500465903	DN145B LED20S/830 PSD-E II WH	1	0.4
910500465904	DN145B LED20S/840 PSD-E II WH	1	0.4
910505101197	DN145B LED20S/830 WIA-E WH	-	0.4
910505101198	DN145B LED20S/840 WIA-E WH	-	0.4
911401806180	DN145B LED20S/830 PSU II WH	1	1.6

Order Code	Full Product Name	Number of light sources	Stroboscopic effect
			visibility measure (SVM)
911401806280	DN145B LED20S/840 PSU II WH	1	1.6
910500465901	DN145B LED10S/830 PSD-E II WH	1	0.4
910500465902	DN145B LED10S/840 PSD-E II WH	1	0.4
910505101195	DN145B LED10S/830 WIA-E WH	-	0.4
910505101196	DN145B LED10S/840 WIA-E WH	-	0.4
911401805980	DN145B LED10S/830 PSU II WH	1	1.6
911401806080	DN145B LED10S/840 PSU II WH	1	1.6
911401805780	DN145B LED6S/830 PSU II WH	1	1.6
911401805880	DN145B LED6S/840 PSU II WH	1	1.6

Operating and Electrical

Order Code	Full Product Name	Power Consumption
911401806380	DN145C LED10S/830 PSU II WH	11 W
911401806480	DN145C LED10S/840 PSU II WH	11 W
911401806580	DN145C LED20S/830 PSU II WH	21 W
911401806680	DN145C LED20S/840 PSU II WH	21 W
910500465903	DN145B LED20S/830 PSD-E II WH	22.5 W
910500465904	DN145B LED20S/840 PSD-E II WH	22.5 W
910505101197	DN145B LED20S/830 WIA-E WH	22.5 W
910505101198	DN145B LED20S/840 WIA-E WH	22.5 W
911401806180	DN145B LED20S/830 PSU II WH	21 W

Order Code	Full Product Name	Power Consumption
911401806280	DN145B LED20S/840 PSU II WH	21 W
910500465901	DN145B LED10S/830 PSD-E II WH	13 W
910500465902	DN145B LED10S/840 PSD-E II WH	13 W
910505101195	DN145B LED10S/830 WIA-E WH	13 W
910505101196	DN145B LED10S/840 WIA-E WH	13 W
911401805980	DN145B LED10S/830 PSU II WH	11 W
911401806080	DN145B LED10S/840 PSU II WH	11 W
911401805780	DN145B LED6S/830 PSU II WH	6.5 W

CoreLine SlimDownlight

Order Code	Full Product Name	Power Consumption
911401805880	DN145B LED6S/840 PSU II WH	6.5 W

Controls and Dimming

Order Code	Full Product Name	Dimmable
911401806380	DN145C LED10S/830 PSU II WH	No
911401806480	DN145C LED10S/840 PSU II WH	No
911401806580	DN145C LED20S/830 PSU II WH	No
911401806680	DN145C LED20S/840 PSU II WH	No
910500465903	DN145B LED20S/830 PSD-E II WH	Yes
910500465904	DN145B LED20S/840 PSD-E II WH	Yes
910505101197	DN145B LED20S/830 WIA-E WH	Yes
910505101198	DN145B LED20S/840 WIA-E WH	Yes
911401806180	DN145B LED20S/830 PSU II WH	No

Order Code	Full Product Name	Dimmable
911401806280	DN145B LED20S/840 PSU II WH	No
910500465901	DN145B LED10S/830 PSD-E II WH	Yes
910500465902	DN145B LED10S/840 PSD-E II WH	Yes
910505101195	DN145B LED10S/830 WIA-E WH	Yes
910505101196	DN145B LED10S/840 WIA-E WH	Yes
911401805980	DN145B LED10S/830 PSU II WH	No
911401806080	DN145B LED10S/840 PSU II WH	No
911401805780	DN145B LED6S/830 PSU II WH	No
911401805880	DN145B LED6S/840 PSU II WH	No

Approval and Application

Order Code	Full Product Name	Ingress protection code
911401806380	DN145C LED10S/830 PSU II WH	IP44
911401806480	DN145C LED10S/840 PSU II WH	IP44
911401806580	DN145C LED20S/830 PSU II WH	IP44
911401806680	DN145C LED20S/840 PSU II WH	IP44
910500465903	DN145B LED20S/830 PSD-E II WH	IP20/44
910500465904	DN145B LED20S/840 PSD-E II WH	IP20/44
910505101197	DN145B LED20S/830 WIA-E WH	IP20/44
910505101198	DN145B LED20S/840 WIA-E WH	IP20/44
911401806180	DN145B LED20S/830 PSU II WH	IP20/44

Order Code	Full Product Name	Ingress protection code
911401806280	DN145B LED20S/840 PSU II WH	IP20/44
910500465901	DN145B LED10S/830 PSD-E II WH	IP20/44
910500465902	DN145B LED10S/840 PSD-E II WH	IP20/44
910505101195	DN145B LED10S/830 WIA-E WH	IP20/44
910505101196	DN145B LED10S/840 WIA-E WH	IP20/44
911401805980	DN145B LED10S/830 PSU II WH	IP20/44
911401806080	DN145B LED10S/840 PSU II WH	IP20/44
911401805780	DN145B LED6S/830 PSU II WH	IP20/44
911401805880	DN145B LED6S/840 PSU II WH	IP20/44

Initial Performance (IEC Compliant)

Order Code	Full Product Name	Initial chromaticity
911401806380	DN145C LED10S/830 PSU II WH	(0.43657,0.40454) SDCM<3
911401806480	DN145C LED10S/840 PSU II WH	(0.38212,0.38031) SDCM<3
911401806580	DN145C LED20S/830 PSU II WH	(0.43657,0.40454) SDCM<3
911401806680	DN145C LED20S/840 PSU II WH	(0.38212,0.38031) SDCM<3
910500465903	DN145B LED20S/830 PSD-E II WH	(0.43657,0.40454) SDCM<3
910500465904	DN145B LED20S/840 PSD-E II WH	(0.38212,0.38031) SDCM<3
910505101197	DN145B LED20S/830 WIA-E WH	(0.43657,0.40454) SDCM<3
910505101198	DN145B LED20S/840 WIA-E WH	(0.38212,0.38031) SDCM<3
911401806180	DN145B LED20S/830 PSU II WH	(0.43657,0.40454) SDCM<3

Order Code	Full Product Name	Initial chromaticity
911401806280	DN145B LED20S/840 PSU II WH	(0.38212,0.38031) SDCM<3
910500465901	DN145B LED10S/830 PSD-E II WH	(0.43657,0.40454) SDCM<3
910500465902	DN145B LED10S/840 PSD-E II WH	(0.38212,0.38031) SDCM<3
910505101195	DN145B LED10S/830 WIA-E WH	(0.43657,0.40454) SDCM<3
910505101196	DN145B LED10S/840 WIA-E WH	(0.38212,0.38031) SDCM<3
911401805980	DN145B LED10S/830 PSU II WH	(0.43657,0.40454) SDCM<3
911401806080	DN145B LED10S/840 PSU II WH	(0.38212,0.38031) SDCM<3
911401805780	DN145B LED6S/830 PSU II WH	(0.43657,0.40454) SDCM<3
911401805880	DN145B LED6S/840 PSU II WH	(0.38212,0.38031) SDCM<3

Over Time Performance (IEC Compliant)

Order Code	Full Product Name	Driver failure rate at 5000 h
911401806380	DN145C LED10S/830 PSU II WH	0.0015 %
911401806480	DN145C LED10S/840 PSU II WH	0.0015 %
911401806580	DN145C LED20S/830 PSU II WH	0.0015 %
911401806680	DN145C LED20S/840 PSU II WH	0.0015 %
910500465903	DN145B LED20S/830 PSD-E II WH	0.0015 %
910500465904	DN145B LED20S/840 PSD-E II WH	0.0015 %
910505101197	DN145B LED20S/830 WIA-E WH	-

Order Code	Full Product Name	Driver failure rate at 5000 h
910505101198	DN145B LED20S/840 WIA-E WH	-
911401806180	DN145B LED20S/830 PSU II WH	0.0015 %
911401806280	DN145B LED20S/840 PSU II WH	0.0015 %
910500465901	DN145B LED10S/830 PSD-E II WH	0.0015 %
910500465902	DN145B LED10S/840 PSD-E II WH	0.0015 %
910505101195	DN145B LED10S/830 WIA-E WH	-
910505101196	DN145B LED10S/840 WIA-E WH	-

CoreLine SlimDownlight

Order Code	Full Product Name	Driver failure rate at 5000 h
911401805980	DN145B LED10S/830 PSU II WH	0.0015 %
911401806080	DN145B LED10S/840 PSU II WH	0.0015 %

Order Code	Full Product Name	Driver failure rate at 5000 h
911401805780	DN145B LED6S/830 PSU II WH	-
911401805880	DN145B LED6S/840 PSU II WH	-

