



CoreLine Trunking Gen2 – Innovative LED light lines have never been so simple

CoreLine Trunking Gen2

CoreLine Trunking Gen2 is a light-line system that is designed for simplicity. It comes in a choice of lengths, flux packages and beam shapes to suit every project and application. Easy to use and integrate with spots and sensors, CoreLine Trunking Gen2 provides consistent, high-quality lighting with added protection against accidental water ingress. The innovative system is also easy to assemble and install for faster retrofits and refurbishments.

Benefits

- Optimized, efficient design and light effect
- Consistent, high-quality light - no Color over Angle or striping artefacts
- Improved light continuity
- Easy to order, assemble and install
- InterAct ready for enhanced use in Retail and Industry applications

Features

- Intuitive, single layer architecture – only 2 12NCs needed to create a line
- Choice of 3 lengths, each with 3 flux packages
- 8 different optics with consistent light quality
- Dedicated sensor units to upgrade to InterAct system propositions
- Lumen maintenance @ 50,000 hours - L80
- Available as trunking and standalone versions

CoreLine Trunking Gen2

Application

- Food and Large Retailers
- Warehouses
- Manufacturing

Dimensional drawing

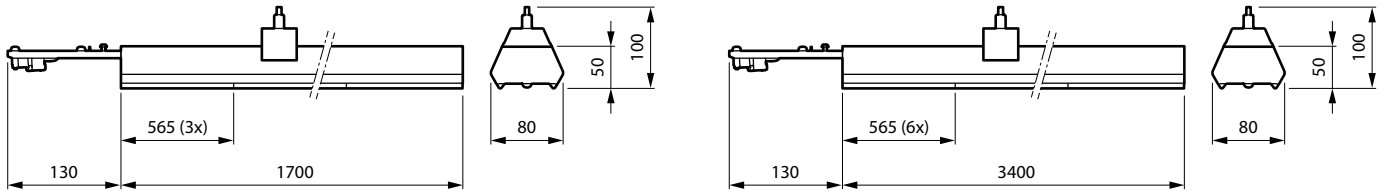

CoreLine Trunking Gen2

General Information

CE mark	Yes
Driver included	Yes
ENEC mark	ENEC plus mark
Flammability mark	-
Glow-wire test	Temperature 850 °C, duration 30 s
Light source replaceable	No
Service tag	Yes

Light Technical

Beam angle of light source	120 degree(s)
Correlated Color Temperature (Nom)	4000 K
Color rendering index (CRI)	>80
Luminous Efficacy (rated) (Nom)	157 lm/W
Optic type	Wide beam

Operating and Electrical

Input Voltage	220 to 240 V
Line Frequency	50 to 60 Hz

Temperature

Ambient temperature range	-20 to +35 °C
---------------------------	---------------

Controls and Dimming

Dimmable	No
----------	----

Mechanical and Housing

Housing Color	White RAL9016
---------------	---------------

Approval and Application

Protection class IEC	Safety class I
Mech. impact protection code	IK02
Ingress protection code	IP20

Initial Performance (IEC Compliant)

Initial chromaticity	(0.38, 0.38) SDCM <3
Luminous flux tolerance	+/-10%

Application Conditions

Maximum dim level	Not applicable
Suitable for random switching	Yes

General Information

Order Code	Full Product Name	Lamp family code	Number of gear units	Product family code
910925867537	LL217X 80S/840 1x PSU WB 5x1.5	80S	1 unit	LL217X
910925867558	LL234X 160S/840 2x PSU WB 5x1.5	160S	2 units	LL234X

Light Technical

Order Code	Full Product Name	Luminous Flux
910925867537	LL217X 80S/840 1x PSU WB 5x1.5	8,000 lm

Order Code	Full Product Name	Luminous Flux
910925867558	LL234X 160S/840 2x PSU WB 5x1.5	16,000 lm

Operating and Electrical

Order Code	Full Product Name	Power Consumption
910925867537	LL217X 80S/840 1x PSU WB 5x1.5	51 W

CoreLine Trunking Gen2

Order Code	Full Product Name	Power Consumption
910925867558	LL234X 160S/840 2x PSU WB 5x1.5	102 W

