

LIGHTOLIER

by  Signify

Downlighting

Uniframe CFL 6 3/4"

1101F 1 Light Non-IC Frame

 UNIFRAME

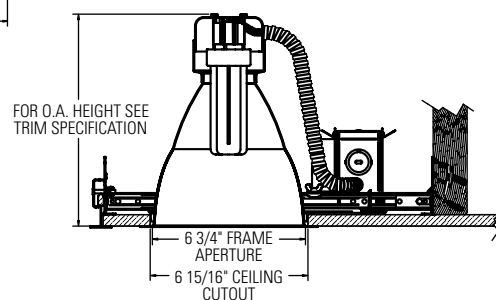
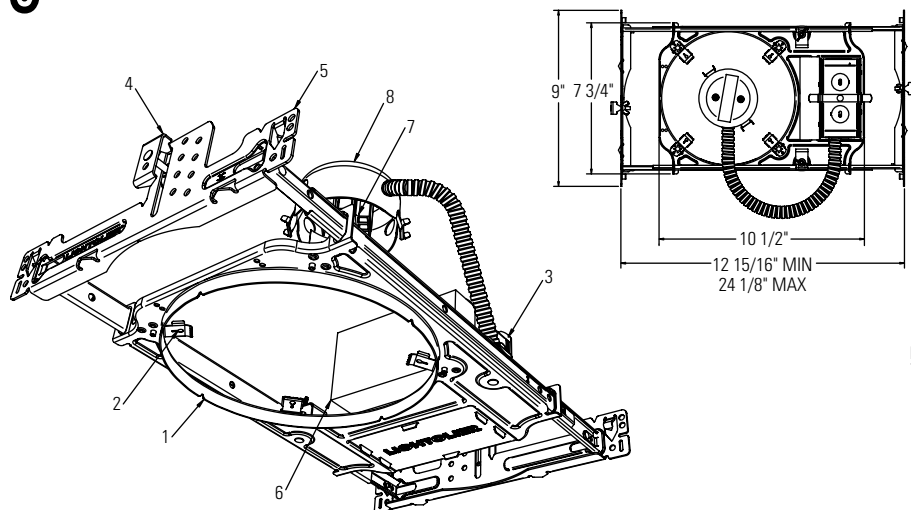

Project: _____
 Location: _____
 Cat.No: _____
 Type: _____
 Lamps: _____ Qty: _____
 Notes: _____

Complete Fixture consists of Frame-In Kit and Reflector Trim. Select each separately.

Uniframe Frame-In Kit	Uniframe Compact Fluorescent Performance Series Reflector Trims							
	Vertical Open	Vertical Wall Wash - Single	Vertical Wall Wash - Double	Horizontal Open	Horizontal Wall Wash - Single	Horizontal Wet Location Lensed / Diffused		
1101F18U 18w Quad/Triple, GX24q-2 Base 120v – 0.17amp max 277v – 0.08amp max	1101CL	1101CLSW	1101CLDW	1101HCL	1101HCLSW	Clear Lens	Fresnel	Opal Lens
	1101CD	1101CDSW	1101CDDW	1101HCD	1101HCDSW	1101HCLC	1101HCLF	1101HCLO
	1101WH	1101WHSW	1101WHDW	1101HWH	1101HWHSW	1101HCDC	1101HCDF	1101HCDO
						1101HWHC	1101HWHF	1101HWHO
Universal Series Reflector Trims (Reference Trim Spec Sheet for Recommended Lamping)								
1101F2642U 26w Quad/Triple, GX24q-3 Base 120v – 0.24amp max 277v – 0.11amp max 32w Triple, GX24q-3 Base 120v – 0.31amp max 277v – 0.13amp max 42w Triple, GX24q-4 Base 120v – 0.38amp max 277v – 0.17amp max	Performance Cone	Cone	Satin Cone	Baffle	Wall Wash	Wet Location	Cross Blade	
	1113CFL	1112*	1108*	1105*	1135	1121	1132	
	1113CDCFL	1113*	1110*	1105BNM	1135WH	1124		
		1113BK*		1105WH	1195	1134		
		1113WH		1176	1196	1177SH		
		1113CD*		1176WH	1196CD	1178SH		
		1145				1190		
		1143						
		1146 /						
		1146CD						
		1144 /						
		1144CD						

*Add NM suffix to catalog number for Natural Metal flange and finish.

1101F Uniframe CFL 6 3/4"

1 Light Non-IC Frame

Features

- 1. Mounting Frame:** .036" (#20ga.) Galvanized Steel.
Accommodates all ceilings up to 1-1/2" thick; including existing or inaccessible areas.
- 2. Trim Clips:** "Push In / Twist Out" Stainless Steel clips hold reflector flush to ceiling.
- 3. Junction Box:** 2" x 4" x 3-1/2" (22cu.in.) .032" (#22ga.) galvanized steel. UL Listed for maximum of 8 (#12ga.) through branch circuit conductors.
- 4. Uniframe Mounting System – Grid Ceiling:** Tool free mounting in grid ceilings. .036" (20ga.) Galvanized Steel interlocking slide bars adjust to 24-1/8" long accommodating 24" O.C. Ceiling Grid. Adjustable speed clamps for positive attachment to grid ceiling systems.
- 5. Uniframe Mounting System – Wood Joist Ceiling:** Integral nailing tabs, alignment guides, fastener holes and bendable strapping guides for wood joist installation. Galvanized Steel interlocking slide bars adjust from 12-15/16" to 24-1/8" long to accommodate 16" and 24" O.C. joist spacing, with or without strapping. Suitable for Steel Ceiling construction using standard 1/2" EMT, (See Instruction Sheet).
- 6. Ballast:** 120V – 277V UL Listed Electronic Ballast, end of lamp life protection, class "P" thermally protected, class "A" sound rating. Minimum starting temperature is 0°F.
- 7. Socket:** Four-pin base, molded thermoplastic socket, prewired with No. 18 AWM leads to ballast.
- 8. Socket Housing:** .036" (#20ga.) Galvanized Steel housing attaches to reflector trim by spring clip for precise optic alignment.

Labels

cULus Listed. Suitable for Damp Locations.

Accessories

I967A Extra Thick Ceiling Adapter (2" thk)

